

LAND CORNER MONUMENT RECORD

R. 9 E.

LOCATION

LC \_\_\_\_\_

	6	5	4	3	2	1
	7	8	9	10	11	12
T.	18	17	16	15	14	13
4	19	20	21	22	23	24
N	30	29	28	27	26	25
	31	32	33	34	35	36

20	21	22
29	28	27
32	33	34

TOWNSHIP 4 N

RANGE 9 E

SECTION 28

TYPE OF MONUMENT; TIES TO BEARING TREES, OBJECTS, etc. (SKETCH)

FOUND 3.5" BRASS CAP  
IN CONCRETE  
  
ALL BEARING TREES  
WERE PAINTED AND SIGNED  
  
A NAIL AND WASHER WITH  
"LS 36619" WERE PLACED IN  
THE SIDE-CENTER OF NEW BT

CAP DESCRIPTION:

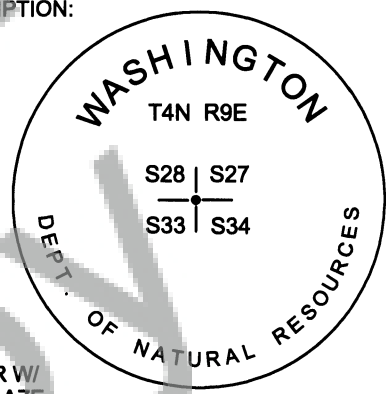
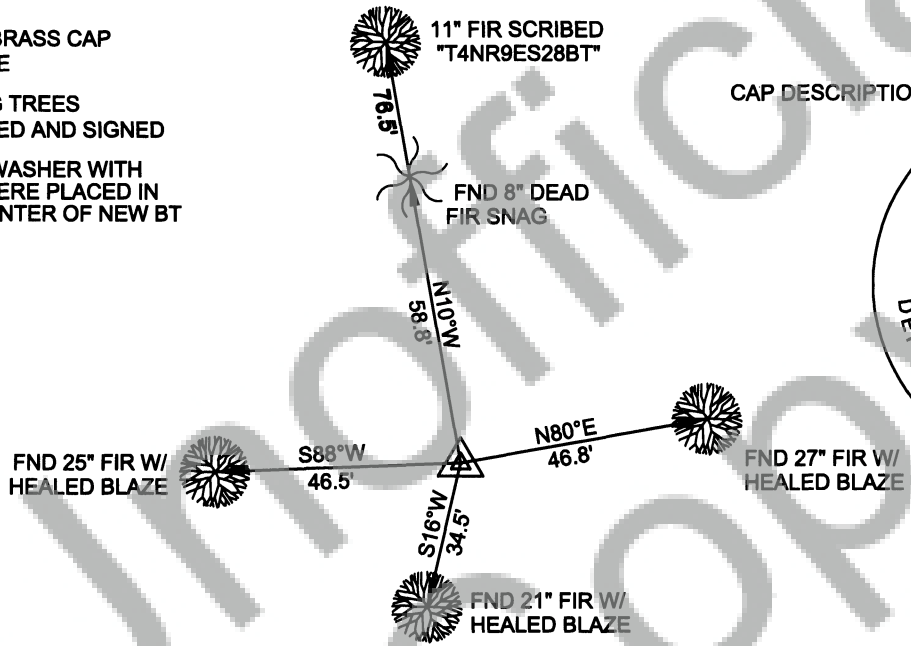

GROUND DISTANCES  
NO SCALE

REMARKS: ( History of Corner, etc. )

CORNER HISTORY:

- 1879- EDWIN RICHARDSON ESTABLISHED CORNER UNDER GLO CONTRACT
- 1940- CORNER FOUND BY D. STEVENSON
- 1970- WASHINGTON STATE DNR MONUMENT CORNER AND MARK NEW REFERENCES
- 1983- TERRA SURVEYING MAINTAINED CORNER REFERENCES

DIRECTIONS:

From Willard, follow Forest Road 66 northwesterly approx. 2 miles, +/- 0.2 mi past junction  
with Forest Road 68, to corner on south edge of road.

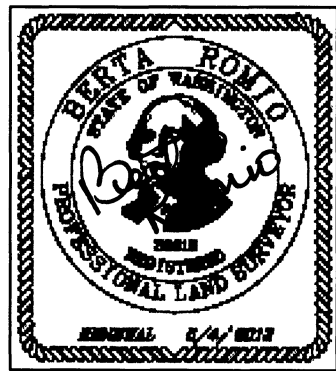

NAME BERTA ROMIO, RLS 36619  
DATE 10/25/2012  
SIGNATURE Berta Romio