

LAND CORNER MONUMENT RECORD

R.10 E. LOCATION LC _____

	6	5	4	3	2	1
	7	8	9	10	11	12
T.	18	17	16	15	14	13
5	19	20	21	22	23	24
N	30	29	28	27	26	25
	31	32	33	34	35	36

36	31	32
1	6	5
12	7	8

TOWNSHIP 4 N RANGE 10 E SECTION 28

TYPE OF MONUMENT; TIES TO BEARING TREES, OBJECTS, etc. (SKETCH)

FOUND 5/8" IRON ROD
W/ YELLOW PLASTIC CAP
PROTRUDING 6" ABOVE GROUND
SET USFS MONUMENT, 3.5" ALUMINUM CAP
ON 2" ALUMINUM PIPE, MARKED AS SHOWN
OVER FOUND MONUMENT

CAP DESCRIPTION:

ALL BEARING TREES
WERE PAINTED AND SIGNED

A NAIL AND WASHER WITH
"LS 36619" WERE PLACED IN
THE SIDE-CENTER OF SCRIBED BT'S

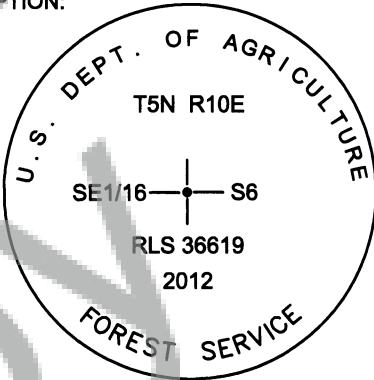
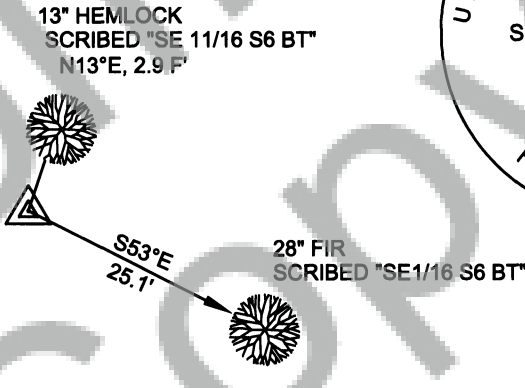

GROUND DISTANCES
NO SCALE

REMARKS: (History of Corner, etc.)

CORNER HISTORY:

JULY 2005- BELL DESIGN SURVEYED PRIVATE LANDS IN THE EAST HALF OF SECTION 6

DIRECTIONS:

From the Mt. Adams Ranger Station, follow SR141 to Forest Road 86. Go south on 86
1.1 mi . to Forest Rd. 8629. Follow 8629 approx. 1.2 mi to posted line. Corner lies 25 ft. north
of road. National Forest boundary posted south from corner.



NAME BERTA ROMIO, RLS 36619
DATE 10/25/2012
SIGNATURE Berta Romio