

LAND CORNER MONUMENT RECORD

R. 10 E. LOCATION LC _____

	6	5	4	3	2	1
	7	8	9	10	11	12
T.	18	17	16	15	14	13
5	19	20	21	22	23	24
N	30	29	28	27	26	25
	31	32	33	34	35	36

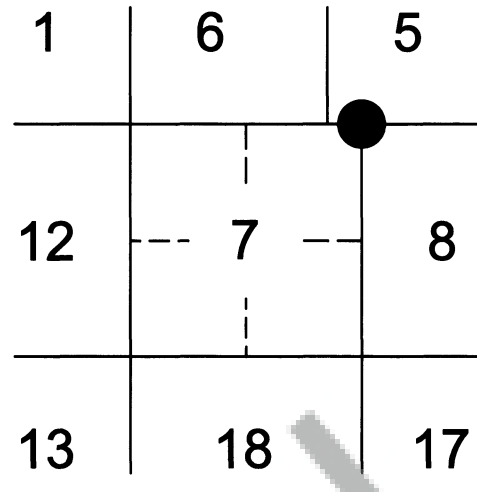

TOWNSHIP 5 N RANGE 10 E SECTION 7

TYPE OF MONUMENT; TIES TO BEARING TREES, OBJECTS, etc. (SKETCH)

FOUND GENERAL LAND OFFICE BRASS CAP
ON 1" IRON PIPE
PROTRUDING 1" IN MOUND OF STONE

ALL BEARING TREES
WERE PAINTED AND SIGNED
A NAIL AND WASHER WITH
"LS 36619" WERE PLACED IN
THE SIDE-CENTER OF NEW BT'S

FND 17" FIR W/
HEALED BLAZE

CAP DESCRIPTION:

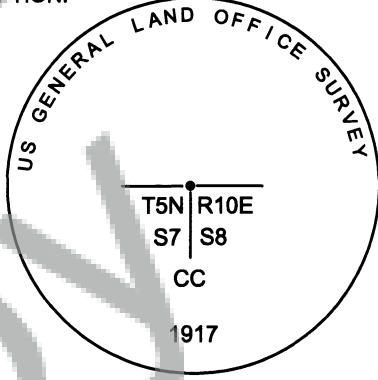
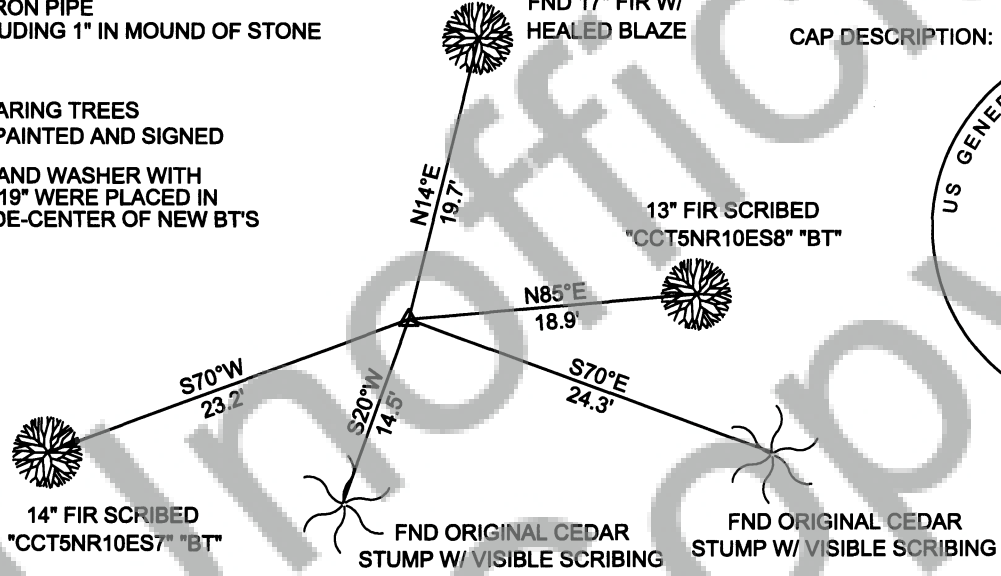

GROUND DISTANCES
NO SCALE

REMARKS: (History of Corner, etc.)

CORNER HISTORY:

1917- G.L.O. ORIGINAL SURVEY BY ROY T. CAMPBELL

1991- LANDS OWNED BY THE FOREST SERVICE WERE POSTED AND MONUMENTED.

DIRECTIONS:

From the Mt. Adams Ranger Station, follow SR141 3.4 mi. to Forest Road 86. Go south on 86 1.1 mi to Forest Rd. 8620. Follow 8620 for approx. 1.4 mi. to 8620-011. Follow 8620-011 southerly approx. 0.2 mi to to location tag on east side of road. Walk east +/-200' to posted line at E1/16. Follow posted line east approx. 1650 ft. to corner. National Forest boundary is posted west and south

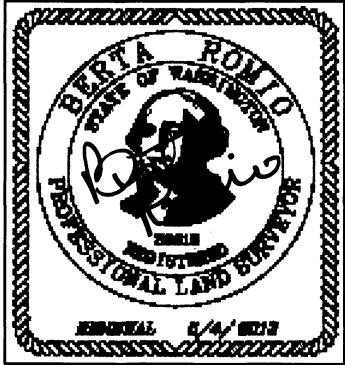

NAME BERTA ROMIO, RLS 36619
DATE 10/25/2012
SIGNATURE Berta Romio