

TERRA SURVEYING

RECORD OF SURVEY

LOCATED IN THE NORTHEAST QUARTER OF THE SOUTHEAST QUARTER OF SECTION 27  
AND NORTHWEST QUARTER OF THE NORTHWEST QUARTER OF THE SOUTHWEST QUARTER  
OF SECTION 26 ALL IN TOWNSHIP 4 NORTH, RANGE 7 EAST, WILLAMETTE MERIDIAN,  
SKAMANIA COUNTY, WASHINGTON.

5/8" IRON  
ROD FOUND,  
LS 29288

FOUND BRASS CAP  
MONUMENTING THE 1/4  
CORNER SECTION 27/26

N 89°41'43" W  
1008.21'  
(1008.21')

SET BRASS SCREW AND WASHER  
LS 43141 ON A LARGE STONE TO  
REFERENCE THE CORNER THAT  
FELL IN CENTERLINE OF CREEK.

TAX LOT 1500  
CONTAINS 2.3 ACRES ±

SET MONUMENT ON TO  
REFERENCE THE CORNER  
THAT FELL IN CREEK.

PROPERTY BOUNDARY SURVEY  
for  
NATALIE ARNDT

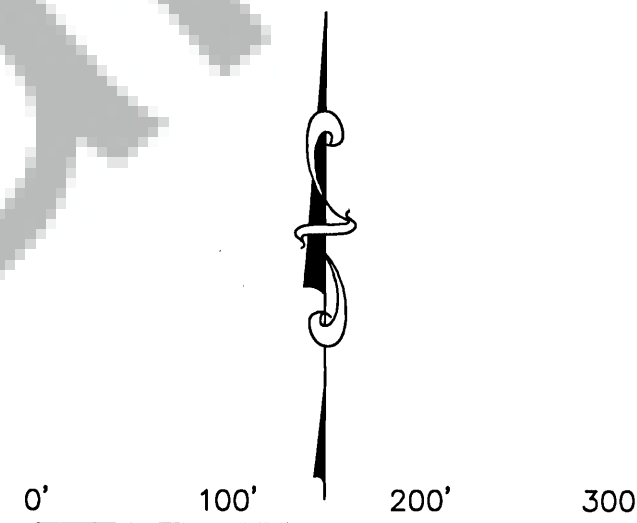

SCALE: 1" = 100'

BASIS OF BEARING:

SKAMANIA COUNTY SURVEY BOOK 3, PAGE 153

TAX LOT 1600

TAX LOT 600  
CONTAINS 5.09 ACRES ±

5/8" IRON  
ROD FOUND,  
LS 29288

BASIS OF BEARING  
N 00°49'48" W  
1319.60'

5/8" IRON  
ROD FOUND,  
"TRANTOW"

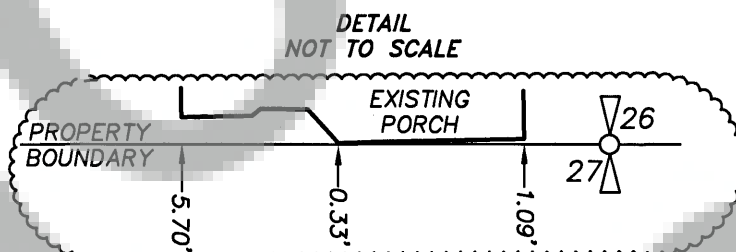

TAX LOT 1700  
CONTAINS 7.7 ACRES ±

SURVEYOR'S CERTIFICATE

THIS MAP CORRECTLY REPRESENTS A SURVEY MADE BY ME OR UNDER MY  
DIRECTION IN CONFORMANCE WITH THE REQUIREMENTS OF THE SURVEY  
RECORDING ACT AT THE REQUEST OF NATALIE ARNDT  
IN OCTOBER 2012.

*Erik M. Carlson*  
ERIK M. CARLSON, PROFESSIONAL LAND SURVEYOR, L.S. #43141

AUDITOR'S CERTIFICATE

FILED FOR RECORD THIS 17<sup>th</sup> DAY OF October, 2012  
AT 8:34 A.M. IN BOOK \_\_\_\_\_ ON PAGE \_\_\_\_\_  
AT THE REQUEST OF ERIK M. CARLSON.

2012181780  
AUDITOR'S FILE NUMBER

*Melina Anderson*  
COUNTY AUDITOR, Deputy

NARRATIVE:

THE PURPOSE OF THIS SURVEY IS TO DELINEATE THE BOUNDARIES OF TAX LOTS 1700, 1500 AND 600. WE POSTED BETWEEN BOUNDARY CORNERS WITH 4 FOOT WOODEN STAKES AND PINK RIBBON. THE BOUNDARY WAS RESOLVED BY TIEING INTO THE SECTION LINE BETWEEN SECTION 26 AND 27, WHICH WAS MONUMENTED ON BOTH ENDS WITH A BRASS CAP. I USED THIS LINE FOR THE BASIS OF BEARING FOR THE SURVEY WORK. TAX LOTS 1700 AND 1500 WERE DESCRIBED BASED ON THE SECTION BREAKDOWN OF THE NORTHEAST QUARTER OF THE SOUTHEAST QUARTER OF SECTION 27. I ACCOMPLISHED THIS BREAKDOWN BY UTILIZING FIELD TIES TO COUNTY SURVEY BOOK 3, PAGE 153. THE DISTANCES BETWEEN MONUMENTS MATCHED VERY CLOSE AND WERE ACCEPTED. TAX LOT 600 WAS DESCRIBED AS THE WEST HALF OF THE NORTHWEST QUARTER OF THE NORTHWEST QUARTER OF THE SOUTHWEST QUARTER OF SECTION 26. I WAS ABLE TO CALCULATE SAID WEST HALF BASED ON RECOVERED MONUMENTS SET ON A SURVEY COMPLETED BY OLSON IN 1980. WHEN I COMPARED RECORD MEASUREMENTS THE DISTANCES MATCHED CLOSELY BETWEEN WHAT I MEASURED AS WELL AS OTHER SURVEYS IN THE AREA. WITH THIS METHOD WE WERE ABLE TO TIE INTO A FOUND IRON ROD AT THE NORTHEAST CORNER OF SAID WEST HALF WITHIN 0.04 OF A FOOT. ALONG THE NORTH LINE OF THE SUBJECT PROPERTY IT WAS DISCOVERED THE ADJOINERS TO THE NORTH HAVE BUILT A DECK TO AN EXISTING HOME VERY CLOSELY TO THE PROPERTY BOUNDARY. I HAVE SHOWN A DETAIL WITH MEASUREMENTS.

THE NORTHWEST CORNER OF TAX LOT 1500  
FELL IN THE CENTERLINE OF TROUT CREEK, AT  
THIS POINT I SET A REFERENCE MONUMENT AS  
SHOWN.

REFERENCES:

SKAMANIA COUNTY SURVEY BOOK 1, PAGE 223  
SKAMANIA COUNTY SURVEY BOOK 1, PAGE 251  
SKAMANIA COUNTY SURVEY BOOK 2, PAGE 44  
SKAMANIA COUNTY SURVEY BOOK 3, PAGE 153  
SKAMANIA COUNTY SURVEY BOOK 3, PAGE 260  
SKAMANIA COUNTY SURVEY BOOK 3, PAGE 338



TERRA SURVEYING

DATE MONUMENTED: OCTOBER 4, 2012

SCALE: 1" = 100'

PROJECT: 12058

ASSESSORS MAP: 4-7-27 TL 1700 & 1500  
4-7-26-3 TL 600

P.O. BOX 617  
HOOD RIVER, OREGON 97031  
PHONE & FAX: (541) 386-4531  
E-Mail: terra@gorge.net  
www.terrandsurveying.com

FOUND 1/2" IRON ROD, LS 9025

FOUND 1/2" IRON ROD, LS 9025

ACCURACY STATEMENT

TOPCON GPT 3005W WITH A 5 SECOND HORIZONTAL  
ACCURACY. LAST INSPECTED IN JUNE, 2012, BY  
PORTLAND PRECISION INSTRUMENT CO. TRAVERSE CLOSURES  
CONTAINED A MAXIMUM 4" ANGULAR ADJUSTMENT  
AND A MAXIMUM COMPASS ADJUSTED ERROR OF CLOSURE  
OF 1 : 5000.

LEGEND:

- SET 5/8" X 30" IRON ROD WITH CAP L.S. 43141, UNLESS NOTED OTHERWISE.
- FOUND MONUMENT OF RECORD
- CALCULATED, NOT FOUND OR SET
- ( ) DEED OR PLAT CALL

FOUND 2-1/2" BRASS  
CAP MONUMENTING THE  
SOUTH 1/16 CORNER  
SECTION 26/27