

AFTER RECORDING MAIL TO:

Name GARY R. HEGEWALD
PR ESTATE OF HELEN HEGEWALD
Address P.O. Box 1039

REAL ESTATE EXCISE TAX
29142

City, State, Zip STEVENSON, WA 98648

JUL 20 2011
PAID \$58.55
Vicki Chellens, Deputy
SKAMANIA COUNTY TREASURER

Filed for Record at Request of:

QUIT CLAIM DEED

THE GRANTOR(S) GARY R. HEGEWALD (PR ESTATE OF HELEN HEGEWALD)
for and in consideration of \$3,500.00
conveys and quit claims to COLUMBIA CASCADE HOUSING CORPORATION
the following described real estate, situated in the County of SKAMANIA, state of Washington,
together with all after acquired title of the grantor(s) therein:

~~A PORTION OF~~

SEE ATTACHED

Assessor's Property Tax Parcel/Account Number: A PORTION OF 02-07-02-1-0-0102
02-07-02-1-1-1000
Dated: JULY 19, 2011

Gary R. Hegewald Pers. Rep.
ESTATE OF HELEN HEGEWALD

STATE OF Washington
COUNTY OF SKAMANIA

I certify that I know or have satisfactory evidence that Gary R Hegewald
(is/are) the person(s) who appeared before me, and said person(s) acknowledged that (he/she/they) signed this instrument and
acknowledged it to be (his/her/their) free and voluntary act for the uses and purposes mentioned in this instrument.

Dated: 7-19-11

Leslie L Moore
Notary Public in and for the state of Washington
My appointment expires: 1-9-2012

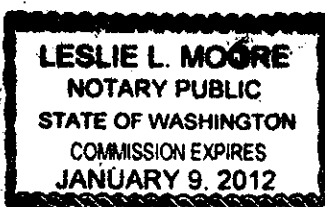

LPB-12(i) 7/97

June 27, 2011

COLUMBIA CASCADE HOUSING

EXHIBIT "A"

A tract of land lying in the Felix Iman DLC in the Northeast 1/4 of Section 2, Township 2 North, Range 7 East, Willamette Meridian, City of Stevenson, Skamania County, Washington, being more particularly described as follows.

Beginning at the Southwest corner of the Northeast 1/4 of the Northeast 1/4 of said Section 2; thence North a distance of 295 feet, more or less, to the Southwest corner of that tract of land conveyed to Lucy D. Harris, et vir., to L.T. Coffman by deed recorded at Page 449 of Book "U" of Deeds, Records of Skamania County, Washington; thence East a distance of 209 feet; thence South a distance a 295 feet to the South line of said Northeast 1/4 of the Northeast 1/4; thence West along said South line 209 feet to the point of beginning.

Excepting there from all that portion lying South of the Northerly right-of-way line of Ryan-Allen Road.

Also the following described tract of land.

Commencing at the intersection of the North line of the Baughman DLC and the West line of said Northeast 1/4 of the Northeast 1/4; thence along said West line, North $00^{\circ}15'22''$ West 149.67 feet to the intersection with said Northerly right-of-way line of Ryan-Allen Road and true point of beginning of this description; thence continuing along said West line, North $00^{\circ}15'22''$ West 145.33 feet to the Southeast corner of that tract of land described in Auditor's File #121472, Records of Skamania County; thence leaving said West line, along the Southerly line of said tract of land, North $74^{\circ}45'28''$ West 81.54 feet to the intersection with said Northerly right-of-way line; thence along said Northerly right-of-way line, on a 317.62 foot radius curve to the right, a radial line to which bears South $66^{\circ}19'45''$ West, through a central angle of $12^{\circ}18'32''$ a distance of 68.23 feet (the long chord of which bears South $17^{\circ}30'59''$ East 68.10 feet); thence South $11^{\circ}21'43''$ East 19.80 feet; thence on a 145.00 foot radius curve to the left, a radial line to which bears North $78^{\circ}38'17''$ East, through a central angle of $32^{\circ}07'57''$ a distance of 81.32 feet (the long chord of which bears South $27^{\circ}25'42''$ East 80.26 feet); thence on a 145.00 foot radius curve to the left, a radial line to which bears North $36^{\circ}03'52''$ East, through a central angle of $08^{\circ}21'46''$ a distance of 21.16 feet (the long chord of which bears South $58^{\circ}07'01''$ East 21.15 feet) to the true point of beginning of this description.

Contains 0.855 acre.

Skamania County Assessor
Date 7/19/11 Parcel# 02070211000
PTN & G.S.
02070210010200



June 27, 2011

HEGEWALD
TO
COLUMBIA CASCADE HOUSING CORP.

LEGAL DESCRIPTION
for
Adjustment Area

A tract of land being a portion of that property described in Auditor's File #2010-177010, in the Felix Iman DLC, in the West 1/2 of the Northeast 1/4 of Section 2, Township 2 North, Range 7 East, Willamette Meridian, City of Stevenson, Skamania County, Washington, being more particularly described as follows.

\Commencing at the intersection of the North line of the Baughman DLC and the East line of said West 1/2; thence along said East line, North $00^{\circ}15'22''$ West 149.67 feet to the intersection with the Northerly right-of-way line of Ryan-Allen Road and true point of beginning of this description; thence continuing along said East line, North $00^{\circ}15'22''$ West 145.33 feet to the Southeast corner of that tract of land described in Auditor's File #121472, Records of Skamania County; thence leaving said East line, along the Southerly line of said tract of land, North $74^{\circ}45'28''$ West 81.54 feet to the intersection with said Northerly right-of-way line; thence along said Northerly right-of-way line, on a 317.62 foot radius curve to the right, a radial line to which bears South $66^{\circ}19'45''$ West, through a central angle of $12^{\circ}18'32''$ a distance of 68.23 feet (the long chord of which bears South $17^{\circ}30'59''$ East 68.10 feet); thence South $11^{\circ}21'43''$ East 19.80 feet; thence on a 145.00 foot radius curve to the left, a radial line to which bears North $78^{\circ}38'17''$ East, through a central angle of $32^{\circ}07'57''$ a distance of 81.32 feet (the long chord of which bears South $27^{\circ}25'42''$ East 80.26 feet); thence on a 145.00 foot radius curve to the left, a radial line to which bears North $36^{\circ}03'52''$ East, through a central angle of $08^{\circ}21'46''$ a distance of 21.16 feet (the long chord of which bears South $58^{\circ}07'01''$ East 21.15 feet) to the true point of beginning of this description.

Contains 0.175 acre.

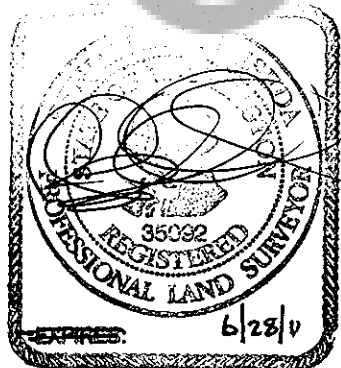

13704_DESC.001sa



June 28, 2011

HEGEWALD

EXHIBIT "A"

A tract of land in Section 2, Township 2 North, Range 7 East, of the Willamette Meridian, in the County of Skamania, State of Washington, described as follows:

Beginning at the Northeast Corner of the Northwest Quarter of the Northeast Quarter of Section 2, Township 2 North, Range 7 East, Willamette Meridian; Thence West along the North line of said Section 2 a distance of 1055 feet, more or less, to the Easterly right-of-way line of the County road known as Red Bluff road (now Ryan Allen road); Thence Southeasterly along said right-of-way line to its intersection with the East line of the Northwest Quarter of the Northeast Quarter of said Section 2; Thence North along said Quarter line, a distance of 1400 feet, more or less, to the Point of Beginning.

Excepting there from the following:

Beginning at the Northeast corner of the Northwest Quarter of the Northeast Quarter of Section 2, Township 2 North, Range 7 East of the Willamette Meridian, in the County of Skamania, State of Washington; Thence South 00°15'22" East along the East line of the Northwest Quarter of the Northeast Quarter of said Section 2, a distance of 680.00 feet; Thence South 89°31'33" West, a distance of 590.00 feet; Thence North 00°15'22" West, a distance of 680.00 feet; Thence North 89°31'33" East, a distance of 590.00 feet to the Point of Beginning.

Also Excepting there from the following:

A parcel of land in the Felix Iman DLC in the West Half of the Northeast Quarter of Section 2, Township 2 North, Range 7 East, Willamette Meridian, described as follows:

Commencing at the intersection of the North line of the Baughman DLC and the East line of said West Half; Thence North 00°40'57" East along the East line thereof 295.00 feet, to the True Point of Beginning; Thence North 73°52'27" West 83.95 feet to an existing rebar; Thence North 4°31'17" West 209.00 feet to an existing iron pipe; Thence North 86°20'55" East 100.16 feet to the East line of said West Half; Thence South 0°40'57" West 238.06 feet along said East line to the True Point of Beginning, which is also described in Deed recorded in Book 147, Page 928, Skamania County records.

Also Excepting there from:

Commencing at the intersection of the North line of the Baughman DLC and the East line of said West 1/2; thence along said East line, North 00°15'22" West 149.67 feet to the intersection with the Northerly right-of-way line of Ryan-Allen Road and true point of

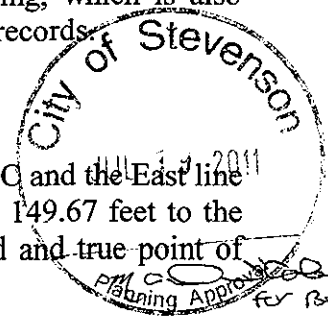

beginning of this description; thence continuing along said East line, North $00^{\circ}15'22''$ West 145.33 feet to the Southeast corner of that tract of land described in Auditor's File #121472, Records of Skamania County; thence leaving said East line, along the Southerly line of said tract of land, North $74^{\circ}45'28''$ West 81.54 feet to the intersection with said Northerly right-of-way line; thence along said Northerly right-of-way line, on a 317.62 foot radius curve to the right, a radial line to which bears South $66^{\circ}19'45''$ West, through a central angle of $12^{\circ}18'32''$ a distance of 68.23 feet (the long chord of which bears South $17^{\circ}30'59''$ East 68.10 feet); thence South $11^{\circ}21'43''$ East 19.80 feet; thence on a 145.00 foot radius curve to the left, a radial line to which bears North $78^{\circ}38'17''$ East, through a central angle of $32^{\circ}07'57''$ a distance of 81.32 feet (the long chord of which bears South $27^{\circ}25'42''$ East 80.26 feet); thence on a 145.00 foot radius curve to the left, a radial line to which bears North $36^{\circ}03'52''$ East, through a central angle of $08^{\circ}21'46''$ a distance of 21.16 feet (the long chord of which bears South $58^{\circ}07'01''$ East 21.15 feet) to the true point of beginning of this description.

Contains 9.965 acres.

<13704_DESC.003sa>

