

NOTE: Hagedorn, Inc. makes no warranties as to matters of unwritten

SURVEY
in the SW 1/4 NW 1/4
and SE 1/4 NW 1/4
and the SW 1/4 NE 1/4
SECTION 2, T1N, R5E, W1M.
SKAMANIA COUNTY, WA.

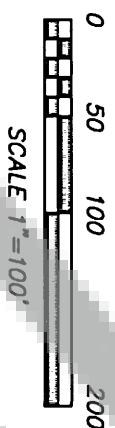
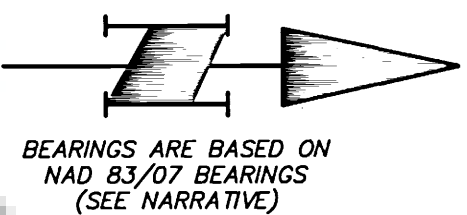

LEGEND

- MONUMENT AS FOUND (TIED NOVEMBER-DECEMBER 2010). SEE PAGES 3 & 4 FOR DESCRIPTION
- ⊙ SET "DEEP-ONE" MAGNET BENEATH 2-1/4" ALUMINUM PIPE WITH 3-1/4" USFS EMBOSSED ALUMINUM CAP AS SHOWN ON PAGES 3 & 4
- NFSL = NATIONAL FOREST SYSTEM LANDS
- ⑦ MONUMENT I.D. NUMBER (SEE PAGES 3 & 4 FOR CORNER INFORMATION)
- I.R. = IRON ROD
- R.O.S. = RECORD OF SURVEY
- SP = SHORT PLAT
- YPC = YELLOW PLASTIC CAP

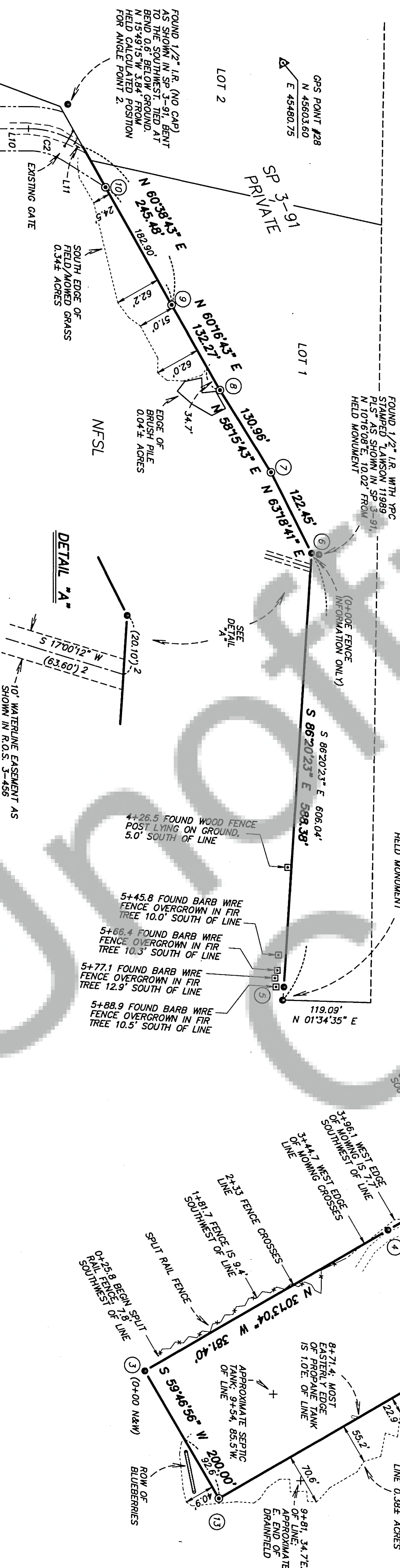

LINE TABLE			
LINE	BEARING	LENGTH	
L9	N 15°00'00\"	100.00	
L10	N 00°00'00\"	45.00	
L11	N 32°00'00\"	12.23	

CURVE TABLE			
CURVE	DELTA	RADIUS	LENGTH
C1	15°00'00\"	700.00	183.26
C2	32°00'00\"	120.00	67.02



HAGEDORN, INC.
Surveying and Engineering
1924 Broadway Vancouver, Wa. 98663
Ph: (360) 696-4428

SCALE: 1\"/>
DATE: 5/19/11
JOB NO.: 10-123
CALC. BY: GAB
DRAWN BY: CC
CHECKED BY: BPT
DWG# SURVEY-PAGE-2
PAGE 2 OF 4

SURVEY
in the SW 1/4 NW 1/4
and SE 1/4 NW 1/4
and the SW 1/4 NE 1/4 of
SECTION 2, T1N, R5E, W.M.
SKAMANIA COUNTY, WA.

NOTE

BEARINGS SHOWN FOR BEARING TREES AND REFERENCE POINTS ARE BASED ON A DECLINATION OF 17° E, SET ON OUR HAND HELD COMPASSES (UNLESS NOTED TO THE NEAREST SECOND). DISTANCES REPORTED ARE TO CENTER OF THE TREE, ONE FOOT ABOVE THE GROUND (UNLESS NOTED OTHERWISE). NEW BTS HAVE A PAINTED 6" RED BAND AT DBH, HAVE A 54-3 SIGN NAILED FACING CORNER AND HAVE A 54-4 OR 54-9 SIGN NAILED ON THE BACK. THEY ALSO HAVE A BRASS WASHER (LS 42425) TACKED IN THE NEWLY SCRIBED 79°.

LEGEND

- BT = BEARING TREE
- SP = SHORT PLAT
- GLO = GENERAL LAND OFFICE
- USFS = UNITED STATES FOREST SERVICE
- OPC = ORANGE PLASTIC CAP
- YPC = YELLOW PLASTIC CAP
- DBH = DIAMETER BREAST HEIGHT
- DNR = DEPARTMENT OF NATURAL RESOURCES
- R.O.S. = RECORD OF SURVEY
- 54-3 = A 4 1/2" x 5" METAL "BEARING TREE" SIGN
- 54-4 = A 7" x 5" METAL "ATTENTION" SIGN
- 54-8 = A 4 1/2" x 5" METAL "LOCATION POSTER" SIGN
- 54-9 = A 7" x 5" METAL "LAND SURVEY MONUMENT" SIGN OR A 2 1/2" x 1 1/2" STICKER (DECAL) ON A 6 FOOT FIBERGLASS POST

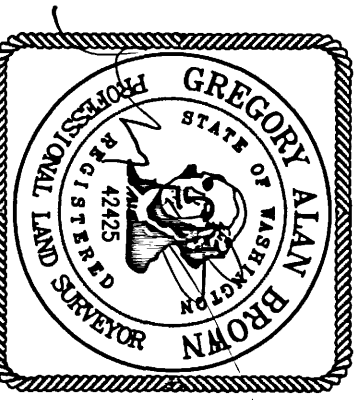

6/24/2011

HAGEDORN, INC.
Surveying and Engineering
1924 Broadway Vancouver, Wa. 98663
Ph: (360) 696-4428

SCALE: NA
DATE: 5/19/11
JOB NO.: 10-123
CALC. BY: GAB
DRAWN BY: CC
CHECKED BY: BPT
DWG# SURVEY-PAGE-3-4
PAGE 3 OF 4

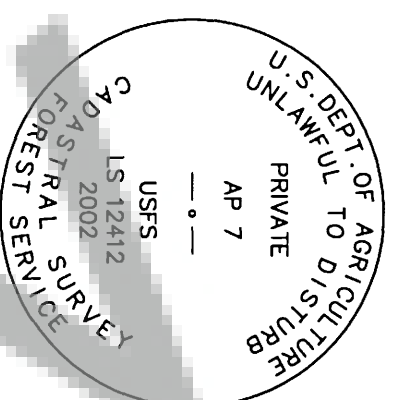

5

FOUND 3 1/4" USFS EMBOSSED ALUMINUM CAP AS SET IN ROS 3-456 STAMPED AS SHOWN:
FOUND 1908 DEED (BK. 1, PG. 14) BEARING TREE: 36" FIR SWAG, N 90E, 116.8'
FOUND 1908 DEED (BK. 1, PG. 14) BEARING TREE: 36" FIR STUMP, N 89W, 75.9'
FOUND REFERENCE POINT: 5/8" IRON ROD, S 34° 01' 03"E, 13.98' WITH YPC STAMPED "HAGEDORN INC." APPROXIMATELY ONE FOOT IN FRONT OF A 10" FIR TREE WITH 54-3 & 54-4 SIGNS & PAINTED RED BAND
FOUND REFERENCE POINT: 5/8" IRON ROD, S 65° 17' 44"W, 7.97' WITH YPC STAMPED "HAGEDORN INC." APPROXIMATELY ONE FOOT IN FRONT OF A 14" FIR TREE WITH 54-3 & 54-4 SIGNS & PAINTED RED BAND
FOUND 6" FIBERGLASS POST WITH A USFS 54-9 (DECAL) STICKER ATTACHED 2' NORTH FROM FOUND MONUMENT.
SET 6" FIBERGLASS POST WITH A USFS 54-9 (DECAL) STICKER ATTACHED N 86W, 3' ON PROPERTY LINE FROM FOUND MONUMENT.

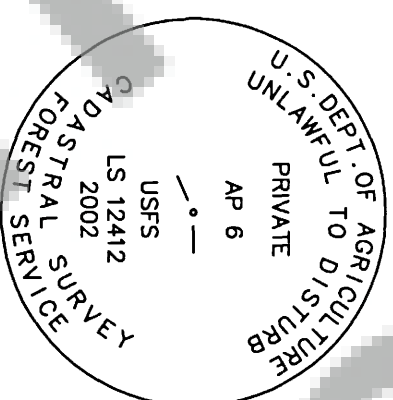

6

FOUND 3 1/4" USFS EMBOSSED ALUMINUM CAP AS SET IN ROS 3-456 STAMPED AS SHOWN:
FOUND REFERENCE POINT: 5/8" IRON ROD S 01° 52' 22"E, 14.80' WITH YPC STAMPED "HAGEDORN INC." APPROXIMATELY ONE FOOT IN FRONT OF 1908 BEARING TREE WHICH IS A 36" FIR STUMP WITH HEALED BLAZE & 54-8 SIGN
FOUND REFERENCE POINT: 5/8" IRON ROD, S 82° 51' 53"W, 35.83' WITH YPC STAMPED "HAGEDORN INC." APPROXIMATELY ONE FOOT IN FRONT OF 1908 BEARING TREE WHICH IS A 40" FIR STUMP WITH OPEN FACE AND PARTIAL VISIBLE SCRIBING (UNREADABLE) & 54-8 SIGN
FOUND 6" FIBERGLASS POST WITH A USFS 54-9 (DECAL) STICKER ATTACHED S 42E, 2.0' FROM FOUND MONUMENT.
SET 6" FIBERGLASS POST WITH A USFS 54-9 (DECAL) STICKER ATTACHED S 63W, 3' AND S 86E, 3' ON PROPERTY LINE FROM FOUND MONUMENT.

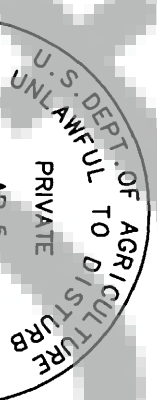

7

SET 2 1/4" ALUMINUM PIPE WITH 3 1/4" USFS EMBOSSED ALUMINUM CAP IN ROCK MOUND STAMPED AS SHOWN:
NEW REFERENCE POINT: FOUND 2 1/4" ALUMINUM PIPE WITH 3 1/4" USFS EMBOSSED ALUMINUM CAP N 63° 18' 41"E, 122.45'
NEW REFERENCE POINT: SET 2 1/4" ALUMINUM PIPE WITH 3 1/4" USFS EMBOSSED ALUMINUM CAP S 58° 15' 43"W, 130.96'
SET 6" FIBERGLASS POST WITH A USFS 54-9 (DECAL) STICKER ATTACHED N 63E, 3' AND S 58W, 3' ON PROPERTY LINE FROM SET MONUMENT.

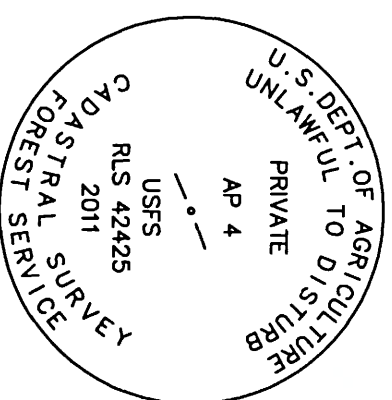

8

SET 2 1/4" ALUMINUM PIPE WITH 3 1/4" USFS EMBOSSED ALUMINUM CAP STAMPED AS SHOWN:
NEW REFERENCE POINT: SET 2 1/4" ALUMINUM PIPE WITH 3 1/4" USFS EMBOSSED ALUMINUM CAP N 58° 15' 43"E, 130.96'
NEW REFERENCE POINT: SET 2 1/4" ALUMINUM PIPE WITH 3 1/4" USFS EMBOSSED ALUMINUM CAP S 60° 16' 43"W, 132.22'
SET 6" FIBERGLASS POST WITH A USFS 54-9 (DECAL) STICKER ATTACHED N 58E, 3' AND S 60W, 3' ON PROPERTY LINE FROM SET MONUMENT.

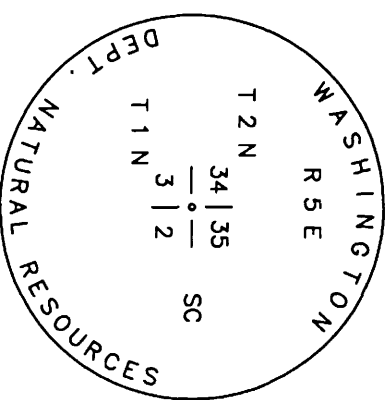

1

FOUND DNR CONCRETE MONUMENT WITH 3" BRASS CAP AS SHOWN IN SP 3-91.
FOUND ORIGINAL 1859 GLO BEARING TREE: 68" FIR, S 36° 45'E, 57.4' WITH HEALED BLAZE. ADDED 54-3 & 54-9 SIGNS
FOUND ORIGINAL 1859 GLO BEARING TREE: 52" FIR STUMP, S 13° 30' W, 88.4' WITH SAWED OUT FACE AND PARTIAL VISIBLE SCRIBING (UNREADABLE). ADDED 54-3 & 54-9 SIGNS
FOUND 1970 DNR REFERENCE TREE: 20" ALDER BLOWDOWN, N 60E, 21.5'
FOUND 1991 HAGEDORN INC. REFERENCE TREE: 24" HEMLOCK, N 86° 45'E, 44.5' WITH HEALED BLAZE. ADDED 54-3 & 54-9 SIGNS & PAINTED RED BAND
FOUND 1991 HAGEDORN INC. REFERENCE TREE: 22" HEMLOCK, S 23° 45'E, 20.0' WITH HEALED BLAZE. ADDED 54-3 & 54-9 SIGNS & PAINTED RED BAND
FOUND 1991 HAGEDORN INC. REFERENCE TREE: 28" CEDAR, S 54° 45' W, 39.5' WITH PARTIAL HEALED BLAZE & VISIBLE SCRIBING (UNREADABLE). ADDED 54-3 & 54-9 SIGNS & PAINTED RED BAND
FOUND WITNESS POST WITH A USFS 54-9 (DECAL) STICKER ATTACHED 0.4' WEST FROM FOUND MONUMENT.

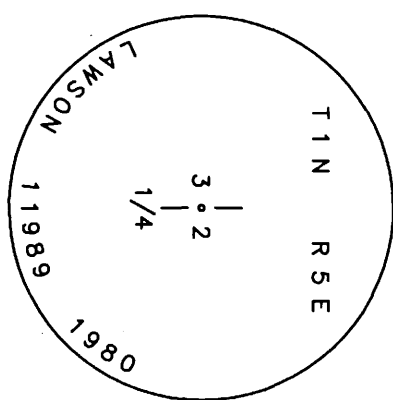

2

FOUND 2 1/2" BRASS CAP AS SET IN R.O.S. 1-273.
FOUND ORIGINAL 1859 GLO BEARING TREE: 36" FIR STUMP, N 81° 15' W, 116.9' TO CENTER AND 115.40' TO FACE. ADDED 54-3 SIGN
FOUND 1981 LAWSON REFERENCE TREE: 16" MAPLE, N 48° 15'E, 22.5' TO CENTER. ADDED 54-3 & 54-9 SIGNS. PAINTED RED BAND &
FOUND 1981 LAWSON REFERENCE TREE: 11" MAPLE, S 23° 45'E, 21.1' TO CENTER. ADDED 54-3 & 54-9 SIGNS & PAINTED RED BAND
FOUND 1991 HAGEDORN INC. REFERENCE TREE: 7" FIR, S 78E, 31.8' TO CENTER WITH DOUBLE HEALED BLAZE. ADDED 54-3 & 54-9 SIGNS & PAINTED RED BAND. ALSO FOUND 5/8" IRON ROD WITH YPC STAMPED "HAGEDORN INC." IN FRONT OF TREE, S 78° 04'E, 30.69'.
FOUND 1991 HAGEDORN INC. REFERENCE TREE: 10" FIR, N 82° 15' W, 37.5' TO CENTER WITH HEALED BLAZE. ADDED 54-3 & 54-9 SIGNS & PAINTED RED BAND. ALSO FOUND 5/8" IRON ROD WITH YPC STAMPED "HAGEDORN INC." IN FRONT OF TREE, N 81° 46' W, 36.30'.
FOUND 1991 HAGEDORN INC. REFERENCE TREE: 24" MAPLE, N 18° 45' W, 8.0' TO CENTER WITH HEALED BLAZE. ADDED 54-3 & 54-9 SIGNS & PAINTED RED BAND. ALSO FOUND 5/8" IRON ROD WITH YPC STAMPED "HAGEDORN INC." IN FRONT OF TREE, N 17° 54' W, 5.31'.
FOUND WITNESS POST WITH A USFS 54-9 (DECAL) STICKER ATTACHED S 67E, 2.2' FROM FOUND MONUMENT.

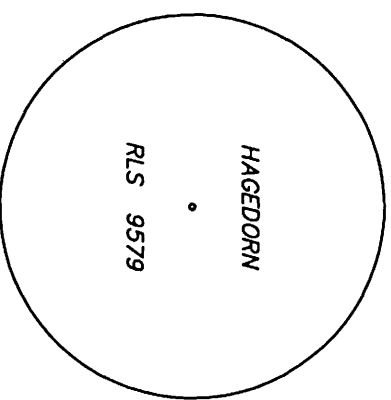

3

FOUND 5/8" IRON ROD WITH YPC.
NEW REFERENCE POINT: SET 2 1/4" ALUMINUM PIPE WITH 3 1/4" USFS EMBOSSED ALUMINUM CAP N 59° 46' 56"E, 200.00'.
NEW REFERENCE POINT: SET 5/8" IRON ROD, S 38E, 17.35' WITH OPC STAMPED "BROWN 42425" APPROXIMATELY ONE FOOT IN FRONT OF A 9" FIR TREE WITH 54-3 & 54-4 SIGNS & PAINTED RED BAND. (TREE USED ONLY TO NAIL REFERENCE TAGS TO).
SET 6" FIBERGLASS POST WITH A USFS 54-9 (DECAL) STICKER ATTACHED N 60E, 5' AND N 30W, 5' ON PROPERTY LINE FROM FOUND MONUMENT.

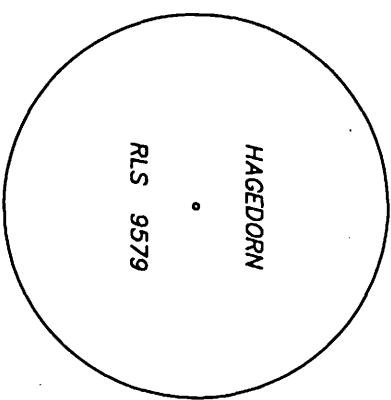

4

FOUND 1/2" IRON ROD WITH YPC.
NEW REFERENCE POINT: SET 5/8" IRON ROD, S 65W, 39.73' WITH OPC STAMPED "BROWN 42425" APPROXIMATELY ONE FOOT IN FRONT OF A 20" FIR TREE WITH 54-3 & 54-4 SIGNS & PAINTED RED BAND. (TREE USED ONLY TO NAIL REFERENCE TAGS TO).
NEW REFERENCE POINT: SET 5/8" IRON ROD, N 37W, 34.47' WITH OPC STAMPED "BROWN 42425" APPROXIMATELY ONE FOOT IN FRONT OF A 10" FIR TREE WITH 54-3 & 54-4 SIGNS & PAINTED RED BAND. (TREE USED ONLY TO NAIL REFERENCE TAGS TO).
SET 6" FIBERGLASS POST WITH A USFS 54-9 (DECAL) STICKER ATTACHED N 30W, 3' ON PROPERTY LINE FROM FOUND MONUMENT.

SURVEY

in the SW 1/4 NW 1/4
and SE 1/4 NW 1/4
and the SW 1/4 NE 1/4 of
SECTION 2, T1N, R5E, W.M.
SKAMANIA COUNTY, WA.

NOTE

BEARINGS SHOWN FOR BEARING TREES AND REFERENCE POINTS ARE BASED ON A DECLINATION OF 17° E, SET ON OUR HAND HELD COMPASSES (UNLESS NOTED TO THE NEAREST SECOND). DISTANCES REPORTED ARE TO CENTER OF THE TREE, ONE FOOT ABOVE THE GROUND (UNLESS NOTED OTHERWISE). NEW B.T.S HAVE A PAINTED 6" RED BAND AT DBH, HAVE A 54-3 SIGN NAILED FACING CORNER AND HAVE A 54-4 OR 54-9 SIGN NAILED ON THE BACK. THEY ALSO HAVE A BRASS WASHER (LS 42425) TACKED IN THE NEWLY SCRIBED B.

LEGEND

- BT = BEARING TREE
- USFS = UNITED STATES FOREST SERVICE
- OPC = ORANGE PLASTIC CAP
- YPC = YELLOW PLASTIC CAP
- DBH = DIAMETER BREAST HEIGHT
- 54-3 = A 4 1/2 x 5" METAL "BEARING TREE" SIGN
- 54-4 = A 7 x 5" METAL "ATTENTION" SIGN
- 54-9 = A 7 x 5" METAL "LAND SURVEY MONUMENT" SIGN OR A 2 1/2 x 1 1/2 STICKER (DECAL) ON A 6 FOOT FIBERGLASS POST
- R/W = RIGHT OF WAY

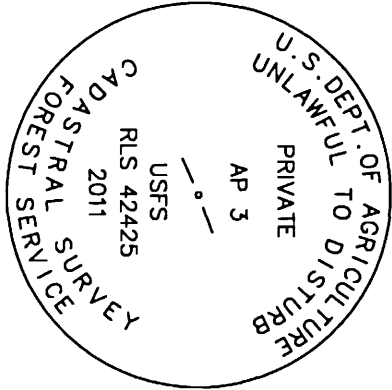

9
SET 2 1/4" ALUMINUM PIPE WITH 3 1/4" USFS EMBOSSED ALUMINUM CAP STAMPED AS SHOWN:
NEW REFERENCE POINT: SET 2 1/4" ALUMINUM PIPE WITH 3 1/4" USFS EMBOSSED ALUMINUM CAP N 60°16'43"E, 132.27'
NEW REFERENCE POINT: SET 2 1/4" ALUMINUM PIPE WITH 3 1/4" USFS EMBOSSED ALUMINUM CAP S 60°38'43"W, 182.90'
SET 6' FIBERGLASS POST WITH A USFS 54-9 (DECAL) STICKER ATTACHED S 61°W, 3' AND N 60°E, 4' ON PROPERTY LINE FROM SET MONUMENT.

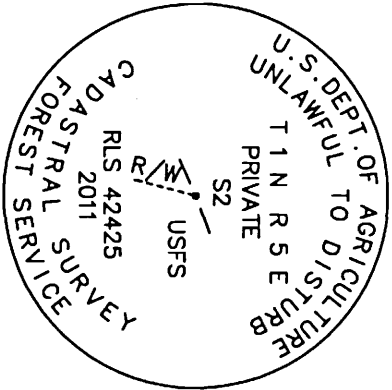

10
SET 2 1/4" ALUMINUM PIPE WITH 3 1/4" USFS EMBOSSED ALUMINUM CAP IN ROCK MOUND STAMPED AS SHOWN:
NEW REFERENCE POINT: SET 2 1/4" ALUMINUM PIPE WITH 3 1/4" USFS EMBOSSED ALUMINUM CAP N 60°38'43"E, 182.90'
NEW REFERENCE POINT: SET 5/8" I.R. S 33°10'07"W, 52.32' WITH OPC STAMPED BROWN 42425 APPROXIMATELY ONE FOOT IN FRONT OF A 24" FIR TREE WITH 54-3 & 54-4 SIGNS & PAINTED RED BAND. (TREE USED ONLY TO NAIL REFERENCE TAGS TO)
SET 6' FIBERGLASS POST WITH A USFS 54-9 (DECAL) STICKER ATTACHED N 61°E, 3' ON PROPERTY LINE FROM SET MONUMENT.

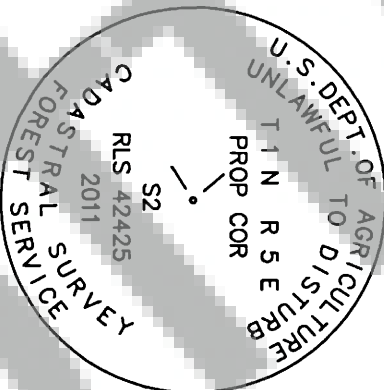

11
SET 2 1/4" ALUMINUM PIPE WITH 3 1/4" USFS EMBOSSED ALUMINUM CAP IN ROCK MOUND STAMPED AS SHOWN:
NEW REFERENCE POINT: FOUND 5/8" IRON ROD S 59°46'56"W, 200.00' WITH YPC STAMPED "HAGEDORN RLS 9579"
NEW REFERENCE POINT: SET 5/8" IRON ROD N 131°23'37"W, 93.07' WITH OPC STAMPED BROWN 42425 APPROXIMATELY ONE FOOT IN FRONT OF A 24" FIR TREE WITH 54-3 & 54-4 SIGNS & PAINTED RED BAND (TREE USED ONLY TO NAIL REFERENCE TAGS TO).
SET 6' FIBERGLASS POST WITH A USFS 54-9 (DECAL) STICKER ATTACHED N 30°E, 5' AND S 60°W, 4' ON PROPERTY LINE FROM SET MONUMENT.

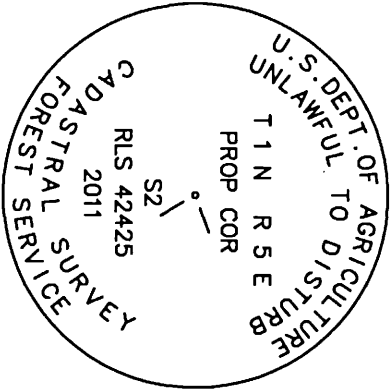

12
SET 2 1/4" ALUMINUM PIPE WITH 3 1/4" USFS EMBOSSED ALUMINUM CAP IN ROCK MOUND STAMPED AS SHOWN:
NEW BEARING TREE: 13" FIR, N 75°E, 89.7' SCRIBED "PROP COR S2 BT"
NEW BEARING TREE: 14" FIR, N 13°W, 46.5' SCRIBED "PROP COR S2 BT"
SET 6' FIBERGLASS POST WITH A USFS 54-9 (DECAL) STICKER ATTACHED S 30°E, 3' AND N 60°E, 3' ON PROPERTY LINE FROM SET MONUMENT.

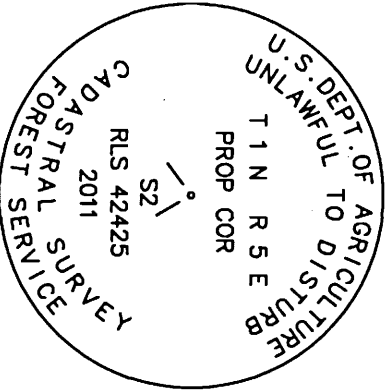

13
SET 2 1/4" ALUMINUM PIPE WITH 3 1/4" USFS EMBOSSED ALUMINUM CAP IN ROCK MOUND STAMPED AS SHOWN:
NEW BEARING TREE: 21" FIR, N 67°E, 14.2' SCRIBED "PROP COR S2 BT"
NEW BEARING TREE: 22" FIR, S 21°E, 10.8' SCRIBED "PROP COR S2 BT"
SET 6' FIBERGLASS POST WITH A USFS 54-9 (DECAL) STICKER ATTACHED S 60°W, 3' AND S 30°E, 3' ON PROP LINE FROM SET MONUMENT.



6/24/2011

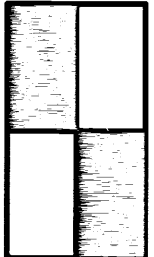

HAGEDORN, INC.
Surveying and Engineering
1924 Broadway Vancouver, Wa. 98663
Ph: (360) 696-4428

SCALE: NA
DATE: 5/19/11
JOB NO.: 10-123
CALC. BY: GAB
DRAWN BY: CC
CHECKED BY: BPT
DWG# SURVEY-PAGE-3-4
PAGE 4 OF 4