

SURVEY

in the SW 1/4 SE 1/4 of
SECTION 20, T2N, R5E, W.M.
SKAMANIA COUNTY, WA.

DEED REFERENCE

STATUTORY WARRANTY DEED
HARTELOO TO KEAR
AFN 2010177105 (12/14/2010)

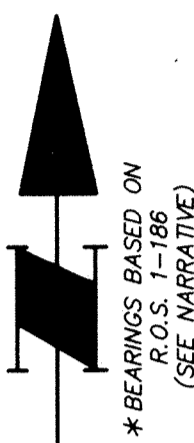

0 50 100 200
SCALE 1"=100'

NARRATIVE

THE PURPOSE OF THIS SURVEY IS TO CALCULATE AND MONUMENT THE CITED "KEAR TRACT" AS SHOWN. RECORD BEARING OF NORTH 88° 40' 22" WEST DERIVED FROM R.O.S. 1-186 WAS HELD BETWEEN THE SOUTHWEST CORNER AND THE SOUTHEAST CORNER OF SECTION 29. A CONTROL TRAVERSE WAS RUN BETWEEN THESE MONUMENTS AND ROTATED TO SAID RECORD BEARING. A SECOND TRAVERSE WAS RUN THROUGH THE SITE WITH RADIAL TIES MADE TO OTHER FOUND MONUMENTS. BOTH TRAVERSES MET THE STANDARDS CONTAINED IN WAC 332-130-090. NEW CORNERS ESTABLISHED IN THIS SURVEY WERE SET BY RADIAL STAKEOUT FROM THE ABOVE MENTIONED TRAVERSES. A 2-SECOND "TOTAL STATION INSTRUMENT" WITH ELECTRONIC DATA COLLECTOR WAS USED FOR ALL FIELD WORK. ACCESS FOR THIS PROPERTY IS CURRENTLY THROUGH THE "KEAR TRACT" (TL 1700) LYING WEST OF THIS SURVEY.

LEGEND

- FOUND MONUMENT AS NOTED (TIED 11/11/2010)
- ⊙ SET 5/8" x 30" IRON REBAR WITH ORANGE PLASTIC CAP STAMPED "BESEDA 34127" WITH STEEL FENCEPOST SET ALONGSIDE

R.O.S. = RECORD OF SURVEY

() RECORD DATA PER R.O.S. 1-186

AFN = AUDITOR'S FILE NUMBER

I.R. = IRON ROD

YPC = YELLOW PLASTIC CAP

SURVEYOR'S CERTIFICATE

This map correctly represents a survey made by me or under my direction in conformance with the requirements of the Survey Recording Act at the request of JERRY HARTELOO in NOVEMBER, 2010

CARL A. BESEDA
PROFESSIONAL LAND SURVEYOR

34127
CERTIFICATE NO.

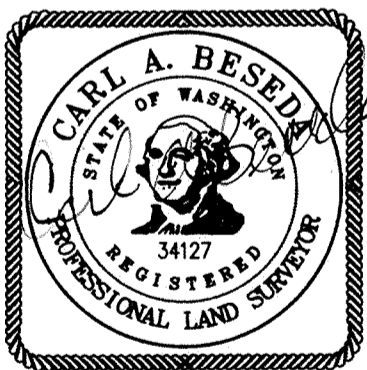

12/21/2010

AUDITOR'S CERTIFICATE

Filed for record this 22nd day of December, 20 10
at 2:03pm. under AF# 2010177310 at the
request of Hagedorn, Inc.
(Signed) Melissa Anderson
(Deputy County Auditor)

NOTE: Hagedorn, Inc. makes no warranties as to matters of unwritten title such as acquiescence, estoppel, adverse possession, etc.

HAGEDORN, INC.
Surveying and Engineering

1924 Broadway Vancouver, Wa. 98663
Ph: (360) 696-4428

SCALE: 1"=100'
DATE: 12/16/10
JOB NO.: 10-124

CALC. BY: CAB
DRAWN BY: CC
CHECKED BY: BPT

DWG# SURVEY-10-124

FOUND AND HELD 5/8" I.R.
WITH YPC "WALLACE 13548"
AS SHOWN IN R.O.S. 1-157
AT NW CORNER OF SW 1/4
SE 1/4 OF SECTION 20

TAX LOT 800

FOUND AND HELD 5/8" I.R.
WITH YPC "WALLACE 13548"
AS SHOWN IN R.O.S. 1-157
FOR NORTH LINE OF SW 1/4
SE 1/4 OF SECTION 20

HARTELOO
6.59 ACRES

TAX LOT 1900

KEAR

20 ACRES
AFN 2010177105 (12/14/2010)

KEAR
TAX LOT 1700

FOUND FISH AND GAME BRASS
CAP IN MONUMENT N 79°32'45"W,
0.74' FROM HELD CALCULATED
POSITION BY SINGLE PROPORTION

19 20
30 29
(2616.62')

FOUND SKAMANIA COUNTY
BRASS CAP IN MONUMENT BOX
AS SHOWN IN R.O.S. 1-186

* (N 88°40'22" W 5233.24')

FOUND DNR BRASS CAP IN
CONCRETE MONUMENT AS
SHOWN IN R.O.S. 1-186