

LEGEND

- SET 5/8"x24" CAPPED REBAR
- EXISTING REBAR
- ⊙ EXISTING IRON PIPE
- x — EXISTING FENCE

REFERENCES

HUSTON K. DILLON SHORT PLAT NO 90409
 SURVEYS 91124, 104701, 95054, 112421
 98792, 2006162724, 2006162405

BASIS OF BEARINGS

SURVEY 91124

MONUMENTS VISITED

MAY, 2009

LEGAL DESCRIPTION (DEED 90069)

BEGINNING AT THE SE CORNER OF THE S1/2 OF THE NW1/4 OF SECTION 23, T 3 N, R 8 E, WM; THENCE NORTHERLY ALONG THE NORTH-SOUTH CENTERLINE OF SAID SECTION 23, 283' TO THE TRUE POINT OF BEGINNING; THENCE CONTINUING NORTHERLY ALONG THE NORTH-SOUTH CENTERLINE 208'; THENCE WESTERLY 208' ALONG A LINE PARALLEL WITH THE EAST-WEST CENTERLINE OF SAID SECTION 23; THENCE SOUTHERLY 208'; THENCE EASTERLY 208' TO THE TRUE POINT OF BEGINNING.

SECTION 23-3-8

NOT TO SCALE

SURVEY NARRATIVE

THE PURPOSE OF THIS SURVEY IS TO LOCATE THE BOUNDARY OF THE HOME VALLEY WATER DISTRICT WATER WORKS SITE. THE 2" IRON PIPE WAS HELD FOR THE CENTER OF SECTION. THIS IRON PIPE HAS BEEN USED FOR LOCAL SURVEYS, INCLUDING THE HUSTON K. DILLON SHORT PLAT AND SURVEYS 104701, 2006162724 AND 2006162405. THE NORTH 1/4 CORNER WAS TIED WHICH INDICATED THAT THE CENTER NORTH 1/16 CORNER, A 1" IRON PIPE SET BY LAWSON, WAS OUT OF POSITION BY ABOUT 3' WEST AND 2' SOUTH, HOWEVER IT HAS BEEN USED TO ESTABLISH THE EAST BOUNDARY. CORNERS FROM SURVEY NO 91124 AND SURVEY 2006162405 WERE ALSO TIED. THE WEST 1/4 CORNER WAS CALCULATED FROM THE FOUND SURVEY 91124 POINTS. THE PROPERTY BOUNDARIES WERE SET BASED ON THE LINES CALCULATED FROM THE 2" IRON PIPE TO THE CENTER NORTH 1/16 CORNER AND THE WEST 1/4 CORNER. THIS SURVEY SUPERSEDES SURVEY 2007166994 WHICH DID NOT HOLD THE CENTER NORTH 1/16 CORNER.

BASIS OF BEARINGS

S88°49'35"E 399.91'(400')

S88°47'43"E 454.30'

FD LS 9025 1/2"REBARS

THESE REBARS ARE ON THE "TRUE" CENTER OF SECTION LINE.

THIS SURVEY SUPERSEDES SURVEY 2007166994.

Survey For
Home Valley Water District
 Section 23, T. 3 N, R. 8 E, W.M.
 Skamania County, Washington

PSE Pioneer Surveying & Engineering, Inc.
 Civil Engineering and Land Planning
 228 South Columbus Avenue, Suite 104
 Goldendale, Washington 98620
 Phone (509) 773-4945, Fax (509) 773-5888, E-Mail pse@gorge.net

Date: 11-23-09
 Scale: 1" = 50'
 Drawn By: FEC
 Surveyed By: GF/PB/DC
 Checked By: FEC
 Sheet 1 Of 1
 Job No: 07-056-SURVEY-R

Accuracy Statement (WAC 332-130)
 This survey was performed using a Lietz Set-4 Total Station, by Field Traverse with Relative Accuracy greater than 1:5000 Mathematical Analysis is by Compass Rule

Note
 No warranties are made as to matters of encroachment, adverse possession, unwritten title, riparian changes or flood zones, etc.

Surveyor's Certificate
 This Map correctly represents a Survey made by me or under my direction in conformance with the requirements of the Survey Recording Act at the request of
 Home Valley Water District in 3-09.
 11-23-09
 Frank E. Childs, Jr., PLS 18028 Date

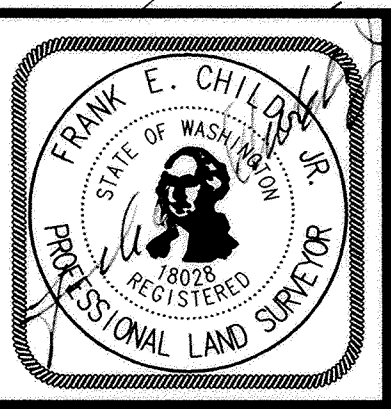

Index

1/4	1/4	Sec.	T.	R.

23 3N 8E

Auditor's Certificate
 Filed For Record This 7th Day of December 2009.
 At 8:19 A.M. AP 2009174450
 In Book Of Surveys At Page
 At The Request Of Pioneer Surveying and Engineering, Inc.
 Melvin Anderson
 County Auditor Deputy
 2009174450
 Auditor's Number