

MINISTER AND GLAESER SURVEYING, INC. MAKES NO WARRANTIES AS TO MATTERS OF UNWRITTEN TITLE SUCH AS ADVERSE POSSESSION, ACQUIESCENCE, ESTOPPLE, ETC.

ALL CONTROLLING CORNERS (SECTION AND QUARTER CORNERS) AND PRIMARY CONTROL WERE DOUBLED TIED USING RTK-GPS FROM WSDOT GEODETIC CONTROL POINTS "GP30014-5,20,21&22" AND CLARK COUNTY GEODETIC CONTROL POINT "53". A FIELD TRAVERSE WAS PERFORMED USING A ONE SECOND TOTAL STATION TO TIE ANY INTERIOR CORNERS, FENCES, STRUCTURES AND TO SET PROPERTY CORNERS. THE FIELD TRAVERSE WAS ADJUSTED USING "STAR-NET" LEAST SQUARES ADJUSTMENT SOFTWARE. THE TRAVERSE MET THE MINIMUM STANDARDS FOR SURVEYS AS DESIGNATED IN WAC 332-130-090. ALL CORNERS NOTED AS FOUND WERE VISITED BETWEEN AUGUST 2004 AND OCTOBER 2004.

RECORD SURVEY

IN A PORTION OF NE 1/4
AND THE SE 1/4 OF
THE SE 1/4 OF SECTION 9
T. 1 N., R. 5 E., W.M.
SKAMANIA COUNTY, WASHINGTON
SHEET 1 OF 2

200 100 0 200 300 400

SCALE 1 INCH = 200 FEET

DISTANCES AND COORDINATES SHOWN HEREON ARE BASED ON A WSDOT PROJECT DATUM TO PROJECT BACK TO GRID, SUBTRACT 328083.333 FEET FROM PROJECT COORDINATE AND MULTIPLY BY THE COMBINED SCALE FACTOR OF 1.00004070 (0.21 FEET PER MILE/0.004 FEET PER 100 FEET)

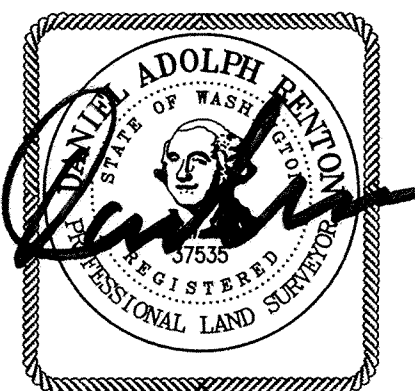

11/17/2009

S01°40'23"W
(2667.62' S1)

S88°51'15"E
1283.13'

BASIS OF BEARING: NAD 83/91, WASHINGTON STATE PLANE COORDINATE SYSTEM, SOUTH ZONE, US FEET CONVERTED TO WSDOT PROJECT DATUM.
MEAN CONVERGENCE ANGLE: -01°14'13"
MEAN COMBINED SCALE FACTOR: 1.00004070
SEE SURVEY REFERENCE 1.

MONUMENT LIST

1. FOUND A 3/4" IRON PIPE, HELD FOR THE SOUTH QUARTER CORNER OF SECTION 9. SEE SURVEY REFERENCE 1.
2. FOUND A 1" IRON PIPE WITH A 3" BRASS DISK IN THE PAVEMENT OF CAPE HORN DEPOT ROAD. HELD FOR THE SECTION CORNER COMMON TO SECTIONS 9,10,15&16. SEE SURVEY REFERENCE 1.
3. FOUND A 1" IRON PIPE WITH A 3" BRASS DISK. HELD FOR THE EAST QUARTER CORNER OF SECTION 9. SEE SURVEY REFERENCE 1.
4. FOUND A 1" IRON PIPE WITH A 3" BRASS DISK. HELD FOR THE CENTER OF SECTION OF SECTION 9. SEE SURVEY REFERENCE 1.

DEED REFERENCE

1. GRANTOR: THOMAS N. AND CHERYL B. TRENT
GRANTEE: DARREN GILLETTE
AFN #2008170895

SURVEY REFERENCE

1. "RENTON" AFN #2008169859

SHEET INDEX:

SHEET 1-SURVEYORS AND AUDITORS CERTIFICATE, VICINITY MAP, MONUMENT LIST, DEED REFERENCE, SURVEY REFERENCE, ETC.

SHEET 2-SURVEY.

SURVEYOR'S CERTIFICATE

THIS MAP CORRECTLY REPRESENTS A SURVEY MADE BY ME OR UNDER MY DIRECTION IN CONFORMANCE WITH THE REQUIREMENTS OF THE SURVEY RECORDING ACT AT THE REQUEST OF DARREN GILLETTE IN SEPTEMBER, 2008

Daniel Adolph Renton 11/17/2009
DANIEL ADOLPH RENTON, PROFESSIONAL
LAND SURVEYOR, LS #37533

AUDITOR'S CERTIFICATE

FILED FOR RECORD THIS 23RD DAY OF November 2009 AT
4:59 P.M. AS AUDITOR'S FILE # 2009174355
AT THE REQUEST OF MINISTER AND GLAESER SURVEYING, INC.

Melina Anderson
SKAMANIA COUNTY AUDITOR Deputy

SCALE: 1"=200'
JOB NO. 08-225
DATE: 11-17-09
CALC BY: DAR
DRAWN BY: DAR
CHECKED BY: CTP
SHEET 1 OF 2

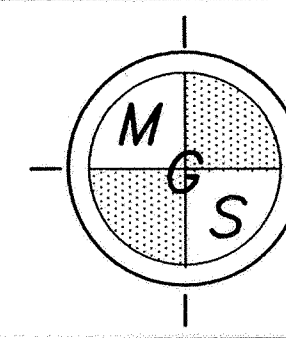

MINISTER-GLAESER
SURVEYING INC.
2200 E. EVERGREEN BLVD.
VANCOUVER, WA 98661
(360) 694-3313

AF 2009174355

pg. 1 of 2

RECORD SURVEY

IN A PORTION OF NE 1/4
AND THE SE 1/4 OF
THE SE 1/4 OF SECTION 9
T. 1 N., R. 5 E., W.M.
SKAMANIA COUNTY, WASHINGTON
SHEET 2 OF 2

LEGEND:

(X) INDICATES FOUND MONUMENT AS NOTED.

(1) INDICATES MONUMENT LIST SHEET 1.

WSDOT INDICATES WASHINGTON DEPARTMENT OF TRANSPORTATION.

(S1) INDICATES SURVEY REFERENCE.

(D1) INDICATES DEED REFERENCE

STA INDICATES STATION.

SR INDICATES STATE ROUTE.

PC INDICATES POINT OF CURVATURE.

PCC INDICATES POINT OF COMPOUND CURVE.

PT INDICATES POINT OF TANGENT.

RT INDICATES RIGHT OF STATION.

LT INDICATES LEFT OF STATION.

— INDICATES COMPUTED CENTERLINE.

- - - INDICATES COMPUTED RIGHT OF WAY.

TAX PARCEL
01050900100006
AFN #2008170895

NARRATIVE:

THE PURPOSE THIS SURVEY WAS TO MONUMENT AND MARK THE BOUNDARY LINES OF TAX PARCEL 01050900100006.

THE SAID TAX PARCEL WAS DESCRIBED AS 2 PARCELS. THE LARGER PARCEL WAS DESCRIBED AS THE NE 1/4 OF THE SE 1/4 OF SECTION 9, EXCEPTING OUT THE RIGHT OF WAY FOR SR14. THE RIGHT OF WAY FOR SR14 WAS COMPUTED FROM SURVEY REFERENCE NO. #1 AND THE WASHINGTON DEPARTMENT OF TRANSPORTATION "SR 14 CLARK COUNTY LINE TO PRINDLE VICINITY" APPROVED SEPTEMBER 4, 2008.

THE SMALLER PARCEL WAS DESCRIBED AS FOLLOWS: "BEGINNING AT A POINT 20 CHAINS NORTH OF THE SE CORNER OF 9; THENCE WEST 3.75 CHAINS; THENCE SOUTH 30° WEST 2.85 CHAINS; THENCE EAST 5.175 CHAINS; THENCE NORTH 2.25 CHAINS TO THE POINT OF BEGINNING". WE HELD THE SE CORNER OF THE NE 1/4 OF THE SE 1/4 OF SECTION 9 FOR THE POINT OF BEGINNING INSTEAD OF THE CALL "20 CHAINS NORTH OF THE SOUTHEAST CORNER OF SECTION 9". WE HELD THE DEED DISTANCE OF 3.75 CHAINS (247.50') ALONG THE SOUTH LINE OF THE NE 1/4 OF THE SE 1/4 OF SECTION 9. WE HELD THE DEED DISTANCE OF 2.25 CHAINS (148.50') ALONG THE EAST LINE OF THE SE 1/4 OF THE SE 1/4 OF SECTION 9. WE DID A DISTANCE-DISTANCE INTERSECTION HOLDING THE POINT CREATED ON SAID NORTH LINE AND THE HOLDING THE POINT CREATED ON SAID EAST LINE WHICH CREATED THE SW CORNER OF SAID SMALLER PARCEL.

THE SURVEY SHOWS AN EASEMENT BETWEEN CAPE HORN ROAD AND THE SUBJECT PROPERTY WHICH IS RECORDED UNDER AUDITOR'S FILE NUMBER #2005158770. THIS EASEMENT GRANTS ACCESS TO THE SUBJECT PROPERTY. THE RIGHT OF WAY FOR CAPE HORN ROAD WAS COMPUTED BY HOLDING THE SURVEYED APPARENT CENTERLINE AND USING A 40 FOOT RIGHT OF WAY PER CAPE HORN ROAD WAIVERS FOUND ON PAGE 35 (MARCH 1913), PAGE 71 (MARCH 1919) AND PAGE 99 (MAY 1933).

| LINE TABLE | | |
|------------|--------|-------------|
| LINE | LENGTH | BEARING |
| L1 | 55.72 | N60°47'13"E |
| L2 | 66.69 | S03°43'13"W |

| CURVE TABLE | | | | |
|-------------|---------|----------|-----------|---------------------|
| CURVE | LENGTH | RADIUS | DELTA | CHORD BEARING |
| C1 | 227.14' | 500.00' | 26°01'43" | 225.19' S47°46'21"W |
| C2 | 42.37' | 500.00' | 4°51'19" | 42.36' S32°19'51"W |
| C3 | 120.20' | 1800.00' | 3°49'34" | 120.18' S27°59'24"W |
| C4 | 91.59' | 400.00' | 13°07'12" | 91.39' S19°31'01"W |
| C5 | 40.17' | 520.00' | 4°25'32" | 40.16' S32°06'57"W |
| C6 | 121.54' | 1820.00' | 3°49'34" | 121.51' S27°59'24"W |
| C7 | 17.69' | 420.00' | 2°24'49" | 17.69' S24°52'13"W |

100' 50' 0' 100' 150' 200'
SCALE 1 INCH = 100 FEET

DISTANCES AND COORDINATES SHOWN HEREON
ARE BASED ON A WSDOT PROJECT DATUM
TO PROJECT BACK TO GRID, SUBTRACT 328083.333 FEET
FROM PROJECT COORDINATE AND MULTIPLY BY
THE COMBINED SCALE FACTOR OF 1.00004070
(0.21 FEET PER MILE/0.004 FEET PER 100 FEET)

SCALE: 1"=100'
JOB NO. 08-225
DATE: 11-17-09
CALC BY: DAR
DRAWN BY: DAR
CHECKED BY: CTP
SHEET 2 OF 2

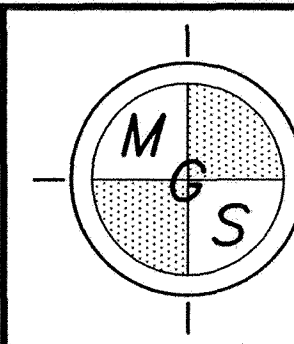

MINISTER-GLAESER
SURVEYING INC.
2200 E. EVERGREEN BLVD.
VANCOUVER, WA 98661
(360) 694-3313

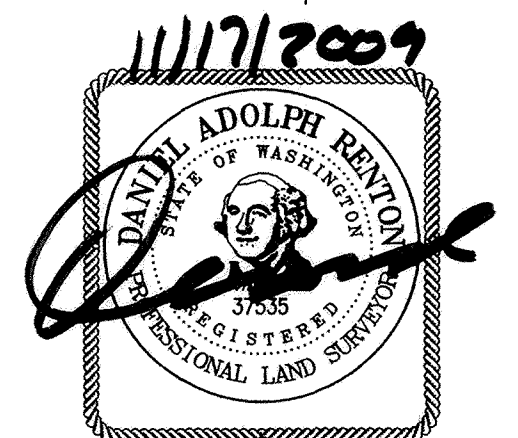

BASIS OF BEARING: NAD 83/91, WASHINGTON STATE
PLANE COORDINATE SYSTEM, SOUTH ZONE, US FEET
CONVERTED TO WSDOT PROJECT DATUM
MEAN CONVERGENCE ANGLE: -01°14'13"
MEAN COMBINED SCALE FACTOR: 1.00004070
SEE SURVEY REFERENCE 1.