

# SURVEY

in the NW 1/4 SW 1/4 and  
the SW 1/4 SW 1/4 of  
SECTION 27, T2N, R5E, W.M.  
SKAMANIA COUNTY, WA.

POSITION OF 3" SKAMANIA COUNTY  
BRASS CAP IN MOUND OF  
STONES AS SHOWN IN  
AFN 2008170153.  
(TIED MARCH, 1996)

C-W 1/16  
POSITION OF 5/8" I.R.  
WITH YPC STAMPED  
"SIMES 31454" AS  
SHOWN IN AFN 2008170153

## DEED REFERENCE

WARRANTY DEED  
DENNIS AND MARILYN CLARK  
TO  
JSC FAMILY, LLC  
AFN 2008169241 (3/13/2008)  
QUIT CLAIM DEED  
JSC FAMILY, LLC  
TO CLARK  
AFN 2009171845 (1/12/2009)  
QUIT CLAIM DEED  
CLARK TO  
JSC FAMILY, LLC  
AFN 2009171846 (1/12/2009)

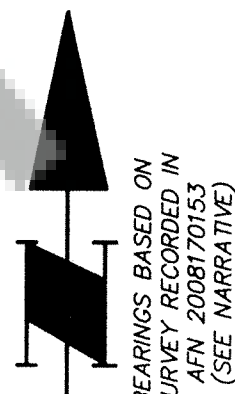

## LEGEND

- POSITION OF 5/8" I.R. WITH ORANGE PLASTIC CAP STAMPED "BROWN 42425" AS SHOWN IN AFN 2008170153, UNLESS NOTED OTHERWISE (NOT VISITED DURING THIS SURVEY)
  - ⊙ SET 5/8" x 30" IRON REBAR WITH ORANGE PLASTIC CAP STAMPED "BROWN 42425" WITH STEEL FENCE POST AND 10' PVC POST SET ALONGSIDE. (SET 12/10/2008)
  - ⊠ STEEL FENCE POST SET WITH 10' PVC POST SET ON LINE, DISTANCE TO NEAREST FOOT
  - ◆ POSITION OF STEEL FENCE POST WITH 10' PVC POST SET ON LINE, DISTANCE TO NEAREST FOOT AS SHOWN IN AFN 2008170153
- R.O.S. = RECORD OF SURVEY  
( ) RECORD DATA PER AFN 2008170153  
AFN = AUDITOR'S FILE NUMBER  
I.P. = IRON PIPE  
I.R. = IRON ROD  
CL = CENTERLINE  
YPC = YELLOW PLASTIC CAP

## SURVEYOR'S CERTIFICATE

This map correctly represents a survey made by me or under my direction in conformance with the requirements of the Survey Recording Act at the request of DEAN MCCLAIN in DECEMBER, 2008

GREGORY ALAN BROWN  
PROFESSIONAL LAND SURVEYOR

42425  
CERTIFICATE NO.

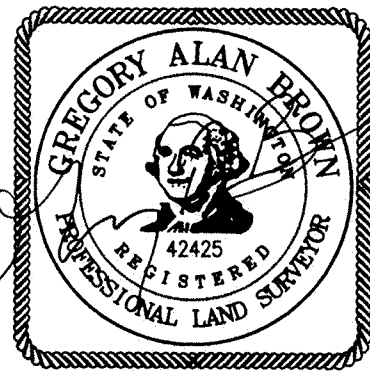

5/28/2009

## AUDITOR'S CERTIFICATE

Filed for record this 1 day of June, 20 09  
at 11:45a.m. under AF# 2009173001 at the  
request of Hagedorn, Inc.  
(Signed) Heidi B. Penner  
(Deputy County Auditor)

NOTE: Hagedorn, Inc. makes no warranties as to matters of unwritten title such as acquiescence, estoppel, adverse possession, etc.

**HAGEDORN, INC.**  
Surveying and Engineering

1924 Broadway Vancouver, Wa. 98663  
Ph: (360) 696-4428

SCALE: 1"=200'  
DATE: 5/21/09  
JOB NO.: 08-197

CALC. BY: GAB  
DRAWN BY: CC  
CHECKED BY: CEW

DWG# 08-197  
SHEET 1 OF 1

## NARRATIVE

THE PURPOSE OF THIS SURVEY WAS TO MONUMENT THE RESULTANT BOUNDARY LINE ADJUSTED "JSC FAMILY LLC TRACT" AND "CLARK TRACT" CITED. NEW MONUMENTS ESTABLISHED WERE SET RADially FROM EXISTING TRAVERSE POINTS USED IN AFN 2008170153 WHICH MET THE REQUIREMENTS OF WAC 332-130-090. FIELD EQUIPMENT USED CONSISTED OF A 3-SECOND "TOTAL STATION INSTRUMENT" WITH ELECTRONIC DATA COLLECTOR.