

LAND CORNER RECORD

(THIS FORM PRESCRIBED BY THE PUBLIC LAND SURVEY OFFICE, DEPARTMENT OF NATURAL RESOURCES, PURSUANT TO RCW 58.09. ALPHA-NUMERIC INDEX DIAGRAM ON THE BACK.)

CORNER INDEXING INFORMATION:

TWP 3 North RGE 9 East CORNER CODE Y-Z 5
(Willamette Meridian) (See instructions on back of LCR)

ADDITIONAL IDENTIFIER: (e.g., BLM designation for the corner, street intersection, plat name, block, lot, etc.)

Meander corner between Section 31 and 32

COUNTY: Skamania

AUDITOR'S USE

LAND SURVEYOR INFORMATION: (or Public Officer as per RCW 58.09.090)

This corner record correctly represents work performed by me or under my direction in conformance with the Survey Recording Act.

COMPANY OR AGENCY: Washington State Department of Transportation

ADDRESS: 11018 NE 51st Circle
Vancouver, Washington
98682-6686
360-905-2154

John E. Thomas, PLS
Cadastral Surveyor

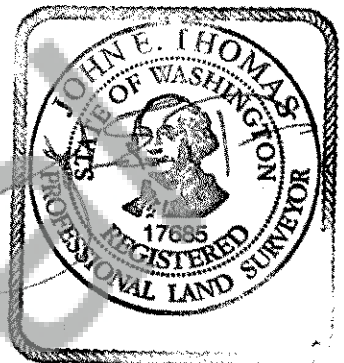

4/17/09

SEAL/SIGNATURE/DATE

WASHINGTON PLANE COORDINATES: N: 135606.216

E: 1330814.259

ORDER: WSRN (Washington State Reference Network) Network solution

ZONE: SOUTH DATUM (Date of adjustment):
NAD 83/ CORS 96 epoch 2002.00

CORNER INFORMATION: Use the space below to provide the following information regarding the corner:

(1) Pertinent Corner History, (2) Evidence Found at the Corner, and (3) Corner Perpetuation Information. Please title and number the parts of your discussion accordingly. If additional space is needed use the back. (For (3), diagram the references. Also, provide the cross-reference to a map of record, if applicable, the surveyor's field book no./page no., and the date of work.) (See the back of this form for the requirements of the Survey Recording Act.)

(1) Corner History:

On Oct. 7, 1875, Samuel J. Spray, Deputy Surveyor for the GLO set this corner with the following accessories:

A 14 inch willow N 25 W 14 links.

A 14 inch willow N 25 E 16 links.

(Vol. WA-R0038, Pg 547)

The BLM performed a dependant resurvey of Section 31 dated September 2, 1983. The field work was performed from April 26, 1982 to May 21, 1982. The distance shown from the meander corner to the South 1/16 corner between Sections 31 and 32 was 12.315 chains (812.79 feet). WSDOT found the distance to be 812.65 feet between found monuments. In 1982, Rick A. Tawney of the BLM set an iron post, 28 inches long with a brass cap marked:

WC
T 3 N R 9 E
S 31 | S 32
MC
1982

Bearing trees marked were: a 25 inch pine N 23 E 267 links marked S 1/16 S 32 BT
a power pole N 70 1/2 W 88 links identified as S 79 WCP 5 25.

(Vol. WA-R0230, Pg. 206)

(2) FOUND:

On September 17, 2008 a WSDOT crew found a 3" diameter brass cap in an iron pipe stamped as shown in Tawney's notes. The remains of both BT's were present.

(3) CORNER PERPETUATION: A record of survey and right of way plan are being prepared in conjunction with this LCR. (SR 14 Dog Mountain Vic)

CORNER DIAGRAM

N/A

MARK THE CORNER LOCATION ON THE DIAGRAM BELOW AND FILL IN THE CORNER CODE BLANK ON THE OTHER SIDE:

(1) For corners located at the intersection of two lines (Section corners, quarter corners and sixteenth corners):

(a) The corner code is the alpha-numeric coordinate from the diagram below that corresponds to the appropriate intersection of lines.

(2) For corners that are not located at the intersection of two lines (Meander corners, DLC's, HES's, reservation boundaries, mining claims, etc.):

(a) For corners that are on one line only the corner code is the line designation and the related line segment; i.e., a corner on line 5 between "B" and "C" is designated BC-5.

(b) For corners that are between lines the corner code is both line segments; i.e., a corner in the SE1/4 of the SE1/4 of section 18 is designated MN-4-5.

1 2 3 4 5 6 7 8 9 10 11 12 13 14 15 16 17 18 19 20 21 22 23 24 25

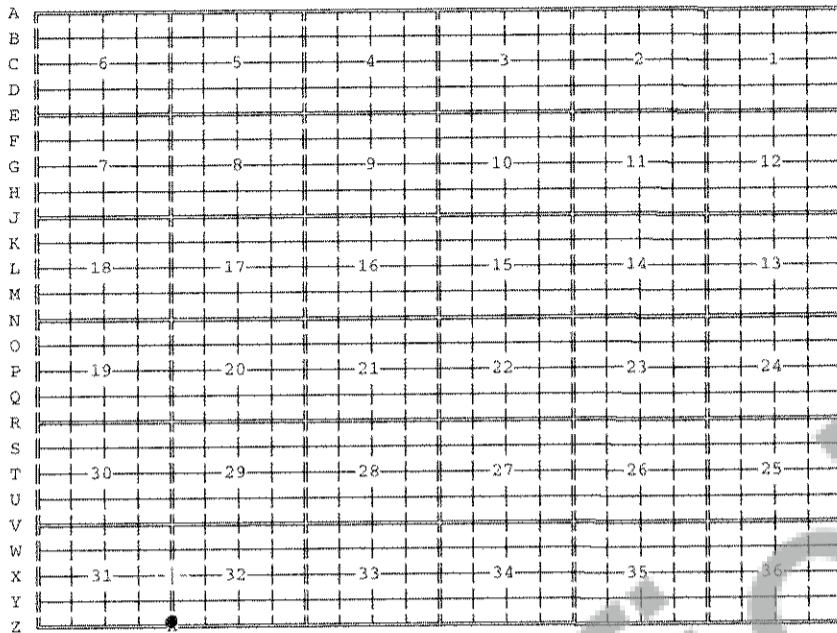

RCW

58.09.060 (2) requires the following information on this form: an accurate description and location, in reference to the corner position, of all monuments and accessories (a) found at the corner and (b) placed or replaced at the corner; (c) basis of bearings used to describe or locate such monuments or accessories; and (d) corollary information that may be helpful to relocate or identify the corner position.

SPACE FOR ADDITIONAL COMMENT:

Unofficial Copy