

Return Address: Mike and Joyce Eastwick
62 Peach Lane
Underwood, WA 98651

Skamania County Community Development Department

Skamania County Courthouse Annex
Post Office Box 790
Stevenson, Washington 98648
509 427-3900 FAX 509 427-3907

Administrative Decision

APPLICANT: Mike and Joyce Eastwick

PROPERTY OWNER: Michael & Joyce Eastwick

FILE NO.: NSA-09-05

PROJECT: To erect a deer fence around agricultural land. Fence will be approximately 7.5 feet tall around the 25 acres of orchard and vineyard.

LOCATION: West of Ausplund and Kollock Knapp Roads, Underwood; Section 19 of T3N, Range 10E, W.M. and identified as Skamania County Tax Lot #03-10-19-0-0-0302-00.

LEGAL: See page(s) 6.

ZONING: General Management Area- Large-Scale Agriculture (Ag-1).

DECISION: Based upon the record and the Staff Report, the application by Mike and Joyce Eastwick, described above, **subject to the conditions set forth in this Decision**, is found to be consistent with SCC Title 22 and **is hereby approved.**

Skamania County Community Development Department
File: NSA-09-05 (Eastwick) Administrative Decision
Page 2

Although the proposed development is approved, it may not be buildable due to inadequate soils for septic and/or lack of potable water. These issues are under the jurisdiction of Skamania County's Building Division and the Skamania County Environmental Health Division.

Approval of this request does not exempt the applicant or successors in interest from compliance with all other applicable local, state, and federal laws.

CONDITIONS OF APPROVAL:

The following conditions are required to ensure that the subject request is consistent with Skamania County Code Title 22. **This document, outlining the conditions of approval, must be recorded by the applicant in the deed records of the Skamania County Auditor** in order to ensure notice of the conditions of approval to successors in interest. SCC §22.06.120(C)(2).

- 1) As per SCC §22.06.120(C)(2), this Administrative Decision **SHALL BE RECORDED** by the applicant in the County deed records prior to commencement of the approved project.
- 2) All developments shall be consistent with the enclosed site plan, unless modified by the following conditions of approval. If modified, the site plan shall be consistent with the conditions of approval. (See attached)
- 3) All structures, except fences, including eaves, awnings and overhangs shall meet the following setbacks: **Front yard:** 50 feet from the centerline of the street or road or 20 feet from the front property line, whichever is greater. **Side yard:** 20 feet. **Rear yard:** 20 feet. Setbacks are established from property lines, not fence lines. If any question arises regarding the location of the property lines, the applicant shall be required to hire a professional land surveyor to locate the property lines and mark them with temporary staking prior to a building permit being issued. Staking must remain during construction and all building inspections.
- 4) The Community Development Department will conduct a final inspection once the project is completed. The inspection may take up to four business days from the time of calling for the inspection. Inspections should be arranged by calling the Building Division at 509-427-3900.
- 5) The following procedures shall be effected when cultural resources are discovered during construction activities:

Skamania County Community Development Department
File: NSA-09-05 (Eastwick) Administrative Decision
Page 3

- a) **Halt Construction.** All construction activities within 100 feet of the discovered cultural resource shall cease. The cultural resources shall remain as found; further disturbance is prohibited.
 - b) **Notification.** The project applicant shall notify the Administrator and the Gorge Commission within twenty-four (24) hours of the discovery. If the cultural resources are prehistoric or otherwise associated with Native Americans, the project applicant shall also notify the Indian tribal governments within twenty-four (24) hours.
 - c) **Survey and Evaluations.** The Gorge Commission shall survey the cultural resources after obtaining written permission from the landowner and appropriate permits from the DAHP. (See Revised Code of Washington 27.53) It shall gather enough information to evaluate the significance of the cultural resources. The survey and evaluation shall be documented in a report that generally follows the provisions in Section 22.22.030 of this Chapter. Based upon the survey and evaluation report and any written comments, the Administrator shall make a final decision on whether the resources are significant. Construction activities may recommence if the cultural resources are not significant.
 - d) **Mitigation Plan.** Mitigation plans shall be prepared according to the information, consultation and report provisions contained in Section 22.22.050 of this Chapter. Construction activities may recommence when conditions in the mitigation plan have been executed.
- 6) The following procedures shall be effected when human remains are discovered during a cultural resource survey or during construction. Human remains means articulated or disarticulated human skeletal remains, bones or teeth, with or without attendant burial artifacts.
- a) **Halt of Activities.** All survey, excavation and construction activities shall cease.
 - b) **Notification.** Local law enforcement officials, the Administrator, the Gorge Commission, and the Indian tribal governments shall be contacted immediately.
 - c) **Inspection.** The county coroner, or appropriate official, shall inspect the remains at the project site and determine if they are prehistoric/ historic or modern. Representatives of the Indian tribal governments shall be contacted immediately and have an opportunity to monitor the inspection.
 - d) **Jurisdiction.** If the remains are modern, the appropriate law enforcement official shall assume jurisdiction and the cultural resource protection process may conclude.

Skamania County Community Development Department
File: NSA-09-05 (Eastwick) Administrative Decision
Page 4

- e) Treatment. The procedures set out in RCW 27.44 and 68.05 shall generally be implemented if the remains are prehistoric/ historic. If human remains will be reinterred or preserved in their original position, a mitigation plan shall be prepared in accordance with the consultation and report requirements set out in Section 22.22.050 of this Chapter. The mitigation plan shall accommodate the cultural and religious concerns of Native Americans. The cultural resource protection process may conclude when conditions set forth in Section 22.22.050(C) of this Chapter are met and the mitigation plan is executed.

Dated and Signed this 23rd day of March, 2009, at Stevenson, Washington.

Jessica Davenport, Associate Planner
Skamania County Community Development Department

NOTES

Any new residential development, related accessory structures such as garages or workshops, fences, and additions or alterations not included in this approved site plan, will require a new application and review.

As per SCC §22.06.150(A), this Administrative Decision approving a proposed development action shall become void in two years if the development is not commenced within that period, or when the development action is discontinued for any reason for one continuous year or more.

APPEALS

The Director reserves the right to provide additional comment and findings of fact regarding this decision, if appealed.

This Administrative Decision shall be final unless reversed or modified on appeal. A written Notice of Appeal form must be filed by an interested person within 20 days from the date hereof. Appeals are to be made to the Skamania County Hearing Examiner, P.O. Box 790, Stevenson, WA 98648. Notice of Appeal forms and mailing lists are available at the Community Development Department and must be accompanied by a \$500.00 nonrefundable-filing fee and a Certificate of Mailing.

WARNING

On November 30, 1998 the Columbia River Gorge Commission overturned a Skamania County Director's Decision 18 months after the 20 day appeal period had expired. You are hereby warned

Skamania County Community Development Department
File: NSA-09-05 (Eastwick) Administrative Decision
Page 5

that you are proceeding at your own risk and Skamania County will not be liable for any damages you incur in reliance upon your Administrative Decision or any amendments thereto.

A copy of the Decision was sent to the following:

Skamania County Building Division

A copy of this Decision, including the Staff Report, was sent to the following:

Adjacent property owners within 500 feet
Yakama Indian Nation
Confederated Tribes of the Umatilla Indian Reservation
Confederated Tribes of the Warm Springs
Nez Perce Tribe
Cowlitz Tribe
Department of Archaeology and Historic Preservation
Columbia River Gorge Commission
U.S. Forest Service - NSA Office
Board of County Commissioners
State of Washington Department of Community Trade and Economic Development – Valerie Grigg
Devis
Department of Fish and Wildlife

Legal Description:

Skamania County Assessor's Tax Parcel No. 03101900030200

Lots 3 and 4, SEELEY SUBDIVISION, recorded in Skamania County, Washington, Volume "A" of Plats, page 32;

The Southwest quarter of the Southeast quarter of the Northwest quarter;

All that portion of the Southeast quarter of the Southeast quarter of the Northwest quarter of Section 19 and the South half of the North half of the Southeast quarter of the Northwest quarter of Section 19, West of a line that starts at the intersection of Kollock-Knapp Road and Ausplund Road; thence North along the centerline of Ausplund Road, 500 feet; thence perpendicular and East of said centerline an offset of 80 feet for the length of 400 feet; thence returning perpendicular to said centerline and continuing North along said centerline to the North line of said South half of the North half of the Southeast quarter of the Northwest quarter of Section 19.

EXCEPTING the West half of the West half of the West half of the Southeast quarter of the Northwest quarter of Section 19.

Applicant: Eastwick
 Location: Skamania County
 West of Ausplund Rd and Kollock-
 Knapp Rd intersection
 32 total acres: 25 to be fenced.
 Elevation: 1400-1500ft.

Note: Non-Vineyard land
 within fenced area is all Pear Orchard.

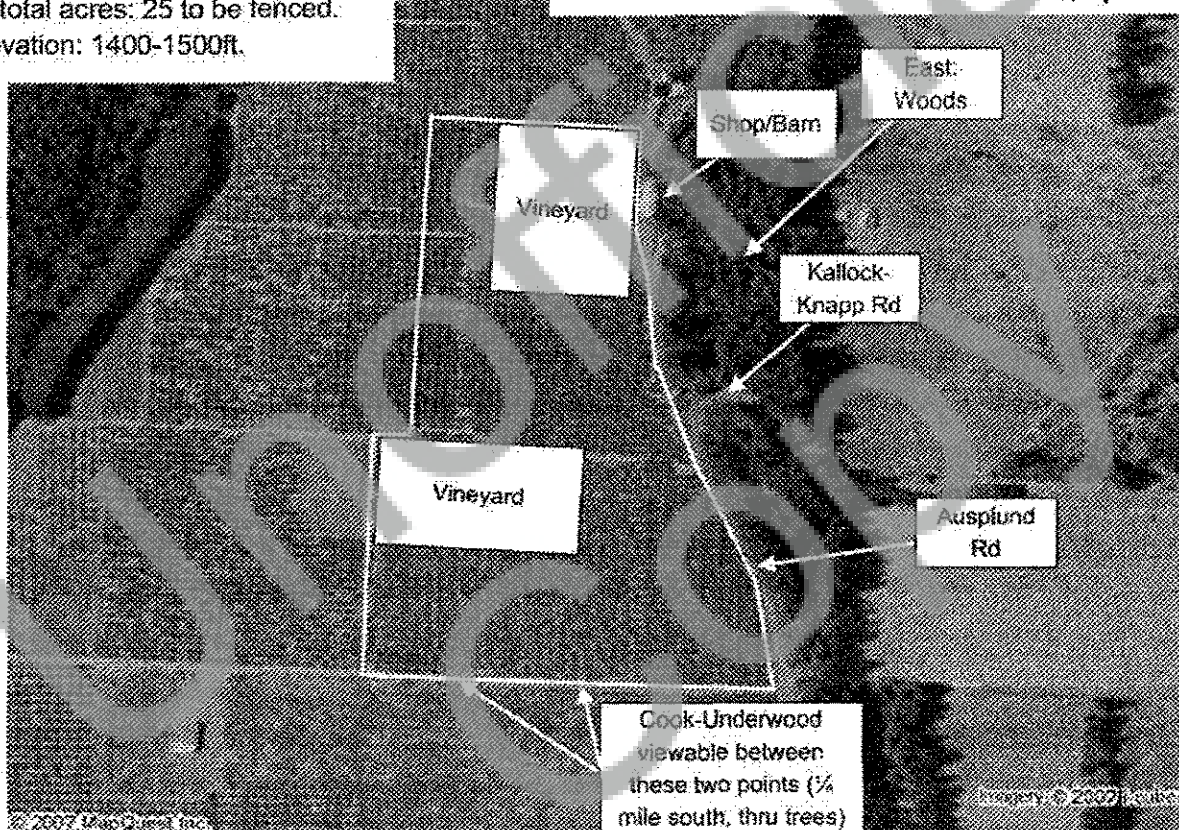

Fence Length (Scale) is as follows:

North Border = 603 ft.

East Border = approx 1660ft.

South Border = 1004 ft.

West Border = 1645 ft.