

Return Address:

Karen Anderson  
878 S.W. Chehalis AVE.  
Chehalis, WA. 98532

## NOTICE OF LOCATION OF PLACER CLAIM

Indexing information required by the Washington State Auditor's/Recorder's Office, (RCW 36.18 and RCW 65.04) 1/97:		(please print last name first)
Reference # (If applicable):	<u>N/A</u>	
Grantor(s) (Claimant): (1)	<u>Karen Anderson</u>	(2) Addl.' on pg. _____
Grantee(s): (1)	_____	(2) _____
Addl.' on pg. _____	Legal Description (abbreviated): <u>S10-T10N-R8E/ N1/2 of the SW 1/4 of the NW 1/4</u>	
Addl.' legal is on pg. _____	Assessor's Property Tax Parcel /Account # <u>N/A</u>	

Notice is hereby given that the undersigned, who is a/are (or ha declared \_\_\_\_\_ intention to become) citizen(s) of the United States, has on this 2~~nd~~ day of mar., 2009, discovered at the place where this notice is posted a valuable placer deposit bearing Gold + and other valuable minerals, and does hereby locate and claim same as the G.I. + S. MINE # 2.

Placer Mining Claim.

This claim is situated in the COWITZ VALLEY BENILLE  
Mining District, Section 10, in Township 10 N,  
Range 8 E.

The point of discovery whereon this notice is posted is situated OFF OF RD. 29 APPROX.  
7-8 mi. to Rd. 84 To McCoy CR.

and from thence the boundaries of said claim are marked and described as follows:

SEE MAP: N1/2 of the SW 1/4 of the NW 1/4



Notice dated and posted on the day aforesaid.

Discovered MAR. 2<sup>ST</sup>, 2009

Karen Anderson  
Locator(s)

Located MAR. 2<sup>SEC</sup>, 2009

Notice of location must be recorded within thirty (30) days from the date of discovery at the office of the auditor of the county in which such discovery was made. Twenty (20) Acres may be included in one placer claim and if located on surveyed land it must be according to legal subdivisions.

Care must be taken to fully describe the claim with reference to natural objects and permanent monuments or survey description, so that the boundaries can be readily traced. *The blank spaces in this form must be carefully and properly filled out.*

The discoverer must perform labor upon such location in developing the same to an amount which shall be equivalent in the aggregate to at least \$10.00 worth of such labor for each twenty (20) acres, or fractional part thereof, contained in such location or claim, within sixty (60) days from the date of discovery, and upon performance of such labor, file with the auditor of county an affidavit showing such performance and generally the nature and kind of work so done. Provided however, that certain federal regulations may apply, in addition or in place of the above.

STATE OF WASHINGTON,

County of SKAMANIA

ss

(INDIVIDUAL ACKNOWLEDGMENT)

I, Karen Anderson, do solemnly swear that I am a citizen of the United States of America (or have declared my intention to become such) and that I am acquainted with the mining ground described in the notice of location, and herein called the C.T. & S mine # 2 Placer Mining Claim; that the ground and claim herein described, or any part thereof, has not, to the best of my knowledge and belief, been located according to the laws of the United States and this State, or if so located, that the same has been abandoned or forfeited by reason of failure of such former locators to comply in respect thereto with the requirements of said laws; and that I have performed the equivalent of at least \$10.00 in labor on such claim and have complied with all applicable laws of this State pertaining to this claim.

Karen Anderson

Signed and sworn to before me this 23<sup>rd</sup> day of March, 2009.

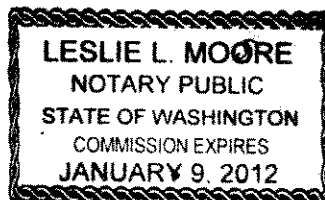

Leslie L Moore  
Print Name Leslie L Moore  
Notary Public in and for the State of Washington  
My appointment expires: 1-9-2012

Signature of Claimant Karen Anderson date 3-2-09

## MAP of Mining Claim(s)

Township 10 N Range 8 E Section 10 State of WASH.

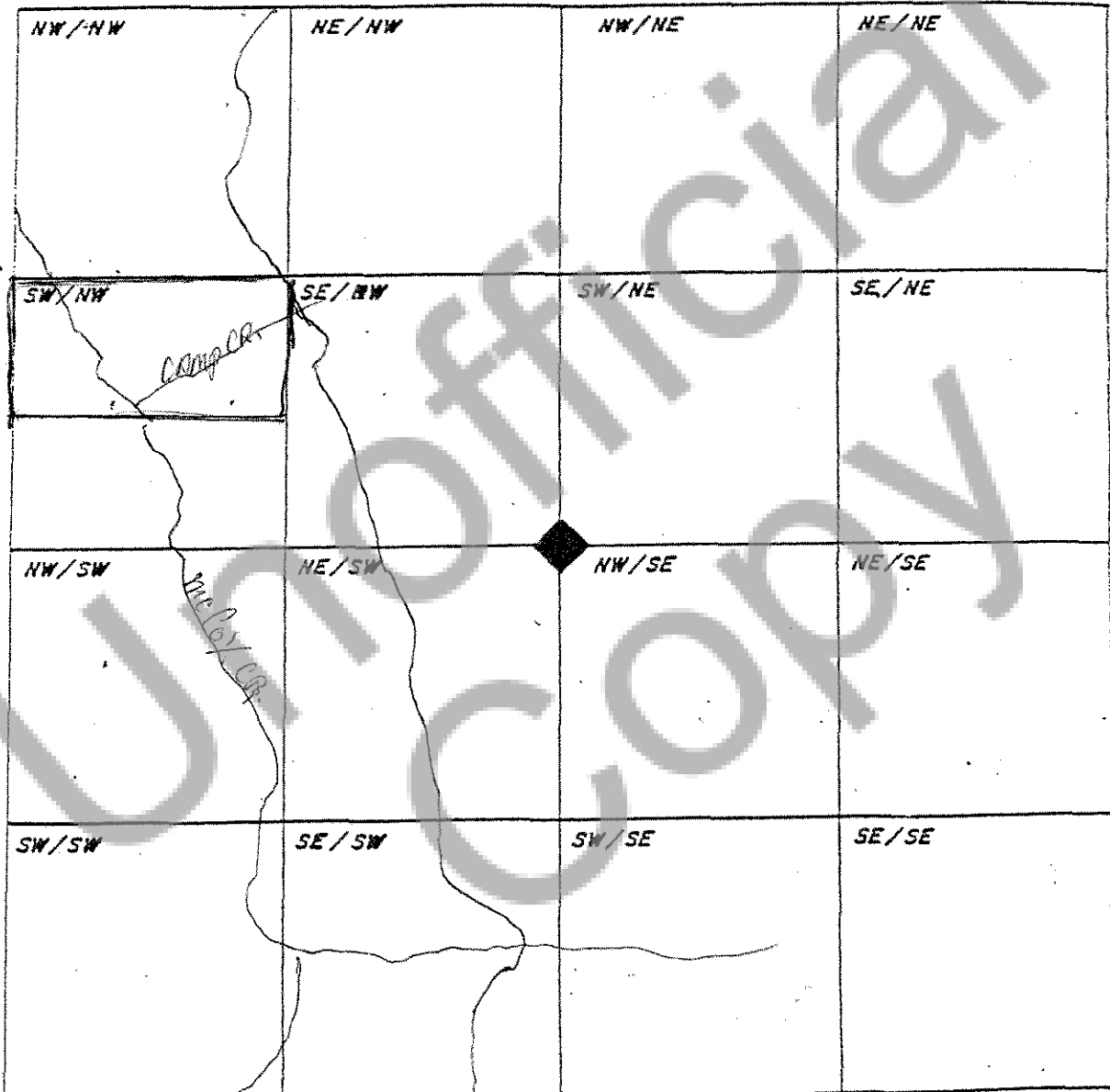

When drawing your claim(s) use an ordinary ruler. 1/8th of an inch would be 100 feet so a full size lode (600' x 1500') would be 3/4" by 1 7/8". A full size placer (1320' x 660') would be 1 5/8" by 13/16".