

LINE TABLE		
LINE	BEARING	DISTANCE
L1	S37°55'49"W	8.00
L2	N35°18'50"E	8.98
L3	N35°18'50"E	15.00
L4	N44°18'50"E	18.94

DEED HELD
DEED HELD

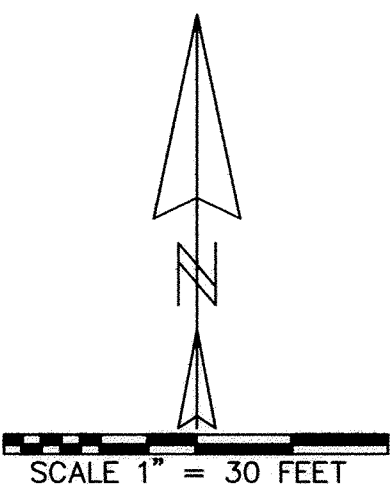

LEGEND

- SET 1/2" X 30" IRON ROD WITH YELLOW PLASTIC CAP MARKED "WYEAST PLS 29288"
- FOUND IRON ROD AS PER REFERENCE 2
- FOUND MONUMENT AS NOTED
- CALCULATED POSITION

REFERENCES

- 1) PLAT OF ROSELAWN EXTENSION
- 2) BOOK 2 OF SURVEYS, PAGE 218
- 3) BOOK 3 OF SURVEYS, PAGE 391

LEGAL DESCRIPTION

AF# 2008170626

THIS SURVEY WAS CONDUCTED DURING JUNE THROUGH DECEMBER 2008 BY CLOSED LOOP TRAVERSE USING A 3" TOTAL STATION AND RELATED EQUIPMENT. A LEAST SQUARES ADJUSTMENT OF THE RAW TRAVERSE DATA WAS PERFORMED. THIS SURVEY MEETS THE MINIMUM STANDARDS FOR SURVEYS AS PER WAC 332-130-090.

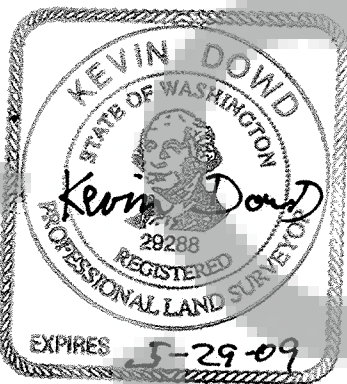

SURVEYOR'S CERTIFICATE

THIS MAP CORRECTLY REPRESENTS A SURVEY MADE BY ME OR UNDER MY DIRECTION IN CONFORMANCE WITH THE REQUIREMENTS OF THE SURVEY RECORDING ACT AT THE REQUEST OF BRIAN ADAMS

Kevin Dowd 12-31-08
KEVIN DOWD PLS 29288

RECORD OF SURVEY

LOTS 2, 3, 4, 5, 6 AND A PORTION OF LOT 7
BLOCK 3
ROSELAWN EXTENSION
LOCATED IN THE SOUTHEAST QUARTER OF SECTION 36
T3 NORTH, R7 EAST, W.M.
IN THE CITY OF STEVENSON
SKAMANIA COUNTY, WASHINGTON

FOR: BRIAN ADAMS

AUDITOR'S CERTIFICATE

FILED FOR RECORD THIS 3rd DAY OF January
AT 10:53 IN AUDITOR'S FILE NO. 2009171767
AT THE REQUEST OF WYEAST SURVEYS.

J. Michael Garvison by
Melvin Anderson
COUNTY AUDITOR

WYEAST SURVEYS
KEVIN DOWD
4399 WOODWORTH DRIVE
MT HOOD, OR 97041
(541) 352-6065