

WHEN RECORDED RETURN TO:

John G. Lawson
113 S Parkway Ave
Battle Ground, WA 98604

DOCUMENT TITLE(S)

Land Corner Record

REFERENCE NUMBER(S) of Documents assigned or released:

☐ Additional numbers on page _____ of document.

GRANTOR(S):

Lawson Land Services, Inc

☐ Additional names on page _____ of document.

GRANTEE(S):

Public

☐ Additional names on page _____ of document.

LEGAL DESCRIPTION (Abbreviated: i.e. Lot, Block, Plat or Section, Township, Range, Quarter):

☐ Complete legal on page _____ of document.

TAX PARCEL NUMBER(S):

S6, S7, T1N, R5E

☐ Additional parcel numbers on page _____ of document.

The Auditor/Recorder will rely on the information provided on this form. The staff will not read the document to verify the accuracy or completeness of the indexing information.



LAND DEVELOPMENT SERVICES

(206) 256-8008

JOHN G. LAWSON
Registered Professional Land Surveyor
Registered Professional Engineer

EastRidge Business Park
Building 2, Suite 280
11800 N.E. 95th Street
Vancouver, WA 98682

LAND CORNER RECORD

Township 1 North, Range 5 East W.M.; Skamania County; Corner Code No.: E-3

Name: One Quarter Corner Common to Sections 6 & 7 Corner No.: _____

DLC, HES Mining Claim, Indian Allotment, Federal Reserve, Townsite

1. History of Corner Establishment and Subsequent Restoration; description of Evidence found:

This corner was originally set by Lewis Fan Fleet and John Newsome in April 1859, "set a post for quarter Section corner from which a shittim 10" diameter bears South 35 East 16 links distance, a shittim 8" diameter bears North 10 West 5 links distance.

On April 5, 1912 Clark Labarre runs to the South 1 quarter of 6 from the Southeast corner of 6. He doesn't mention what he finds, but it is an established corner that he uses. He mentions in book 22, page 2 in June 11, 1912 that the center line on the County Road is 10 feet East of the quarter corner. Today there is a Skamania County boxed monument approximately 10 feet West of the County roads and in line with the fences and roads going East and West. This indicates that it's probably perpetuation of the corner used by Labarre in 1912.

Due to the lack of any contradictory evidence, the fact this corner appears to been in place for the last 70 years, and is in a logical position, we accept it as the best evidence of the original corner of the South 1 quarter corner of Section 6.

2. Describe Monument, Accessories and Corollary Data to Perpetuate this Corner Location. Diagram corner and indicate meridian and reference to map of record.

LAWSON LAND SURVEYING job # 90-89-010104 Date of Work: September 23, 1991

Fd 1" iron pipe with brass cap in dirt with case and cover, and referenced as follows:

- 1) N 77° W, 13.95' to a 12" dia. power pole (no number on pole).
- 2) N 47° E, 116.60' to a 12" dia. light pole.
- 3) S 38° E, 32.35' to a underground telephone box, #1767.

Washington Plane Coordinates: _____ Zone, Y _____, X _____ Order of Accuracy.

Derived from: _____

Pin pointed on photo # _____ Date: _____ Located at: _____

SURVEYOR'S CERTIFICATE

This corner record correctly represents work performed by me or under my direction in compliance with the provisions of Chapter 50, Laws of 1973.

Signature: John G. Lawson

Date: 12/13/91 Certificate No.: 11989

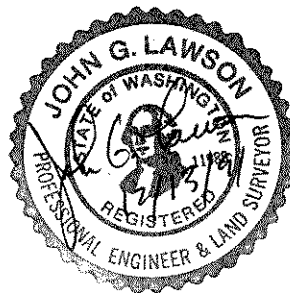

AUDITOR'S CERTIFICATE

Filed for record this _____ day of _____, 1991 at _____ M.

In Book _____ of _____, at page _____ at the request of _____.

County Auditor