

WHEN RECORDED RETURN TO:

John G. Lawson
113 S. Parkway Ave
Battle Ground, WA 98604

DOCUMENT TITLE(S)

Land Corner Record

REFERENCE NUMBER(S) of Documents assigned or released:

☐ Additional numbers on page _____ of document.

GRANTOR(S):

Lawson Land Services, Inc

☐ Additional names on page _____ of document.

GRANTEE(S):

Public

☐ Additional names on page _____ of document.

LEGAL DESCRIPTION (Abbreviated: i.e. Lot, Block, Plat or Section, Township, Range, Quarter):

☐ Complete legal on page _____ of document.

TAX PARCEL NUMBER(S):

S5, S6, T1N, R5E.

☒ Additional parcel numbers on page 2 of document.

The Auditor/Recorder will rely on the information provided on this form. The staff will not read the document to verify the accuracy or completeness of the indexing information.



LAND DEVELOPMENT SERVICES

(206) 256-8008

JOHN G. LAWSON
Registered Professional Land Surveyor
Registered Professional Engineer

EastRidge Business Park
Building 2, Suite 280
11800 N.E. 95th Street
Vancouver, WA 98682

LAND CORNER RECORD

Township 1 North, Range 5 East W.M.; Skamania County; Corner Code No.: A-5 & Z-5

Name: **Corner Common to Sections 5 & 6 T1N, R5E, & 31 & 32 T2N, R5E.** Corner No.: _____
DLC, HES Mining Claim, Indian Allotment, Federal Reserve, Townsite

1. History of Corner Establishment and Subsequent Restoration; description of Evidence found:

Van Fleet and Newsome surveyed the North boundary of Township 1 North, Range 5 East in April 1859 under contract No. 47. For this corner they know the following (set a post for corner to Section 5 to 6, 31 and 32 from which a first 6" diameter bears North 62 on East and an alder 8" diameter bears 71 East 112 links distance. A maple 8" Diameter bears South 32 West, 39 links distance. A fir 36" diameter bears North 55 West, 96 links distance.

There is an iron pipe with Skamania County brass cap at a position that appears to have been set where Clark Labarre said in April 1912. He did not find this corner and established it as in book 6, page 65 "THENCE I set stake for corner 40 chains South of a quarter corner on West line of Section 32 and 80 chains West of the Northeast corner of Section 4, Township 1 North, Range 5 East." He used some stadia to shoot across the river which may allow for a slight discrepancy in his 80 chains distance to the East. The North distance to a fence corner where the Fish & Game Department set a concrete monument is within a couple feet of 40 chains. This position of the Skamania County iron pipe of the brass cap does not fit any of the river calls and does not reasonably fit the easting or northing from any of the adjacent corners. I thereby declare this corner lost and re-established it by proportionate measurement along the Township line. If you run West from the Skamania County corner you miss the river call entirely to the West. The proportionate position fits the river call very well.

So we proportioned this corner from the "line tree" at 50.75 chains per the GLO notes and the Section corner at Northeast corner Section 5, Township 1 North, Range 5 East. The Southeast distance of Southeast corner of Section 6 and the proportion for the Northeast of Section 6 is within 10 feet of the original GLO surveyed distance i.e. 5297.82 GLO verses GLO 5307.53 proportion.

2. Describe Monument, Accessories and Corollary Data to Perpetuate this Corner Location. Diagram corner and indicate meridian and reference to map of record.

LAWSON LAND SURVEYING job # 90-89-06

Date of Work: September 23, 1991

Corner not set. Fell in existing house. Found the following monuments:

- 1) N 18°E, 140.40' to a 1½" iron pipe with a brass cap stamped: "Skamania County, Penalty for Moving, \$250 Fine, Engineers Department."
- 2) N 89°W, 817.04' to a brass screw set in concrete, set by Hagedorn (unrecorded).

Washington Plane Coordinates: _____ Zone, Y _____, X _____ Order of Accuracy.

Derived from: _____

Pin pointed on photo # _____ Date: _____ Located at: _____

SURVEYOR'S CERTIFICATE

This corner record correctly represents work performed by me or under my direction in compliance with the provisions of Chapter 50, Laws of 1973.

Signature: John G. Lawson

Date: 12/13/91 Certificate No.: WA11989

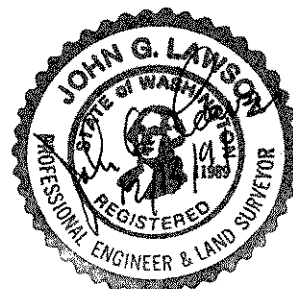

AUDITOR'S CERTIFICATE

Filed for record this _____ day of _____, 1991 at _____ M.
In Book _____ of _____, at page _____ at the request of _____.

County Auditor