

SURVEY

in the NW 1/4 SW 1/4 and
the SW 1/4 SW 1/4 of
SECTION 27, T2N, R5E, W.M.
SKAMANIA COUNTY, WA.

POSITION OF 3" SKAMANIA COUNTY
BRASS CAP IN MOUND OF
STONES AS SHOWN IN
R.O.S. 3-231.
(TIED MARCH, 1996)

DEED REFERENCE

WARRANTY DEED
DENNIS AND MARILYN CLARK
TO
JSC FAMILY, LLC
AFN 2008169241 (3/13/2008)

C-W 1/16
POSITION OF 5/8" I.R.
WITH YPC STAMPED
"SINES 31454" AS
SHOWN IN R.O.S. 3-231

R.O.S. 3-231

JSC FAMILY, LLC
AFN 2008169241

SEE R.O.S. 3-231 FOR TIMBER
AND CLEARING TRESPASS
IN THIS AREA

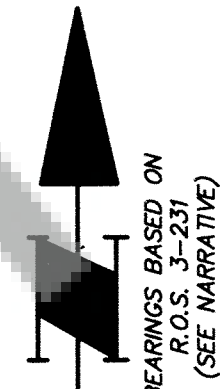

LEGEND

- MONUMENT AS SHOWN
 - ⊙ SET 5/8" x 30" IRON REBAR WITH ORANGE PLASTIC CAP STAMPED "BROWN 42425" WITH STEEL FENCE POST SET ALONGSIDE
 - ⊠ STEEL FENCE POST SET ON LINE, DISTANCE TO NEAREST FOOT
- R.O.S. = RECORD OF SURVEY
()¹ RECORD DATA PER R.O.S. 2-212
()² RECORD DATA PER R.O.S. 3-231
AFN = AUDITOR'S FILE NUMBER
I.P. = IRON PIPE
I.R. = IRON ROD
⊕ = CENTERLINE
YPC = YELLOW PLASTIC CAP

JSC FAMILY, LLC
AFN 2008169241

CLARK
REMAINDER
PORTION OF
AFN BK 226, PG 567

POSITION OF 1/2" I.R.
WITH YPC STAMPED
"SINES 31454" AS
SHOWN IN R.O.S. 3-231

POSITION OF 1/2" I.R.
WITH YPC STAMPED
"SINES 31454" AS
SHOWN IN R.O.S. 3-231

WASHOUGAL
RIVER ROAD

Δ = 25°38'53"
(R = 284.10')²
L = 127.18'

WEST 1/16:
POSITION OF 5/8" I.R.
WITH YPC STAMPED
"SINES 31454" AS
SHOWN IN R.O.S. 3-231

POSITION OF 3/4" I.P. WITH
YPC STAMPED "OLSON 9025"
AS SHOWN IN R.O.S. 3-231.
(TIED JULY, 1995)

SURVEYOR'S CERTIFICATE

This map correctly represents a survey made by me or under my direction in conformance with the requirements of the Survey Recording Act at the request of DICK EASTER in MARCH, 2008

GREGORY ALAN BROWN
PROFESSIONAL LAND SURVEYOR

42425
CERTIFICATE NO.

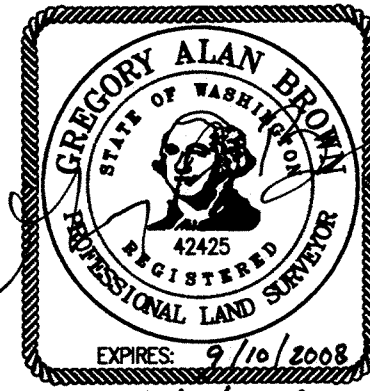

AUDITOR'S CERTIFICATE

Filed for record this 12 day of June, 20 08
at 2:02p m. under AF# 2008170153 at the
request of Hagedorn, Inc.

(Signed) Melinda
(Deputy County Auditor)

NARRATIVE

THE PURPOSE OF THIS SURVEY WAS TO MONUMENT THE "JSC FAMILY LLC TRACT" CITED. A RANDOM CONTROL TRAVERSE WAS RUN FROM EXISTING TRAVERSE POINTS SET IN ROS 3-231 TO THE BRASS CAP MARKING THE SOUTH 1/16 AS SHOWN IN ROS 2-212. THIS TRAVERSE WAS ORIENTED TO THE MATHEMATICAL MODEL OF ROS 3-231 AND THE CALCULATED POSITION OF THE BRASS CAP AT THE SOUTH 1/16. NEW MONUMENTS ESTABLISHED WERE SET RADIALLY FROM THE ABOVE DESCRIBED TRAVERSE WHICH MET THE REQUIREMENTS OF WAC 332-130-090. FIELD EQUIPMENT USED CONSISTED OF A 3-SECOND "TOTAL STATION INSTRUMENT" WITH ELECTRONIC DATA COLLECTOR.

NOTE: Hagedorn, Inc. makes no warranties as to matters of unwritten title such as acquiescence, estoppel, adverse possession, etc.

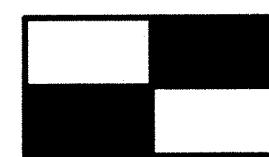

HAGEDORN, INC.
Surveying and Engineering

1924 Broadway Vancouver, Wa. 98663
Ph: (360) 696-4428

SCALE: 1"=200'
DATE: 6/05/08
JOB NO.: 07-249

CALC. BY: GAB
DRAWN BY: CC
CHECKED BY: CEW

DWG# 07-249
SHEET 1 OF 1