

Return Address: Janet Wainwright
4001 SW Cloverdale St.
Seattle, WA 98136

**Skamania County
Department of Planning and
Community Development**

Skamania County Courthouse Annex
Post Office Box 790
Stevenson, Washington 98648
509 427-3900 FAX 509 427-3907

Letter Amendment to Administrative Decision NSA-05-56-L1

APPLICANT: Janet Wainwright

OWNER: Janet Wainwright

FILE NO.: Amendment to NSA-05-56

REFERENCE NO.: Administrative Decision for NSA-05-56, recorded as Auditor's File # 2007165405, recorded on the 23rd day of March 2007, in the Skamania County Auditor's Office.

PROJECT: To construct a single-family dwelling approximately (40' x 30' x 28') with an attached carport (approximately 18' x 16') on the north side and 8' deck on the west, south and east sides, and a separate covered shed/ horse stable (approximately 20' x 15' x 12'), and associated utilities.

LOCATION: Located on Tucker Road South, Skamania, WA, Section 27 of T2N, R6E, W.M. and identified as Skamania County Tax Lot #02-06-27-3-0-0104-00.

LEGAL: See attached page 4

ZONING: General Management Area – Residential (R-10).

May 1, 2008

Dear Ms. Wainwright,

Amendment NSA-05-56 (Wainwright)

Page 2

The Planning Department issued a final Administrative Decision on July 14, 2006 for the above referenced application. On April 29, 2008 we received a letter from you requesting to decrease the size of the approved house, remove the carport, and to change the location of the well. The house was originally proposed and approved to be 30' x 40' x 28' (height), you have now proposed to decrease the size of the house to be 24' x 34' x 28' (height). You have also indicated that you will no longer be constructing the approved carport. The well was originally proposed and approved on the west side of the driveway south of the pond. The well was approved by the Health Department and successfully drilled in a different location which is south of the proposed house.

Pursuant to SCC §22.06.080(B), a change or alteration to an approved action, if determined to be minor by the Director, may be "deemed consistent with the provisions of this Title and the findings and conclusions on the original application." The proposed request constitutes a minor change; therefore, the original decision shall be amended as stated above.

The site plan (see attached page 2) to this Letter Amendment shall replace those attached to your original Administrative Decision of July 14, 2006, and shall be known as the grading plan and site plan. The amendment is hereby approved.

All of the original conditions in the Administrative Decision are still valid and shall be complied with. As a reminder, **this letter amendment needs to be recorded at the County Auditor's office**, as was your Administrative Decision. If you have any questions, please give me a call at 509-427-3900.

Sincerely,

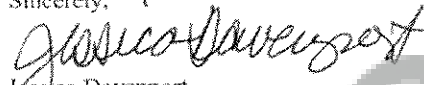
Jessica Davenport
Associate Planner

APPEALS

The Director reserves the right to provide additional comment and findings of fact regarding this decision, if appealed.

This Letter Amendment Decision shall be final unless reversed or modified on appeal. A written Notice of Appeal form must be filed by an interested person within 20 days from the date hereof. Appeals are to be made to the Skamania County Hearing Examiner, P.O. Box 790, Stevenson, WA 98648. Notice of Appeal forms are available at the Planning Department Office and must be accompanied by a \$500.00 nonrefundable filing fee.

WARNING

On November 30, 1998 the Columbia River Gorge Commission overturned a Skamania County Director's Decision 18 months after the 20-day appeal period had expired. You are hereby warned that you are proceeding at your own risk and Skamania County will not be liable for any damages you incur in reliance upon your Director's Decision or any amendments thereto.

Amendment NSA-05-56 (Wainwright)
Page 3

cc: Skamania County Building Division
Skamania County Health Dept.
Persons w/in 500 feet
Yakama Indian Nation
Confederated Tribes of the Umatilla Indian Reservation
Confederated Tribes of the Warm Springs
Nez Perce Tribe
Cowlitz Indian Tribe
Columbia River Gorge Commission
U.S. Forest Service - NSA Office
Board of County Commissioners
Friends of the Columbia Gorge
Department of Archaeology and Historic Preservation
Washington Department of Community Development - Dee Caputo

Attached: Letter request for Amendment
Vicinity Map
Site Plan

EXHIBIT 'A'

Beginning at the Southwest corner of the Southwest Quarter of Section 27, Township 2 North, Range 6 East of the Willamette Meridian, Skamania County, Washington; thence North 01°05'09" East as measured along the West line of said Southwest Quarter 757.95 feet; thence South 88°55'59" West 652.93 feet to the centerline of Road "A"; thence Northerly along the centerline of Road "A" to the intersection of the centerline of Road "A" and Road "C", said point being North 01°05'09" East 1,293.63 feet and South 88°55'59" East 1,083.75 feet from the Southwest corner of said Southwest Quarter; thence North 34°04'03" West 126.16 feet to the beginning of a 100 foot radius curve to the left; thence along said curve 118.56 feet; thence South 78°00'11" West 24.87 feet to the True Point of Beginning; thence continuing South 78°00'11" West 121.89 feet to the beginning of a 100 foot curve to the left; thence along said curve 60.54 feet; thence South 43°18'55" West 95.63 feet to the beginning of a 50 foot radius curve to the right; thence along said curve 47.14 feet; thence North 31°20'43" West 318.61 feet; thence North 01°05'09" East 689.64 feet; thence South 89°08'43" West 499.50 feet; thence South 01°05'09" West 360.08 feet; thence South 46°05'08" West, 141.42 feet; thence South 43°54'51" East 141.42 feet; thence South 01°05'09" West 302.30 feet to the centerline of Road "C" and the True Point of Beginning.

The centerlines of Roads "A", "B" and "C" are more particularly described in a real estate contract dated April 30, 1975 and recorded in Book 70 of Deeds, Pages 13 and 14, Auditor File No. 81400, records of Skamania County, Washington.

ALSO known as Lot 4 of Survey recorded in Book 1, Page 82, Skamania County Records.

TOGETHER WITH easements 60 feet in width for Roads "A", "B" and "C" as more particularly described in real estate contract dated April 30, 1975 and recorded in Book 70 of Deeds, Pages 13 and 14, records of Skamania County, Washington.

April 25, 2008

Ms. Jessica Davenport
Skamania County Planning Department
170 NW Vancouver Avenue
Stevenson, WA. 98648

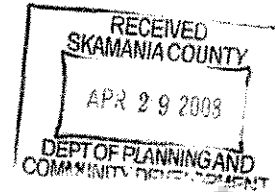

Dear Ms. Davenport:

Thank you for your call. Here is the revised site plan. You will note a few differences:

The home is now 24' X 34' rather than 30' X 40'

There is no longer a carport.

The septic has been sited and approved by the health department.

The well has been successfully drilled and approved by the health department and is in a different location.

Some of the trees that were approved for removal have been removed. Others have not been removed at this point.

Please let me know if you need any other information.

Sincerely,

Janet Wainwright
(206) 854-4391

Via fax to O & S and mailed on 4/21/08

4-30-08 ✓ came in for LA - receipt # 005310
NSA-05-56-L1

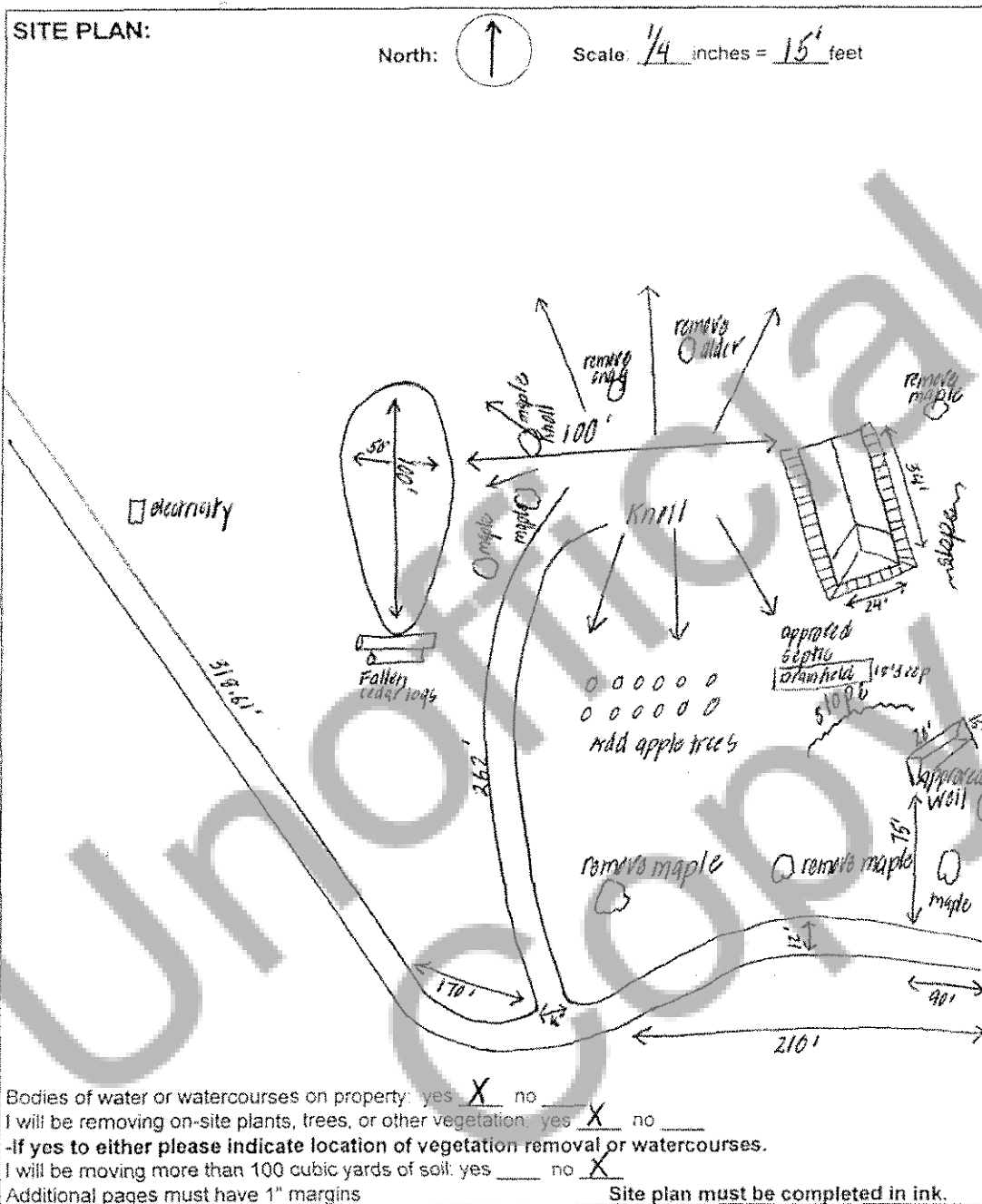

NOTICE: This is a proposed site plan, it may be revised as required to be in compliance with the Columbia River Gorge National Scenic Area.

2-6-27-3

