

IN A PORTION OF

NARRATIVE

THE PURPOSE OF THIS SURVEY IS MARK THE BOUNDARY LINES OF THE CLARK TRACT OF LAND AS DESCRIBED IN AUDITORS FILE NUMBER 2007168017, RECORDS OF SKAMANIA COUNTY, WASHINGTON, A MODEL WAS COMPUTED USING REMNOLD SURVEY BOOK 1, PAGE 201, SHORT PLAT BOOK 2, PAGE 102 AND ADJACENT PROPERTY DEEDS. THE MODEL FIT FOUND MONUMENTATION PER SAID REMNOLD SURVEY. THE CLARK DEED DESCRIPTION (AUDITORS FILE NUMBER 2007168017) MATCHED THE COMPUTED MODEL EXCEPT ALONG THE WEST LINE AND AT THE SOUTHWEST PORTION OF THE PROPERTY AT THE CUL-DE-SAC AREA.

ALL BOUNDARY LINES WERE ESTABLISHED BY HOLDING FOUND MONUMENTATION PER REMNOLD SURVEY BOOK 1, PAGE 201. AUDITORS FILE NUMBER 2007168017 CREATES A DEED GAP AT THE CULDE-SAC AREA AS SHOWN.

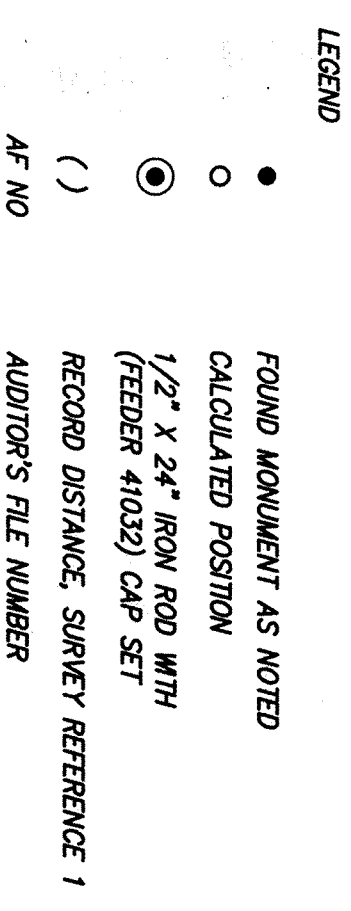

THIS MAP CORRECTLY REPRESENTS AN ACTUAL SURVEY MADE BY ME OR UNDER MY DIRECTION IN CONFORMANCE WITH THE REQUIREMENTS OF THE SURVEY RECORDING ACT AT THE REQUEST OF CHRIS CLARK IN JUNE, 2007.

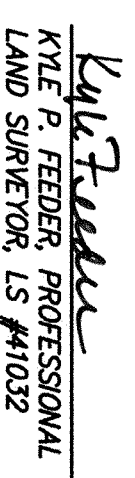

SCALE: 1"=50'

SCALE: 1"=50'

JOB NO.: 07-030

CALC BY: *KPF*

DRAWN BY: *GLF*

CHECKED BY: KPF

SHEET 1 OF 1

SURVEYING, INC.

1514 N.E. 267TH AVE CAMAS, WA 98607

360-834-0174 FAX: 360-838-0155

360-834-0174 FAX: 360-838-0155