

**AFTER RECORDING MAIL TO:**

Name Ila Richards  
Address 1601 mabee mines Rd  
City / State Washougal WA. 98671

**Quit Claim Deed**

Dale Archie Richards and Ila Mae Richards

THE GRANTOR

Richards as Trustees, or their successors  
in trust of the Dale Archie Richards and Ila Mae  
Richards Family Trust, dated January 20, 2000  
for and in consideration of None

Dale Archie Richards and Ila Mae Richards  
conveys and quit claims to

as trustees, or their successors in trust  
of the Dale Archie Richards and Ila Mae  
Richards Family Trust, dated January 20, 2000  
the following described real estate, situated in the County of Skamania

together with all after acquired title of the grantor(s) therein:

Sec. 35 Township 2 north range 5 east

**REAL ESTATE EXCISE TAX**

Full legal on page 3

17473  
FEB 21 2008

PAID EXEMPT  
Shirley Fekini Deputy  
SKAMANIA COUNTY TREASURER

Assessor's Property Tax Parcel/Account Number(s): 02-05-35-00-0500-00  
C.S.

Dated 2-19, 2008

Dale A. Richards

(Individual)

Ila M. Richards

(Individual)

By \_\_\_\_\_

(President)

By \_\_\_\_\_

(Secretary)

STATE OF Washington }  
County of Skamania } ss.

ACKNOWLEDGMENT - Individual

On this day personally appeared before me Dale Richards &  
ILA Richards to me known  
to be the individual(s) described in and who executed the within and foregoing instrument, and acknowledged that they  
signed the same as their free and voluntary act and deed, for the uses and purposes therein mentioned.

GIVEN under my hand and official seal this 12 day of December, 2007

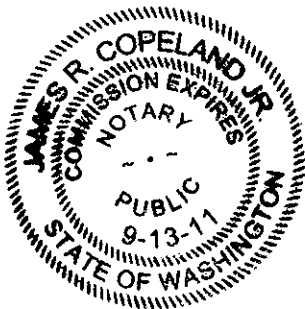

[Signature]  
Notary Public in and for the State of  
residing at Steverson

My appointment expires 9-13-2011

STATE OF WASHINGTON, }  
County of \_\_\_\_\_ } ss.

ACKNOWLEDGMENT - Corporate

On this \_\_\_\_\_ day of \_\_\_\_\_, 19\_\_\_\_, before me, the undersigned, a Notary Public in and for the State of  
Washington, duly commissioned and sworn, personally appeared \_\_\_\_\_  
and \_\_\_\_\_ to me known to be the  
\_\_\_\_\_ President and \_\_\_\_\_ Secretary, respectively, of \_\_\_\_\_  
the corporation that executed the foregoing instrument, and acknowledged the said instrument to be the free and voluntary  
act and deed of said corporation, for the uses and purposes therein mentioned, and on oath stated that \_\_\_\_\_  
authorized to execute the said instrument and that the seal affixed (if any) is the corporate seal of said corporation.

Witness my hand and official seal hereto affixed the day and year first above written.

\_\_\_\_\_  
Notary Public in and for the State of Washington,  
residing at \_\_\_\_\_

My appointment expires \_\_\_\_\_

WA-46A (11/96)

This jurat is page \_\_\_\_\_ of \_\_\_\_\_ and is attached to \_\_\_\_\_ dated \_\_\_\_\_.



# HAGEDORN, INC.

## SURVEYORS AND ENGINEERS

1924 Broadway, Suite B • Vancouver, WA 98663 • (360) 696-4428 • (866) 696-4428 • Fax: (360) 694-8934 • www.hagedornse.com

November 30, 2007

### LEGAL DESCRIPTION FOR SUSIE RICHARDS

#### **PROPOSED 20 ACRES TO BE SEGREGATED FROM THE "RICHARDS TRACT":**

A portion of the Southwest quarter of the Northwest quarter and the Northwest quarter of the Southwest quarter of Section 35, Township 2 North, Range 5 East, Willamette Meridian, Skamania County, Washington, described as follows:

BEGINNING at a 3/4 inch iron pipe marking the quarter corner between Sections 34 and 35, as shown in Book 3 of Surveys, page 140, Skamania County Auditor's Records; thence North  $00^{\circ} 41' 25''$  East, along the West line of the Northwest quarter of Section 35, for a distance of 695.00 feet; thence, leaving said West line, South  $89^{\circ} 01' 23''$  East, parallel with the South line of the Northwest quarter of Section 35, for a distance of 1781.33 feet to the centerline of Mabee Mines Road; thence following the centerline of Mabee Mines Road, along the arc of a 1229.90 foot radius curve to the right, (the radial bearing of which is North  $40^{\circ} 36' 40''$  West), through a central angle of  $6^{\circ} 19' 49''$ , for an arc distance of 135.88 feet; thence South  $55^{\circ} 43' 09''$  West, 245.35 feet; thence along the arc of a 600.00 foot radius curve to the left, through a central angle of  $4^{\circ} 41' 48''$ , for an arc distance of 49.18 feet; thence South  $51^{\circ} 01' 06''$  West, 246.45 feet; thence along the arc of a 390.01 foot radius curve to the right, through a central angle of  $23^{\circ} 39' 59''$ , for an arc distance of 161.10 feet; thence South  $74^{\circ} 43' 16''$  West, 144.97 feet; thence along the arc of a 1470.06 foot radius curve to the right, through a central angle of  $8^{\circ} 57' 59''$ , for an arc distance of 230.05 feet; thence South  $83^{\circ} 35' 18''$  West, 119.01 feet; thence along the arc of a 320.00 foot radius curve to the left, through a central angle of  $20^{\circ} 05' 35''$ , for an arc distance of 112.22 feet; thence South  $63^{\circ} 34' 11''$  West, 39.31 feet; thence along the arc of a 700.00 foot radius curve to the right, through a central angle of  $13^{\circ} 36' 06''$ , for an arc distance of 166.18 feet; thence South  $77^{\circ} 10' 50''$  West, 297.47 feet; thence along the arc of a 280.00 foot radius curve to the left, through a central angle of  $7^{\circ} 27' 36''$ , for an arc distance of 36.46 feet to

Legal Description for

Susie Richards

**PROPOSED 20 ACRES TO BE SEGREGATED FROM THE "RICHARDS TRACT":**

November 30, 2007

Page 2

the West line of the Southwest quarter of Section 35; thence, leaving the centerline of Mabee Mines Road, North 01° 10' 22" East, 89.16 feet to the POINT OF BEGINNING.

Planning Department - ~~Exemption over~~  
20 acres approved by: 

TOGETHER WITH and SUBJECT TO easement and restrictions of record.

EXCEPT County Roads.

LD-2007\Richards-20 Acres to be segregated.gab  
07-192

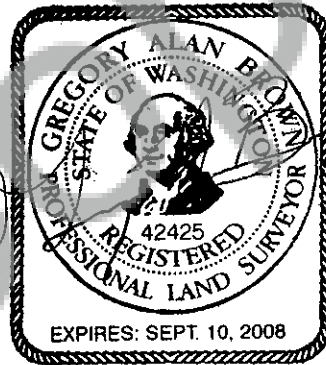

EXPIRES: 9-10-2008  
12-3-2007