

N: 167229.57 /
E: 1291868.81

(A-23)

CONTROL SPECIFICATIONS AND ACCURACY:
SELECTED TRAVERSE STATIONS WERE COORDINATED USING THE NATIONAL GEODETIC ON-LINE POSITIONING USER SERVICE, RAPID STATIC VERSION (OPUS-RS), USING A MINIMUM OF 15 MINUTES OF DATA WITH A MINIMUM OF 2 OCCUPATIONS SEPARATED IN TIME BY A MINIMUM OF 1 HOUR. GLOBAL POSITIONING SYSTEM (GPS) DATA WERE COLLECTED USING TRIMBLE R8 GPS RECEIVERS.

THIS SURVEY WAS DONE BY FIELD TRAVERSE USING A TOPCON GTS-603AF 3 SECOND TOTAL STATION. TRAVERSES WERE CLOSED LOOPS OR CLOSED THOSE BETWEEN KNOWN POINTS. LINEAR AND ANGULAR CLOSURES EXCEEDED THOSE SHOWN IN WAC 332-130-090 FOR LAMBERT GRID TRAVERSES. CORNER MONUMENTS TIED AND MONUMENTS SET WERE CHECKED BY DOUBLE MEASURES OF BOTH DIRECTION AND DISTANCE.

BASIS OF BEARINGS AND DISTANCES:

WASHINGTON COORDINATE SYSTEM, SOUTH ZONE, NAD 83(CORS98) (EPOCH: 2002.0000). DERIVED FROM GLOBAL POSITIONING SYSTEM (GPS) TIES TO THE FOLLOWING CONTINUOUSLY OPERATING REFERENCE STATIONS:

P376	PID DH4503	P702	PID DH5822
P420	PID D68344	GPS	PID A79664
P432	PID D68347	GPS	PID A79664
P698	PID DH4129	KELS	PID A79664

CONVERGENCE: -0' 59' 33" AT CORNER E-23 THE DISTANCES SHOWN ARE GRID. DIVIDE THE GRID DISTANCE BY THE COMBINED GRID FACTOR OF 0.99997057 TO OBTAIN THE GROUND DISTANCE. THE COMBINED GRID FACTOR IS DERIVED FROM AN ELEVATION FACTOR OF 0.99995575 AND A GRID SCALE FACTOR OF 1.00001482 BASED ON PROJECT AVERAGES.

DESCRIPTION OF STATE PROPERTY SURVEYED:

A PORTION OF THE EAST LINE OF THE SE 1/4 OF THE SW 1/4, SECTION 1, TOWNSHIP 3 NORTH, RANGE 7.5 EAST, W.M., SKAMANIA COUNTY, WASHINGTON

INDICATES THAT WHITE FIBERGLASS "BOUNDARY" POSTS WERE SET AT RANDOM INTERVALS ALONG THE NOTED SECTION OR SUB-DIVISIONAL LINES AND ARE WITHIN ONE FOOT OF THE ACTUAL SECTION OR SUB-DIVISIONAL LINES.

THE PURPOSE OF THIS SURVEY WAS TO POST THE NOTED PROPERTY LINE FOR TIMBER CUTTING PURPOSES. SEE CORNER NOTE A-23 FOR EXPLANATION OF DISCREPANCY AT THAT CORNER.

CORNER NOTES:

(A-23) 1/4 CORNER OF SECTIONS 1 AND 36

FOUND AND ACCEPTED SKAMANIA COUNTY BRASS CAP ON 9-11-07 THIS SURVEY FOUND A SKAMANIA COUNTY STAMPED BRASS CAP 1.15 FEET BELOW THE SURFACE OF THE PAVED ROAD. NO EVIDENCE OF A BOXED MONUMENT WAS FOUND.
THE SURVEY IN BOOK 1 OF SURVEYS, PAGE 8, SET A 3/4" IRON PIPE WITH PLASTIC CAP 25.0 FEET SOUTH OF A BOX. MON. THIS IRON PIPE WITH PLASTIC CAP WAS FOUND AT S9W 27.27 FEET FROM THE SKAMANIA COUNTY CAP.
THE SURVEY IN BOOK 3 OF SURVEYS, PAGE 130, FOUND A BRASS CAP IN BOX MONUMENT. THE 3/4" IRON PIPE AND SET AN IRON ROD WITH PLASTIC CAP 65.07 FEET EASTERLY. THIS IRON ROD WAS FOUND DURING THIS SURVEY. BECAUSE THERE WERE DISCREPANCIES IN WHAT WE FOUND, THE ANGLE BETWEEN THE IRON ROD AND THE BOX MON AT THE IRON PIPE, AS DETERMINED FROM BOOK 3, PAGE 130, WAS TURNED AND A MARK MADE ON THE ROAD AT 25.0 FEET. A CAREFUL SEARCH WITH A MAGNETIC LOCATOR DETECTED NOTHING AT THIS LOCATION. THE MARK IS S55W 3.74 FEET FROM THE SKAMANIA COUNTY CAP.
I SPOKE WITH CURTIS SKAAR, FORMER COUNTY ENGINEER. ABOUT THIS CORNER, HE RECALLED NO MAJOR ROAD WORK AT THIS INTERSECTION OF OLD STATE HIGHWAY AND PANTHER CREEK ROAD THAT WOULD HAVE CAUSED THE BOX MONUMENT TO DISAPPEAR OR MOVE.
WE SET A CAST IRON MONUMENT CASE OVER THE SKAMANIA COUNTY BRASS CAP AND THE FOLLOWING REFERENCES WERE NOTED:
5 REFERENCES
POWER POLE AT N67E 52.16 FEET TO ALUMINUM NAIL IN SOUTHEAST SIDE, STEEL CORNER POST IN CYCLOPE FENCE AT S6W 32.95 FEET TO NEAR EDGE AT 5 FEET ABOVE GROUND LEVEL. (THE POST LEANS SOUTH)
OLSON ENGINEERING PIPE WITH PLASTIC CAP AT S9W 27.27 FEET.
RR SPIKE WITH PUNCH MARK AT S27W 15.69 FEET.
POWER POLE AT N9W 93.65 FEET TO ALUMINUM NAIL IN WEST SIDE.
THE CORNER IS IN THE CENTERLINE OF THE OLD STATE HIGHWAY BUT NOT ON THE EXTENDED CENTERLINE OF PANTHER CREEK ROAD. THE MARK MADE AT 25.0 FEET NORTH OF THE 3/4" IRON PIPE IS NOT ON THE CENTERLINE OF EITHER ROAD.
FIELD BOOK 3057, PAGE 4

(E-23) 1/4 CORNER OF SECTIONS 1 AND 12

FOUND AND ACCEPTED DNR CONCRETE MONUMENT ON 9-15-07 THIS SURVEY FOUND THE 3" CYLINDRICAL DNR CONCRETE MONUMENT WITH STAMPED BRASS CAP SET AT A CALCULATED POSITION AS SHOWN ON DNR FINAL MAP 315. IT IS 10 FEET NORTH OF A ROCKED ROAD. THE FOLLOWING REFERENCES WERE NOTED:
3 REFERENCES
24" FIR, BROKEN OFF 8 FEET ABOVE GROUND, AT N14E 9.41 FEET TO ALUMINUM NAIL IN WEST SIDE.
DNR CARSONITE WITNESS POST AT SOUTHWEST 0.5 FOOT.
22" FIR AT N64W 42.01 FEET TO ALUMINUM NAIL IN SOUTHWEST SIDE.
FIELD BOOK 3057, PAGE 3

11-13-07

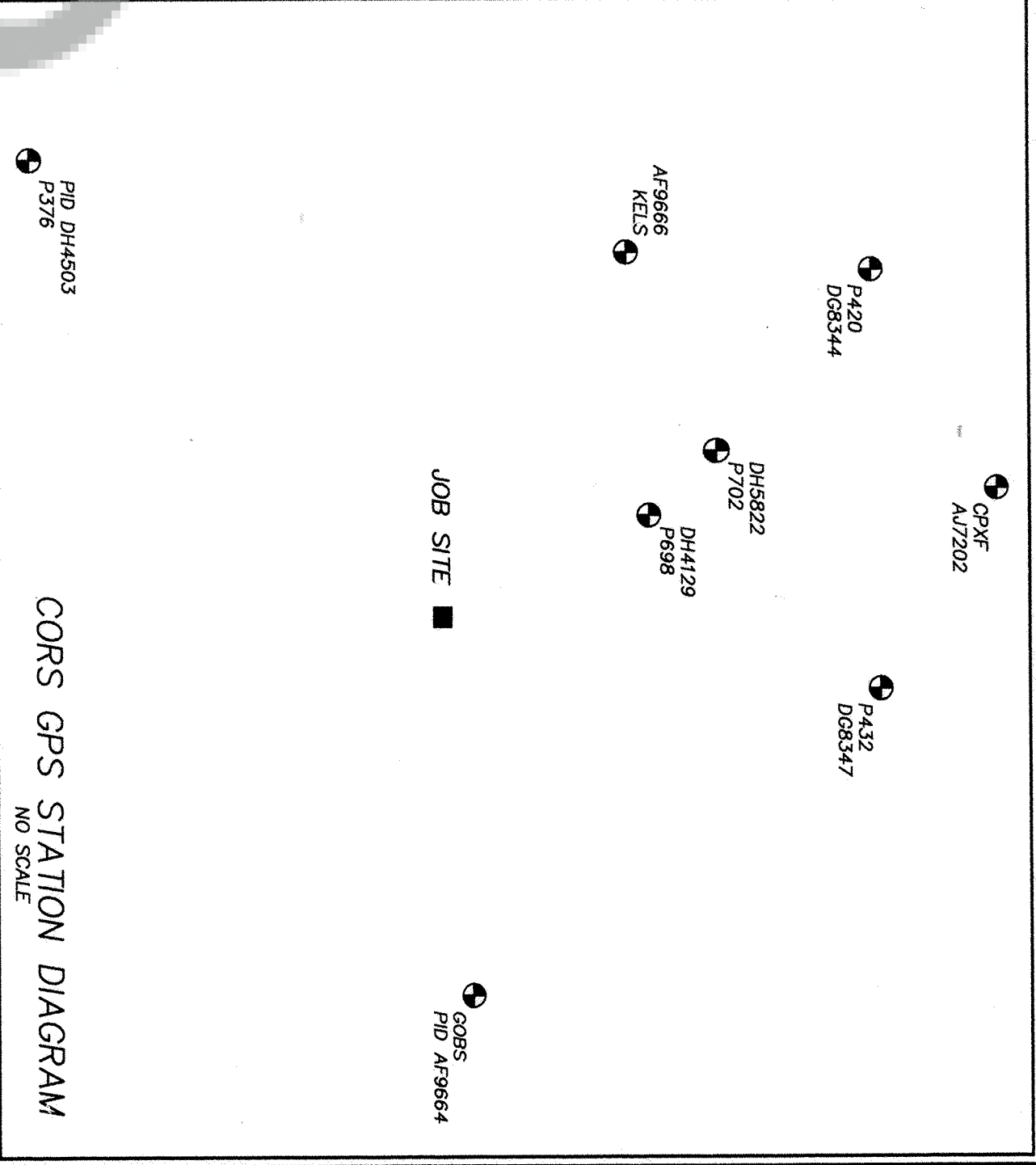
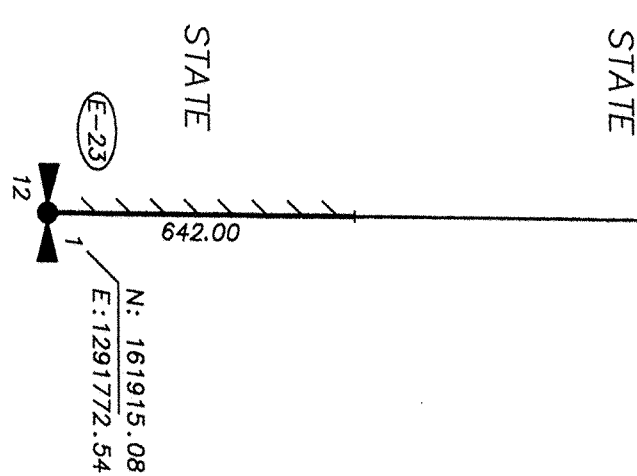

AUDITOR'S CERTIFICATE

FILED FOR RECORD THIS 19 DAY OF November, 2007
AT 12:07 P.M. IN BOOK 1 OF SURVEYS AT PAGE 1
AT THE REQUEST OF THE WASHINGTON STATE DEPARTMENT OF
NATURAL RESOURCES.
Melvin Sullivan 2007168285
SKAMANIA COUNTY DEPUTY AUDITOR AUDITOR'S FILE NUMBER

SURVEYOR'S CERTIFICATE

THIS MAP CORRECTLY REPRESENTS A SURVEY MADE BY ME OR UNDER MY DIRECTION IN CONFORMANCE WITH THE REQUIREMENTS OF THE SURVEY RECORDING ACT AT THE REQUEST OF THE WASHINGTON STATE DEPARTMENT OF NATURAL RESOURCES IN SEPTEMBER, 2007.

H. Thomas Laird, Jr., PLS. 21490
CERTIFICATE NUMBER

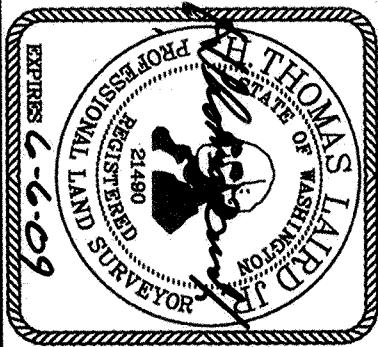

A SURVEY IN SECTION 1
TOWNSHIP 3 NORTH, RANGE 7-1/2 EAST, W.M.

STATE OF WASHINGTON
DEPARTMENT OF NATURAL RESOURCES

LAND SURVEY SECTION-P.O. BOX 47060
OLYMPIA, WASHINGTON 98504-7060 (360)902-1206

KANAKA 1 SURVEY

FIELD CREW: LAIRD, RAY

FIELD BOOK: 3057 FM1551.DWG 11/01/07

F.M.# 1551
SHEET 1 OF 1

