

BUREAU 0 Doc # 2007166938
Page 1 of 3
Date: 07/19/2007 01:16P
Filed by: MORRIE FOLSON
Filed & Recorded in Official Records
of SKAMANIA COUNTY
SKAMANIA COUNTY AUDITOR
J MICHAEL GARVISON
Fee: \$34.00

Return Address:

Morrie Folson
2831 Grand
Central WA 99531

NOTICE OF LOCATION OF PLACER CLAIM

Indexing information required by the Washington State Auditor's/Recorder's Office, (RCW 56.10 and RCW 65.04) 1/97:

(please print last name first)

Reference # (If applicable):

Own: MORRIE FOLSON F. (2) Dick Quartroun Addl. on pg

Addl. on page Legal Description (abbreviated): SEC 4 RBA TION W 1/2 NE 1/4 NE 1/4

Addl. legal is on page Assessor's Property Tax Parcel /Account #

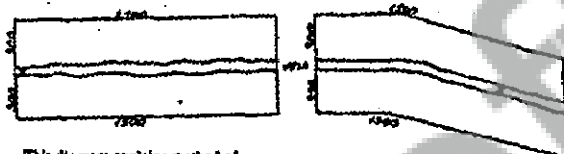

This diagram explains method of description of claim.

State of WASHINGTON

County of SKAMANIA
(or Recording Precinct)

Mc Coy Creek
Mining District

NOTICE IS HEREBY GIVEN That the undersigned who is/are (he declared intention to become) citizens of the United States, have discovered and have located and claimed and do hereby locate 1320 linear feet in length, and 660 feet in width on the

GEYER'S NUGGET Lode, with ledge or deposit for placer ground, situated in the above State, County (or Recording Precinct) and Mining District, and further described as follows: Commencing at a post marked No 1 at the Discovery shaft (cut or tunnel), from thence 25 feet in a EAST direction to an end post marked No 2; thence 200 feet in a SOUTH direction to a corner post marked No 3; thence 660 feet in a WEST direction to a corner post marked No 4; thence 1320 feet in a NORTH direction to a corner post marked No 5; thence 660 feet in a EAST direction to a corner post marked No 6; thence 1120 feet in a SOUTH direction to said end post no 2; hereby locating and intending to claim 200 feet in a SOUTH direction from the discovery to the South end line, and 1120 feet in the opposite direction from discovery to the North end line and 330 feet on each side of the middle of said lode or ledge, for the purpose of mining the same and claiming all surface rights, privileges, and minerals, with all dips, spurs, angles and variations, and other rights granted by existing laws and customs.



Notice of Mining Location

©Washington Legal Blank, Inc., Issaquah, WA Form No. 284D 1/97

MATERIAL MAY NOT BE REPRODUCED IN WHOLE OR IN PART IN ANY FORM WHATSOEVER.

BUREAU OF LAND MGMT.

2007 JUL 16 PM 11 23

OREGON STATE OFFICE
PORTLAND, OR.

This claim is further described by reference to natural objects or permanent monuments, as follows:

This notice is placed at Discovery on post No 1; posts are place at each corner, and the name of this lode, and date of location, are placed on all posts.

Located th 17th day of July 2007.

Mario L. Luna
Abel Quintan

Locators.

WITNESSES:

STATE OF WASHINGTON

SS. (INDIVIDUAL ACKNOWLEDGEMENT)

County of

Skamania

do solemnly swear that I am a citizen of the United States of America (or have declared my intention to become such) and that I am acquainted with the mining ground described in the notice of location, and herein called the BEN'S NUGGET Placer Mining Claim; that the ground and claim herein described, or any part thereof, has not, to the best of my knowledge and belief, been located according to the laws of the United States and this State, or if so located, that the same has been abandoned or forfeited by reason of failure of such former locators to comply in respect thereto with the requirements of said laws; and that I have performed the equivalent of at least \$100.00 in labor on such claim and have complied with all applicable laws of this State pertaining to this claim.

Signed and sworn to before me on the _____ day of _____

Print Name _____

Notary Public in and for the State of _____

My appointment expires _____

BUREAU OF LAND MGMT.
2007 JUL 16 PM 11 23
OREGON STATE OFFICE
PORTLAND, OR

Signature of Claimant Donald D. Harris

date 22 Dec 98

MAP of Mining Claim(s)

Township 10 N Range 8 E Section 4 State of WASHINGTON

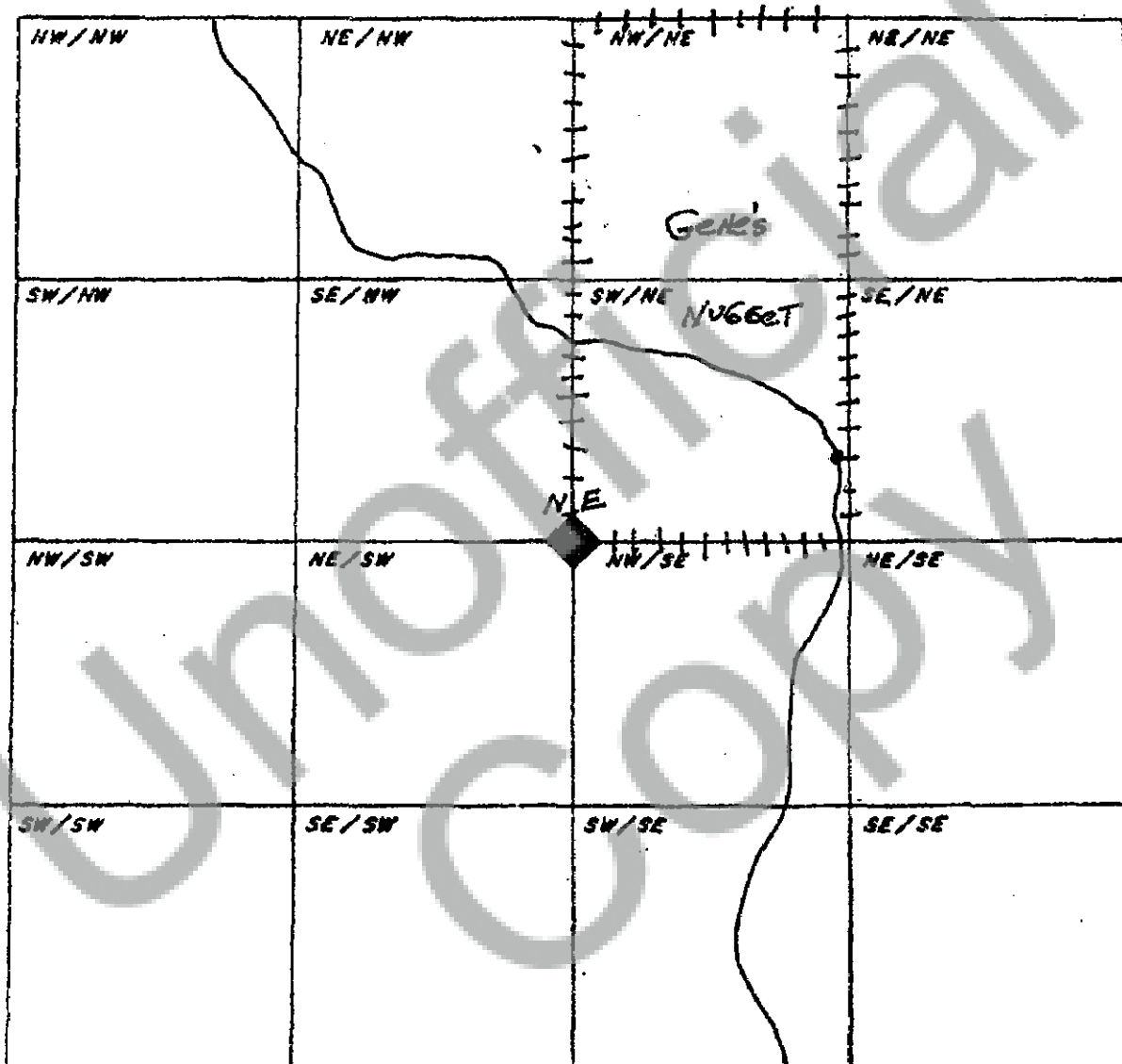

When drawing your claim(s) use an ordinary ruler. 1/8th of an inch would be 100 feet so a full size lode (600' x 1500') would be 3/4" by 1 7/8". A full size placer (1320' x 660') would be 1 5/8" by 13/16".