

# SURVEY

in the SW 1/4 NW 1/4 and  
the NW 1/4 SW 1/4 of  
SECTION 36, T3N, R7E, W.M.  
SKAMANIA COUNTY, WA.

26  
35  
36

(N 88°23'08" W 2642.44') 1&2

POSITION OF SKAMANIA COUNTY  
BRASS CAP AS SHOWN IN  
BK 1 OF SURVEYS PG 74

25  
36

POSITION OF STONE WITH "X"  
AS SHOWN IN BK 1 OF  
SURVEYS PAGE 74

## ROAD NOTE

THE BEARING OF NORTH 66° 08' 39" EAST IS SHOWN AS NORTH 66° 08' 38" EAST ON SHEET 9 OF 9 OF CRP 2008-2. I HELD THE DELTA OF 33' 17" 06", AS SHOWN ON THE PLANS COMING INTO THIS TANGENT. THIS ALSO CHANGES THE BEARING OF NORTH 51° 33' 18" EAST, AS SHOWN ON THE PLANS BY 00° 00' 01". I ALSO HELD BOTH RECORD DELTA'S OF 14° 35' 20" AND 43° 26' 42" NORTH OF THE PROJECT SITE TO DERIVE A TANGENT BEARING OF SOUTH 84° 59' 59" EAST, AS SHOWN ON THE PLANS. THE SOUTH RIGHT-OF-WAY LINE OF RYAN ALLEN ROAD ON THE NORTH LINE OF THE PROJECT AND THE NORTH LINE OF THE "TRUELOVE TRACT" WAS TAKEN FROM DEED BOOK 221, PAGE 998 AND A CAD FILE OF CRP 2008-2 SUPPLIED BY SKAMANIA COUNTY DEPARTMENT OF PUBLIC WORKS.

## NARRATIVE

THE PURPOSE OF THIS SURVEY WAS TO MONUMENT THE "MOORE AND LEEK TRACTS" CITED. A RANDOM CONTROL TRAVERSE WAS RUN FROM THE WEST QUARTER CORNER TO THE CENTER OF SECTION 36. THIS TRAVERSE WAS THEN ORIENTED TO THE BEARING BETWEEN THOSE TWO POINTS AS SHOWN IN ROS 1-74. A SUBLOOP TRAVERSE WAS RUN FROM AND CLOSED ON THE ABOVE MENTIONED TRAVERSE THROUGH THE SUBJECT TRACTS. NEW MONUMENTS ESTABLISHED WERE SET RADIALLY FROM THE ABOVE DESCRIBED TRAVERSES WHICH MET THE REQUIREMENTS OF WAC 332-130-090. FIELD EQUIPMENT USED CONSISTED OF A 3-SECOND "TOTAL STATION INSTRUMENT" WITH ELECTRONIC DATA COLLECTOR.

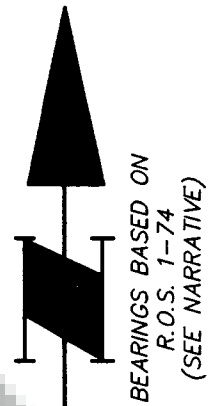

0 150 300 600  
SCALE 1"=300'

## LEGEND

- MONUMENT AS SHOWN (TIED 1/05/2007) IF NOTED AS FOUND
- ( )<sup>1</sup> RECORD DATA PER R.O.S. 1-47 (SKAMANIA CO.)
- ( )<sup>2</sup> RECORD DATA PER R.O.S. 1-74 (SKAMANIA CO.)
- AF# = AUDITOR'S FILE NUMBER
- I.P. = IRON PIPE
- R.O.S. = RECORD OF SURVEY

## DEED REFERENCE

STATUTORY WARRANTY DEED  
SHAHALA FALLS, LLC  
TO  
SHELLEY MOORE, ET AL  
AF# 2006164166 (12/15/2006)  
QUIT CLAIM DEED  
BOUNDARY LINE ADJUSTMENT  
N. LEEK, D. LEEK AND S. MOORE  
TO  
N. LEEK, D. LEEK AND S. MOORE  
AF# 2007165862  
(4/26/2007)

## SURVEYOR'S CERTIFICATE

This map correctly represents a survey made by me or under my direction in conformance with the requirements of the Survey Recording Act at the request of NATHAN LEEK in APRIL, 2006

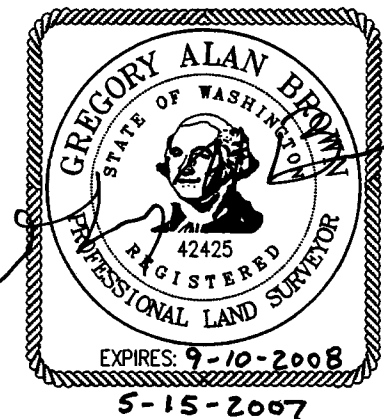

## AUDITOR'S CERTIFICATE

Filed for record this 15<sup>th</sup> day of May, 2007  
at 10:55 a.m. under AF# 2007166111 at the  
request of Hagedorn, Inc.  
(Signed) [Signature] (Deputy) County Auditor

NOTE: Hagedorn, Inc. makes no warranties as to matters of unwritten title such as acquiescence, estoppel, adverse possession, etc.



**HAGEDORN, INC.**  
Surveying and Engineering

1924 Broadway Vancouver, Wa. 98663  
Ph: (360) 696-4428 (503) 283-6778

SCALE: 1"=300'  
DATE: 5/15/07  
JOB NO.: 06-287

CALC. BY: GAB  
DRAWN BY: CC  
CHECKED BY: BPT

DWG# 06-287-Pg1  
PAGE 1 OF 2

(S 01°18'09" W 2641.50') 1&2

(N 00°19'51" E 2600.58') 2

35  
36

FOUND & HELD  
3" BRASS CAP  
(SKAMANIA COUNTY)  
AS SHOWN IN BK 1  
OF SURVEYS, PG 47  
& 74

WEST LINE OF THE  
EAST 5 CHAINS [333.00']  
OF THE NW 1/4 SW 1/4

FOUND & HELD 3/4" I.P.  
WITH WHITE PLASTIC CAP  
(CAP UNREADABLE) AS  
SHOWN IN BK 1 OF SURVEYS  
PAGE 74

(N 03°03'21" W 2626.11') 1

1313.06'

35  
36  
2  
1

POSITION OF SKAMANIA COUNTY  
BRASS CAP AS SHOWN IN  
BK 1 OF SURVEYS PG 47

(S 89°16'17" E 2686.64') 2

(1343.32') 2

1013.10'

330.22'

(1343.32') 2

N 01°21'54" W 1310.65'

S 01°21'54" E 1310.51'

S 89°17'46" E 1304.53'

330.22'

S 89°17'46" E 1304.53'

(S 00°19'51" W 2618.20') 2

1309.10'

S 01°21'54" E 1310.51'

N 01°21'54" W 1310.65'

1265.74'

N 89°19'20" W 2531.48'

1265.74'

36  
1

POSITION OF BOXED MONUMENT  
IN SIDEWALK AS SHOWN IN  
BK 1 OF SURVEYS, PG 74

# SURVEY

in the SW 1/4 NW 1/4 and  
the NW 1/4 SW 1/4 of  
SECTION 36, T3N, R7E, W.M.  
SKAMANIA COUNTY, WA.

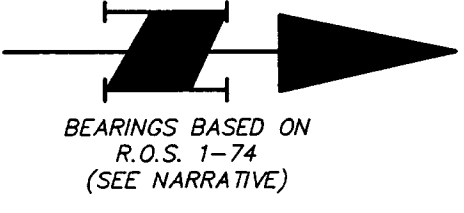

## LEGEND

- MONUMENT AS SHOWN (TIED 1/05/2007)  
IF NOTED AS FOUND
  - SET 5/8" x 30" IRON REBAR WITH ORANGE  
PLASTIC CAP STAMPED "BROWN 42425"  
WITH STEEL FENCE POST SET ALONGSIDE
- LCR = LAND CORNER RECORD  
( )<sup>3</sup> = RECORD DATA PER CRP 2008-2  
DAF# = AUDITOR'S FILE NUMBER  
R = IRON ROD  
C = CENTERLINE  
R/W = RIGHT-OF-WAY  
P/C = YELLOW PLASTIC CAP

LINE TABLE		
LINE	BEARING	DISTANCE
L1	N 78°14'00" E	29.00
L2	N 88°27'00" E	29.00
L3	S 88°27'00" E	6.35
L4	N 88°27'00" W	40.65
L5	N 79°46'00" W	72.50
L6	S 85°41'00" W	43.50



**EXPIRES: 9-10-2008**  
**5-15-2007**

**HAGEDORN, INC.**  
*Surveying and Engineering*

**1924 Broadway Vancouver, Wa. 98663**  
Ph: (360) 696-4428 (503) 283-6778

SCALE: 1"=80'	CALC. BY: GAB	DWG# 06-287Pg2
DATE: 5/15/07	DRAWN BY: CC	PAGE 2 OF 2
JOB NO.: 06-287	CHECKED BY: BPT	

AF# 2007166111