

Doc # 2007165682
Page 1 of 6
Date: 04/12/2007 10:54A
Filed by: ANDY LEXOW
Filed & Recorded in Official Records
of SKAMANIA COUNTY
SKAMANIA COUNTY AUDITOR
J MICHAEL GARVISON
Fee: \$37.00

Return Address:

Andy M. Lexow
142 Collins Rd
Washougal WA 98671

Document Title(s) or transactions contained herein:

Notice of Location of Mine Clean
+ Sober II Placer Mine/Claim

GRANTOR(S) (Last name, first name, middle initial)

Lexow Tom M.
Lexow Andy M
Lexow Jane E
Lexow Tim M
Lexow Virginia R
Lexow Mike E.
Chipman Duane R
Szedelyi, Tamas

☐ Additional names on page of document.

GRANTEE(S) (Last name, first name, middle initial)

Mine Clean + Sober II

☐ Additional names on page of document.

LEGAL DESCRIPTION (Abbreviated: i.e., Lot, Block, Plat or Section, Township, Range, Quarter/Quarter)

Big Rock Creek T5N R5E Section 7 NWNW, SWSW
T5N R5E Section 18 NWNW, SWNW, SW
T5N R5E Section 19 NENW, SENW

☐ Complete legal on page of document.

REFERENCE NUMBER(S) of Documents assigned or released:

☐ Additional numbers on page of document.

ASSESSOR'S PROPERTY TAX PARCEL/ACCOUNT NUMBER

☐ Property Tax Parcel ID is not yet assigned

☐ Additional parcel numbers on page of document.

The Auditor/Recorder will rely on the information provided on the form. The Staff will not read the document to verify the accuracy or completeness of the indexing information.

TO ALL WHOM IT MAY CONCERN:

The undersigned hereby certifies that he has caused to be located the Mine Clean + Sober Placer Mining Claim in the following quarter sections(s):

1/4	Section	Township	Range	Meridian
SW	7	5N	5E	
NW	18	5N	5E	
SW	18	5N	5E	
NW	19	5N	5E	

RECORDER'S STAMP

in Skamania County, WA, on the 12 day of April, 2007

Name and mailing address of locator is:

Andy M Lexow
1421 Collins Rd
Washougal WA 98671

The Placer Claim is approximately 9000 feet in the NESE direction. Said Placer Claim contains 160 acres, more or less. The monument of location is located on the north boundary of the Claim, as follows: 4' Blue Post on Corners + Ribbons
on perimeter

The number, location and markings on each corner monument are as follows:

	Location	Markings	Description
No. 1:	<u>T5N R5E Sec 7 NWSW</u>	<u>Blue Post/Ribbons</u>	<u>Corner Post</u>
No. 2:	<u>T5N R5E Sec 18 NESW</u>	<u>Blue Post/Ribbons</u>	<u>Perimeter Post</u>
No. 3:	<u>T5N R5E Sec 18 SESW</u>	<u>Blue Post/Ribbons</u>	<u>Perimeter Post</u>
No. 4:	<u>T5N R5E Sec 19 SWSW</u>	<u>Blue Post</u>	

As erected on the ground, each corner monument is marked as described above by Blue Paint/Claim (e.g. metal tags, paint on posts).

Dated this 12 day of April, 2007

SIGNATURE OF LOCATOR:

By

Owner, Claimant, or Agent Signature

Andy M Lexow
Owner, Claimant, or Agent Name (printed)

NOTICE OF LOCATION OF PLACER CLAIM

Important Notice: Because applicable state laws determine certain requirements, check with your local State and Federal agencies to ensure that all requirements are met.

MAP OF CLAIMS

TOWNSHIP 5N RANGE 5E SECTION 7 TOWNSHIP 5N RANGE 5E SECTION 19

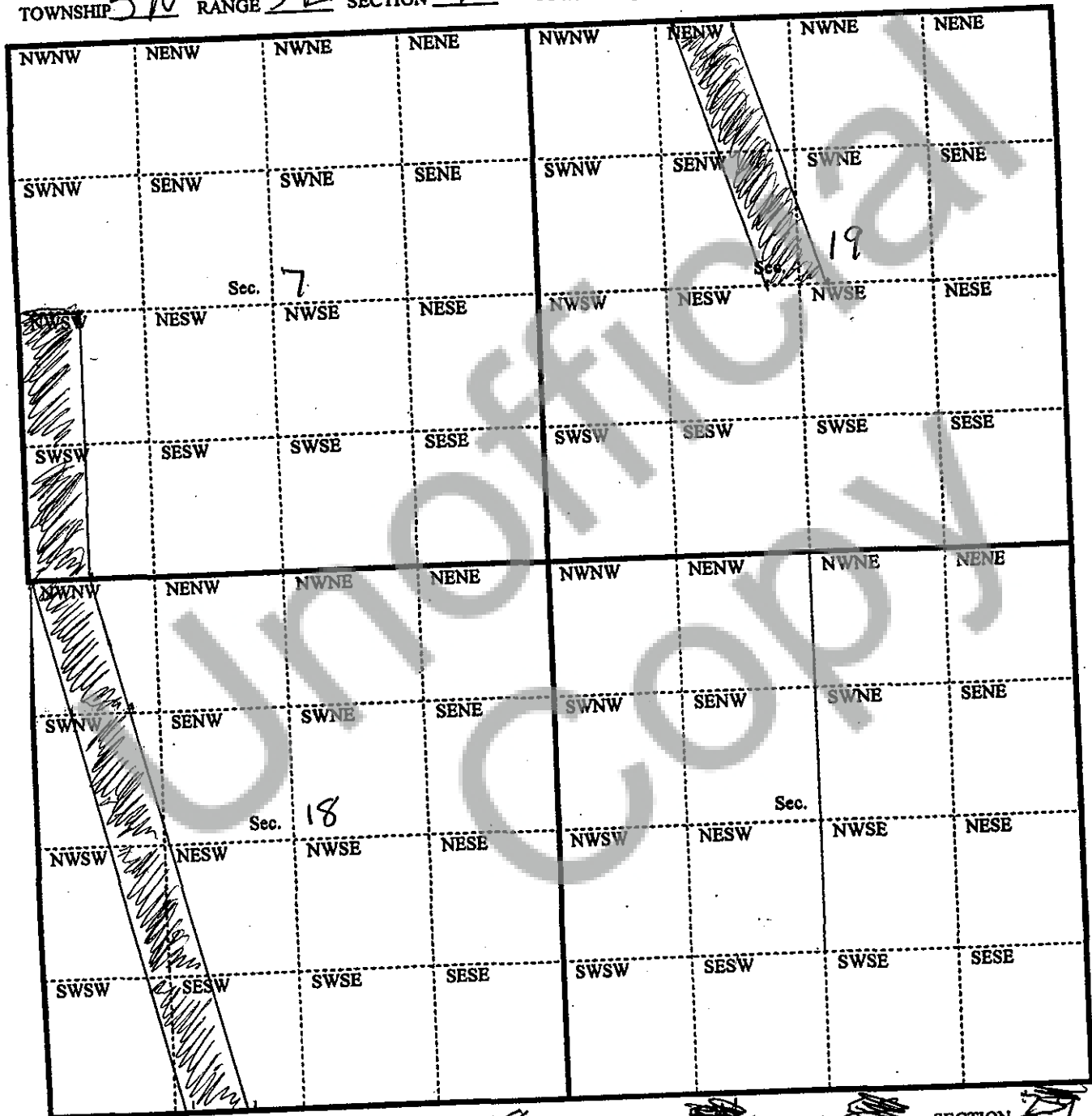

TOWNSHIP 5N RANGE 5E SECTION 18 TOWNSHIP 5N RANGE 5E SECTION 19

WHEN DRAWING YOUR CLAIMS, USE AN ORDINARY RULER.

THE PLAT SCALE: 1/6"=100'

NOTICE OF LOCATION OF PLACER CLAIM

Important Notice: Because applicable state laws determine certain requirements, check with your local State and Federal agencies to ensure that all requirements are met.

Sketch Map of Mining Claim(s)

Signature of Claimant: *Apm20* Date: 4/3/07

Claim(s) Number(s): ORMC

Township 5N Range 5E Section 7 State WA

NWNW	NENW	NWNE	NENE
SWNW	SENW	SWNE	SENE
NWSW	NESW	NWSE	NESE
SWSW	SESW	SWSE	SESE

Big Rock Creek

When drawing your claim(s), use an ordinary ruler. 1/8 of an inch equals 100 feet. Therefore a full sized lode claim (600' x 1500') would be 3/4" by 1-7/8". A full size, 20-acre placer claim (660' x 1320' - not an association placer mining claim) would be 1-5/8" by 13/16".

NOTICE OF LOCATION OF PLACER CLAIM

Important Notice: Because applicable state laws determine certain requirements, check with your local State and Federal agencies to ensure that all requirements are met.

Sketch Map of Mining Claim(s)

Signature of Claimant: [Signature] Date: 4/3/07

Claim(s) Number(s): ORMC

Township 5N Range 5E Section 18 State WA

NWNW	NENW	NWNE	NENE
SWNW	SEnw	SWNE	SENE
NWSW	NESW	NWSE	NESE
SWSW	SESW	SWSE	SESE

Big Rock Creek

When drawing your claim(s), use an ordinary ruler. 1/8 of an inch equals 100 feet. Therefore a full sized lode claim (600' x 1500') would be 3/4" by 1-7/8". A full size, 20-acre placer claim (660' x 1320' - not an association placer mining claim) would be 1-5/8" by 13/16".

NOTICE OF LOCATION OF PLACER CLAIM

Important Notice: Because applicable state laws determine certain requirements, check with your local State and Federal agencies to ensure that all requirements are met.

Sketch Map of Mining Claim(s)

Signature of Claimant: Armsup Date: 4/3/07

Claim(s) Number(s): ORMC

Township 5N Range 5E Section 19 State WA

NWNW	NENW	NWNE	NENE
SWNW	SENW	SWNE	SENE
NWSW	NESW	NWSE	NESE
SWSW	SESW	SWSE	SESE

Handwritten notes on the map:
 A diagonal line with hatching runs from the top-right corner of the NWNE section to the bottom-right corner of the SWNE section.
 The text "Rock Creek" is written vertically along the right edge of the map, spanning the NENE, SENE, and NESE sections.

When drawing your claim(s), use an ordinary ruler. 1/8 of an inch equals 100 feet. Therefore a full sized lode claim (600' x 1500') would be 3/4" by 1-7/8". A full size, 20-acre placer claim (660' x 1320' - not an association placer mining claim) would be 1-5/8" by 13/16".