

Doc # 2007164666
Page 1 of 5
Date: 01/18/2007 02:53P
Filed by: KPF SURVEYING INC
Filed & Recorded in Official Records
of SKAMANIA COUNTY
SKAMANIA COUNTY AUDITOR
J MICHAEL GARVISON
Fee: \$36.00

**Recording Requested By and
After Recording, Mail To**

David P. Miller, Esq.
Stoel Rives LLP
900 SW Fifth Avenue, Suite 2600
Portland, OR 97204-1286

REAL ESTATE EXCISE TAX

26689
JAN 18 2007
PAID Exempt
Jackie Chelland, Deputy
SKAMANIA COUNTY TREASURER

BARGAIN AND SALE DEED

Documents released or assigned: None

Grantor: **ANE FORESTS OF LEWIS RIVER INC.,**
a Washington corporation

Grantee: **ANE FORESTS OF LEWIS RIVER INC.,**
a Washington corporation

Abbreviated Legal Description:

Skamania County Assessor
Date 1/18/07 Parcel# 07052200300000
2m

The Southwest quarter of Section 22, Township 7 North, Range 5
East, W.M., Skamania County, Washington

As further described on attached Exhibit A

Assessor's Property Tax Parcel Account Number:

A PTN OF
070522000 100 00

Planning Department - Exemption over
20 acres approved by: NH-12/28/06

BARGAIN AND SALE DEED

The Grantor, **ANE FORESTS OF LEWIS RIVER INC.**, a Washington corporation, for no consideration, bargains sells and conveys to **ANE FORESTS OF LEWIS RIVER INC.**, a Washington corporation, Grantee, the real estate situated in Skamania County, State of Washington, as described on attached Exhibit A and as shown on the survey plat attached hereto as Exhibit B.

IN WITNESS WHEREOF, the Grantor has executed this Bargain and Sale Deed this 25th day of September, 2006.

GRANTOR:

ANE FORESTS OF LEWIS RIVER INC.

By: 
Sorn Nymark, President

STATE OF OREGON)
) ss.
County of Multnomah)

On September 25, 2006, before me personally appeared SORN NYMARK, to me known to be the President of ANE Forests of Lewis River Inc., a Washington corporation, the corporation that executed the within and foregoing instrument, and acknowledged said instrument to be the free and voluntary act and deed of said corporation, for the uses and purposes therein mentioned, and on oath stated that he was authorized to execute said instrument on behalf of said corporation.

IN WITNESS WHEREOF, I have hereunto set my hand and affixed my official seal the day and year first above written.

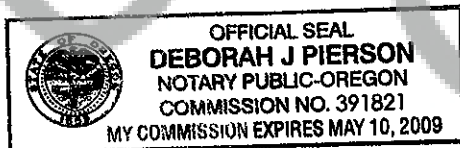

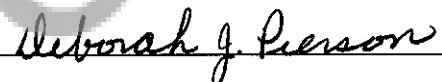
Signature: 

Name (Print): Deborah J. Pierson

NOTARY PUBLIC in and for the State Oregon,
residing at Gresham, Oregon

My appointment expires: 05/10/09

NH



KPF Surveying Inc.
1514 N.E. 267th Ave.
Camas, WA 98607
360-834-0174

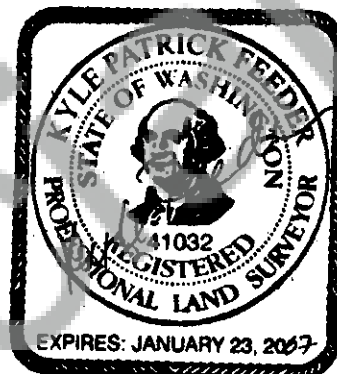

October 14, 2006

EXHIBIT "A"

A tract of land located in a portion of the Southwest quarter of Section 22, Township 7 North, Range 5 East, Willamette Meridian, Skamania County, Washington, more particularly described as follows;

Beginning at the Southwest corner of the Southwest quarter of said Section 22;

Thence North 01°27'15" East along the west line of said southwest quarter for a distance of 1045.53 feet;

Thence North 90°00'00" East for a distance of 278.12 feet;

Thence South 56°19'38" East for a distance of 958.39 feet;

Thence South 33°38'27" West for a distance of 312.73 feet;

Thence South 65°23'30" East for a distance of 122.61 feet;

Thence South 47°22'56" West for a distance of 327.08 feet to a point on the South line of said Southwest quarter;

Thence North 88°38'04" West along said South line for a distance of 800.00 feet to the POINT OF BEGINNING. NH

Containing 20.00 acres, more or less.

Together with and subject to easements, reservations, covenants, and restrictions apparent or of record. **NH**

Kyle P. Feeder, PLS
President
KPF Surveying Inc.

Unofficial
Copy

EXHIBIT "B"

DATE: 10-14-06

JOB NO. 06-017

NOT TO SCALE

