

Recording Requested By and
After Recording, Mail To

REAL ESTATE EXCISE TAX

David P. Miller, Esq.
Stoel Rives LLP
900 SW Fifth Avenue, Suite 2600
Portland, OR 97204-1286

26675
JAN 18 2007

PAID

exempt
Vicki Clelland
SKAMANIA COUNTY TREASURER

BARGAIN AND SALE DEED

Documents released or assigned: None

Grantor: **ANE FORESTS OF LEWIS RIVER INC.,**
a Washington corporation

Grantee: **ANE FORESTS OF LEWIS RIVER INC.,**
a Washington corporation

Abbreviated Legal Description:

Skamania County Assessor
Date 1/18/07 Parcel 07052200160000
2m

The Northwest quarter and the Northeast quarter of Section 22,
Township 7 North, Range 5 East, W.M., Skamania County,
Washington

As further described on attached Exhibit A

Assessor's Property Tax Parcel Account Number:

A PTN OF

07 05 22000 16000

Planning Department - Exemption over
20 acres approved by: 12/28/06 NH

BARGAIN AND SALE DEED

The Grantor, **ANE FORESTS OF LEWIS RIVER INC.**, a Washington corporation, for no consideration, bargains sells and conveys to **ANE FORESTS OF LEWIS RIVER INC.**, a Washington corporation, Grantee, the real estate situated in Skamania County, State of Washington, as described on attached Exhibit A and as shown on the survey plat attached hereto as Exhibit B.

IN WITNESS WHEREOF, the Grantor has executed this Bargain and Sale Deed this 25th day of September, 2006.

GRANTOR:

ANE FORESTS OF LEWIS RIVER INC.

By: 
Sorn Nymark, President

STATE OF OREGON)
) ss.
County of Multnomah)

On September 25, 2006, before me personally appeared SORN NYMARK, to me known to be the President of ANE Forests of Lewis River Inc., a Washington corporation, the corporation that executed the within and foregoing instrument, and acknowledged said instrument to be the free and voluntary act and deed of said corporation, for the uses and purposes therein mentioned, and on oath stated that he was authorized to execute said instrument on behalf of said corporation.

IN WITNESS WHEREOF, I have hereunto set my hand and affixed my official seal the day and year first above written.

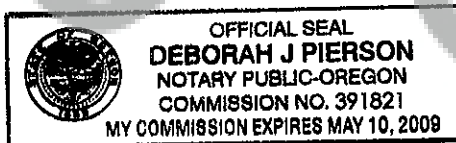

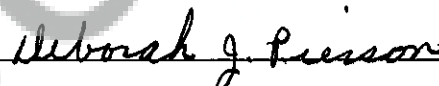
Signature: 

Name (Print): Deborah J. Pierson

NOTARY PUBLIC in and for the State Oregon,
residing at Gresham, Oregon

My appointment expires: 05/10/09

NH

KPF

KPF Surveying Inc.
1514 N.E. 267th Ave.
Camas, WA 98607
360-834-0174

September 6, 2006

EXHIBIT "A"

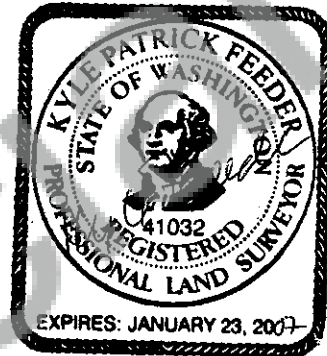

A tract of land located in a portion of the Northwest quarter and the Northeast quarter of Section 22, Township 7 North, Range 5 East, Willamette Meridian, Skamania County, Washington, more particularly described as follows;

Beginning at the Northwest corner of said Section 22;

Thence South $01^{\circ}16'00''$ West along the west line of said Northwest quarter for a distance of 1148.79 feet;

Thence North $90^{\circ}00'00''$ East for a distance of 1382.32 feet to the TRUE POINT OF BEGINNING;

Thence North $90^{\circ}00'00''$ East for a distance of 177.18 feet;

Thence South $10^{\circ}51'31''$ East for a distance of 206.32 feet;

Thence South $52^{\circ}08'36''$ East for a distance of 371.52 feet;

Thence South $51^{\circ}01'35''$ East for a distance of 256.54 feet;

Thence South $78^{\circ}06'37''$ East for a distance of 369.03 feet;

Thence North $74^{\circ}24'49''$ East for a distance of 294.15 feet;
NH

Thence South 77°02'52" East for a distance of 56.32 feet;

Thence South 21°25'54" East for a distance of 506.10 feet;

Thence South 56°10'47" West for a distance of 142.91 feet;

Thence South 68°14'46" West for a distance of 187.24 feet;

Thence North 82°20'50" West for a distance of 176.18 feet;

Thence North 28°02'58" West for a distance of 198.02 feet;

Thence North 84°58'26" West for a distance of 1036.70 feet;

Thence North 00°00'00" West for a distance of 932.61 feet to the TRUE POINT
OF BEGINNING.

Containing 20.0 acres, more or less.

Together with and subject to easements, reservations, covenants, and restrictions apparent
or of record. NH

Kyle P. Feeder, PLS
President
KPF Surveying Inc.

EXHIBIT "B"

DATE: 09-13-06

JOB NO. 06-017

NOT TO SCALE

