

Return Address: David O'Hara  
714 Bellevue Avenue E, # 502  
Seattle, WA 98102

Doc # 2006161283  
Page 1 of 5  
Date: 04/21/2006 12:17P  
Filed by: CRAIG SALVESEN  
Filed & Recorded in Official Records  
of SKAMANIA COUNTY  
J. MICHAEL GARVISON  
AUDITOR  
Fee: \$36.00

## Skamania County Department of Planning and Community Development

Skamania County Courthouse Annex  
Post Office Box 790  
Stevenson, Washington 98648  
509 427-3900 FAX 509 427-3907

### Administrative Decision

**APPLICANT:** David O'Hara

**PROPERTY OWNER:** Wauna Lake Club

**FILE NO.:** NSA-05-49

**PROJECT:** To replace the existing boathouse (20'x8') with a new (20'x17'6") boathouse onto an existing dock (480 sq. ft.) on Wauna Lake.

**LOCATION:** Site 45 of the Wauna Lake Club in Stevenson; Section 15 of T2N, R7E, W.M. and identified as Skamania County Tax Lot #32-07-15-0-0-1545-00.

**LEGAL:** Lot 45 of Wauna Lake Club.

**ZONING:** General Management Area- Large Woodland (F-2).

**DECISION:** Based upon the record and the Staff Report, the application by David O'Hara, described above, **subject to the conditions set forth in this Decision**, is found to be consistent with SCC Title 22 and **is hereby approved.**

Although the proposed development is approved, it may not be buildable due to inadequate soils for septic and/or lack of potable water. These issues are under the jurisdiction of Skamania County's Building Division and the Skamania County Health Department.

Approval of this request does not exempt the applicant or successors in interest from compliance with all other applicable local, state, and federal laws.

#### CONDITIONS OF APPROVAL:

The following conditions are required to ensure that the subject request is consistent with Skamania County Code Title 22. This document, outlining the conditions of approval, must be recorded by the applicant in the deed records of the Skamania County Auditor in order to ensure notice of the conditions of approval to successors in interest. SCC §22.06.050(C)(2).

- 1) As per SCC §22.06.050(C)(2), this Administrative Decision **SHALL BE RECORDED** by the applicant in the County deed records prior to commencement of the approved project.
- 2) All developments shall be consistent with the enclosed site plan, unless modified by the following conditions of approval. If modified, the site plan shall be consistent with the conditions of approval. (See attached)
- 3) All disturbed areas shall be re-seeded or planted with native vegetation prior to final inspection by the Planning Department.
- 4) All existing vegetation shall be retained, including aquatic vegetation, and maintained in a healthy condition.
- 5) The applicant shall receive a Hydraulic Projects Application approval from WDFW and submit a copy to the Planning Department prior to the Planning Department signing off on the Building Permit.
- 6) The Planning Department will conduct at least two site visits during construction and at least one site visit for Final Inspection. One will be to verify the location of the structure as stated by the Administrative Decision. Each inspection may take up to four business days from the time of calling for the inspection. Inspections should be arranged by calling the Building Division at 509-427-3920.
- 7) The following procedures shall be effected when cultural resources are discovered during construction activities:
  - a) Halt Construction. All construction activities within 100 feet of the discovered cultural resource shall cease. The cultural resources shall remain as found; further disturbance is prohibited.
  - b) Notification. The project applicant shall notify the Planning Department and the Gorge Commission within 24 hours of the discovery. If the cultural resources are prehistoric or

otherwise associated with Native Americans, the project applicant shall also notify the Indian tribal governments within 24 hours.

- c) Survey and Evaluations. The Gorge Commission shall arrange for the cultural resources survey.

Dated and Signed this 6 day of March, 2006, at Stevenson, Washington.



Nicole Hollatz, Associate Planner  
Skamania County Planning and Community Development.

#### NOTES

Any new residential development, related accessory structures such as garages or workshops, fences, and additions or alterations not included in this approved site plan, will require a new application and review.

As per SCC §22.06.050(C)(5), this Administrative Decision approving a proposed development action shall become void in two years if the development is not commenced within that period, or when the development action is discontinued for any reason for one continuous year or more.

#### APPEALS

**The Director reserves the right to provide additional comment and findings of fact regarding this decision, if appealed.**

This Administrative Decision shall be final unless reversed or modified on appeal. A written Notice of Appeal form must be filed by an interested person within 20 days from the date hereof. Appeals are to be made to the Skamania County Board of Adjustment, P.O. Box 790, Stevenson, WA 98648. Notice of Appeal forms are available at the Planning Department Office and must be accompanied by a \$1,000.00 nonrefundable filing fee.

#### WARNING

On November 30, 1998 the Columbia River Gorge Commission overturned a Skamania County Director's Decision 18 months after the 20 day appeal period had expired. You are hereby warned that you are proceeding at your own risk and Skamania County will not be liable for any damages you incur in reliance upon your Administrative Decision or any amendments thereto.

A copy of the Decision was sent to the following:

Skamania County Building Division  
Skamania County Assessor's Office

A copy of this Decision, including the Staff Report, was sent to the following:

Persons submitting written comments in a timely manner  
Yakama Indian Nation  
Confederated Tribes of the Umatilla Indian Reservation  
Confederated Tribes of the Warm Springs  
Nez Perce Tribe  
Department of Archaeology and Historic Preservation  
Columbia River Gorge Commission  
U.S. Forest Service - NSA Office  
Board of County Commissioners  
State of Washington Department of Community Trade and Economic Development- Dee Caputo  
Department of Fish and Wildlife

**SITE PLAN:**

North: 

Scale:  $\frac{1}{2}$  inches = 20 feet  
 $\frac{1}{4}$  inch = 10 feet

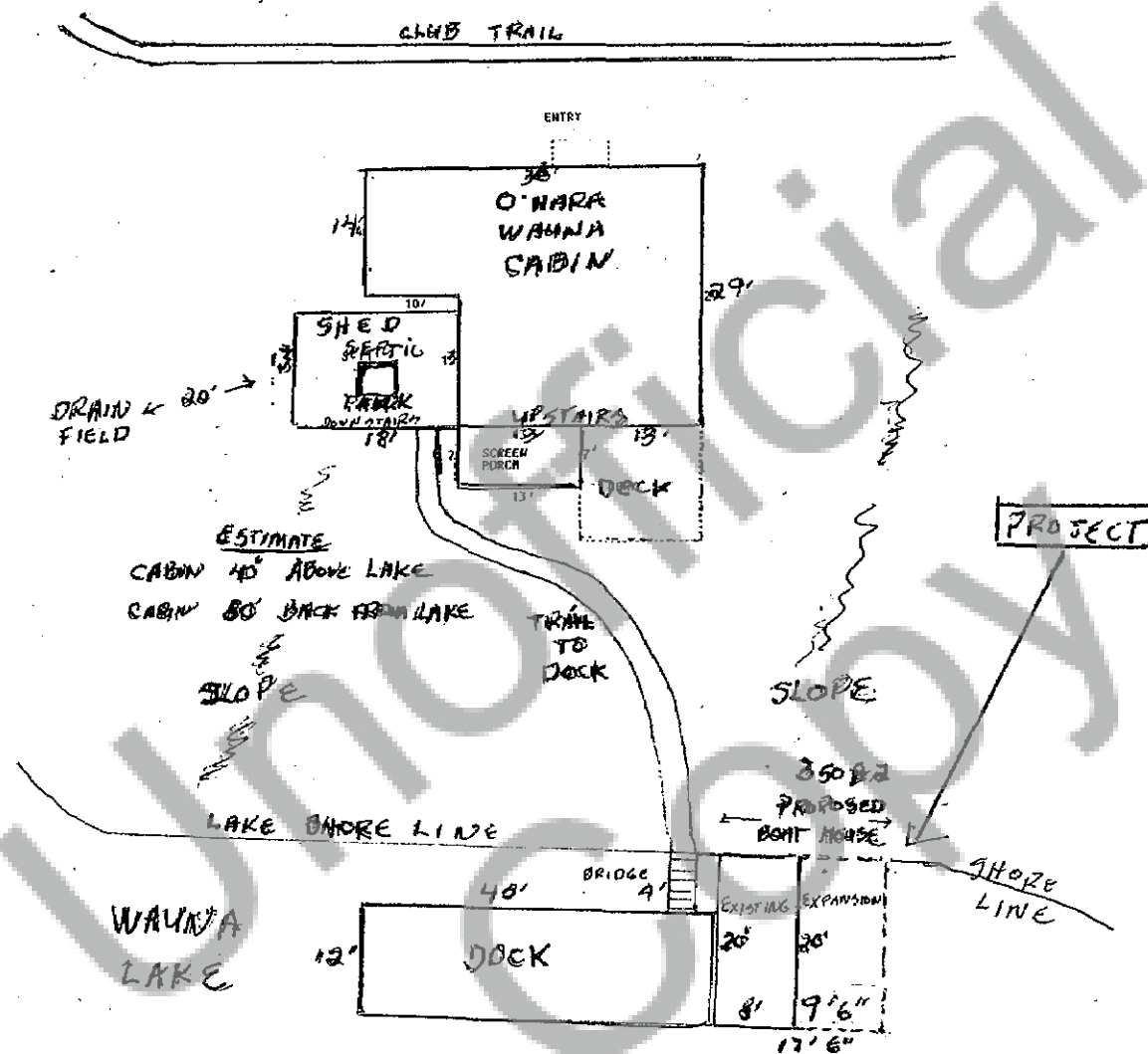

Bodies of water or watercourses on property: yes ☒ no ☐

I will be removing on-site plants, trees, or other vegetation: yes ☐ no ☒

-If yes to either please indicate location of vegetation removal or watercourses.

I will be moving more than 100 cubic yards of soil: yes ☐ no ☒

Additional pages must have 1" margins

Site plan must be completed in ink.

**NOTICE:** This is a proposed site plan, it may be revised as required to be in compliance with the Columbia River Gorge National Scenic Area.