

RECORD OF SURVEY
FOR A

BOUNDARY LINE ADJUSTMENT

IN A PORTION OF THE
NE 1/4 OF THE SE 1/4
SECTION 27
T. 2 N., R. 5 E., W. M.
SKAMANIA COUNTY, WASHINGTON

SURVEY REFERENCE:
1. OLSON SURVEY BOOK 1, PAGE 195

LEGEND

- INDICATES 1/2" X 24" IRON ROD WITH YELLOW PLASTIC CAP STAMPED "GLAESER 15024" UNLESS OTHERWISE NOTED
- INDICATES SURVEY TIES TO EXISTING FENCE USED FOR CALCULATING BOUNDARY
- INDICATES CALCULATED POINT
- NOTHING SET

NARRATIVE:
THE PURPOSE OF THIS SURVEY WAS TO LOCATE THE EXISTING FENCE LINE AND MONUMENT A MUTUAL PROPERTY LINE FOR A PROPOSED BOUNDARY LINE ADJUSTMENT AS SHOWN HEREON. IT IS VERY IMPORTANT TO NOTE THAT THIS SURVEY AND MAP DO NOT CREATE A LEGAL BOUNDARY LINE ADJUSTMENT. TO CREATE THE BOUNDARY LINE ADJUSTMENT PROPER LEGAL DOCUMENTS NEED TO BE PREPARED AND RECORDED BY THE PARTIES INVOLVED IN THE PROCESS.

AUDITOR'S CERTIFICATE

FILED FOR RECORD THIS 16th DAY OF March 2005 AT
9:34 A.M. IN BOOK 15200516601 OF SURVEYS AT PAGE 1
AT THE REQUEST OF MINISTER AND GLAESER SURVEYING, INC. 15200516601

DEPUTY AUDITOR
Deputy Auditor

SURVEYOR'S CERTIFICATE

THIS MAP CORRECTLY REPRESENTS A SURVEY MADE BY ME OR UNDER MY DIRECTION IN CONFORMANCE WITH THE REQUIREMENTS OF THE SURVEY RECORDING ACT AT THE REQUEST OF JOHN SENTENO IN AUGUST, 2004.

Robert W. Glaeser
ROBERT W. GLAESER,
PROFESSIONAL LAND SURVEYOR, LS #15024

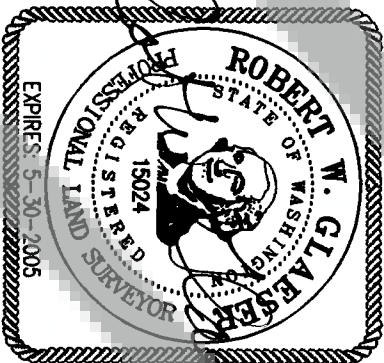

SCALE: 1"=80'
JOB NO. 04-025
DATE: 02-09-05
CALC BY: RWG
DRAWN BY: GLE
CHECKED BY: RWG
SHEET 1 OF 1

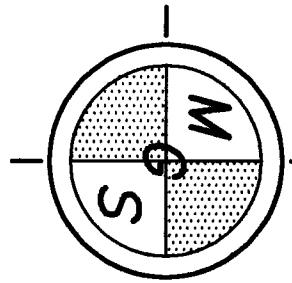

MINISTER-GLAESER
SURVEYING INC.
2200 E. EVERGREEN BLVD.
VANCOUVER, WA 98661
(360) 694-3313