



Doc # 2004155791
Page 1 of 3
Date: 12/30/2004 04:50P
Filed by: ED THOMPSON
Filed & Recorded in Official Records
of SKAMANIA COUNTY
J. MICHAEL GARVISON
AUDITOR
Fee: \$21.00

Return Address:

Ed Thompson
14105 NE 47th St
Vancouver WA 98682

NOTICE OF MINING LOCATION - Amended

Indexing information required by the Washington State Auditor's/Recorder's Office, (RCW 36.18 and RCW 65.04) 1/97: (please print last name first)

Reference # (if applicable): 2004155783

Owner: (1) Ed Thompson (2) Dave Jeler Addl. on pg

Addl. on page Legal Description (abbreviated):

Addl. legal is on page Assessor's Property Tax Parcel /Account #

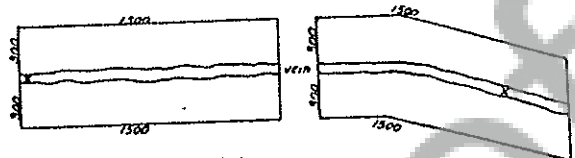

This diagram explains method of description of claim.

State of Washington
County of Skamania
(or Recording Precinct)
Skamania
Mining District

Lead Claim "Primary Gold No. 1"

NOTICE IS HEREBY GIVEN That the undersigned who ~~is~~ are (have declared our intention to become) citizen S of the United States, have discovered and have located and claimed and do so hereby locate 1500 linear feet in length, and 600 feet in width on the Camp Creek T 10N. R 8E Sec. 10 Primary Gold No. 1 Lode, vein ledge or deposit (or placer ground), situated in the above State, County (or Recording Precinct) and Mining District, and further described as follows: Commencing at a post marked No 1 at the Discovery shaft (cut or tunnel), from thence 1000 feet in a South direction to an end post marked No 2, thence 300 feet in a East direction to a corner post marked No 3, thence 1500 feet in a North direction to a corner post marked No 4, thence 600 feet in a West direction to a corner post marked No 5, thence 1500 feet in a South direction to a corner post marked No 6, thence 300 feet in a East direction to said end post no 2; hereby locating and intending to claim 1000 feet in a South direction from the discovery to the #2 end line, and 500 feet in the opposite direction from discovery to the North end line and 300 feet on each side of the middle of said lode or ledge, for the purpose of mining the same and claiming all surface rights, privileges, and minerals, with all dips, spurs, angles and variations, and other rights granted by existing laws and customs.

This claim is further described by reference to natural objects or permanent monuments, as follows:

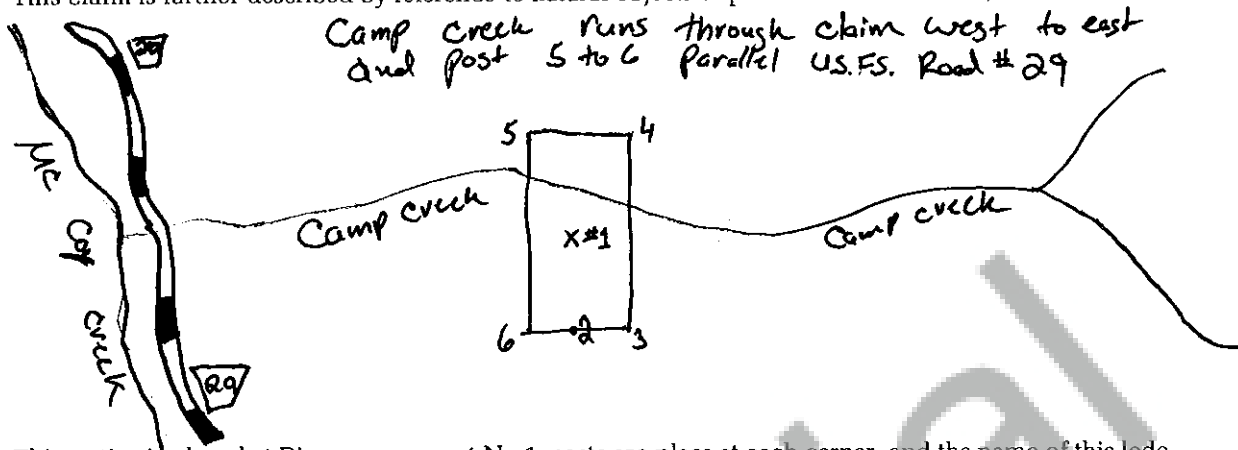

This notice is placed at Discovery on post No 1; posts are place at each corner, and the name of this lode, and date of location, are placed on all posts.

Located the 27 day of Nov, 2004.

[Signature]
Dave Jeter

Locators.

WITNESSES:

STATE OF WASHINGTON

SS. (INDIVIDUAL ACKNOWLEDGEMENT)

County of Skamania

I, Ed Thompson do solemnly swear that I am a citizen of the United States of America (or have declared my intention to become such) and that I am acquainted with the mining ground described in the notice of location, and herein called the Trimay Gold No. 1 Lode Mining Claim; that the ground and claim herein described, or any part thereof, has not, to the best of my knowledge and belief, been located according to the laws of the United States and this State, or if so located, that the same has been abandoned or forfeited by reason of failure of such former locators to comply in respect thereto with the requirements of said laws; and that I have performed the equivalent of at least \$100.00 in labor on such claim and have complied with all applicable laws of this State pertaining to this claim.

Signed and sworn to before me on the

30th

day of

December, 2004

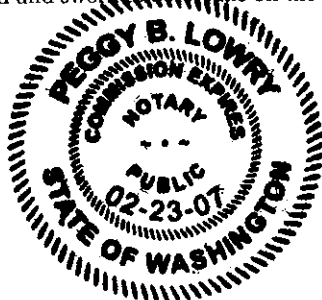

Print Name

[Signature]
Peggy B Lowry

Notary Public in and for the State of

Washington

My appointment expires:

2/23/07

MAP OF CLAIMS

TOWNSHIP 10N RANGE 8E SECTION 10 TOWNSHIP 10N RANGE 8E SECTION 11

NW/NW	NE/NW	NW/NE	NE/NE	NW/NW	NE/NW	NW/NE	NE/NE								
SW/NW	SE/NW	SW/NE	SE/NE	SW/NW	SE/NW	SW/NE	SE/NE								
Sec. 10				Sec. 11											
NW/SW	NE/SW	NW/SE	NE/SE	NW/SW	NE/SW	NW/SE	NE/SE								
SW/SW	SE/SW	SW/SE	SE/SE	SW/SW	SE/SW	SW/SE	SE/SE								
<div style="border: 1px solid black; padding: 5px; width: fit-content; margin: auto;"> <p>5 4</p> <table border="1" style="border-collapse: collapse; text-align: center;"> <tr> <td>1</td><td>2</td><td>3</td><td>4</td></tr> <tr> <td>x</td><td>x</td><td>x</td><td>x</td></tr> </table> <p>3 2</p> </div>				1	2	3	4	x	x	x	x				
1	2	3	4												
x	x	x	x												
NW/NW	NE/NW	NW/NE	NE/NE	NW/NW	NE/NW	NW/NE	NE/NE								
SW/NW	SE/NW	SW/NE	SE/NE	SW/NW	SE/NW	SW/NE	SE/NE								
Sec. 15				Sec. 14											
NW/SW	NE/SW	NW/SE	NE/SE	NW/SW	NE/SW	NW/SE	NE/SE								
SW/SW	SE/SW	SW/SE	SE/SE	SW/SW	SE/SW	SW/SE	SE/SE								

DOC # 2004155791
Page 3 of 3

DOC # 2004155783
Page 3 of 3

TOWNSHIP 10N RANGE 8E SECTION 15 TOWNSHIP 10N RANGE 8E SECTION 14

WHEN DRAWING YOUR CLAIMS, USE AN ORDINARY RULER.
THE PLAT SCALE : 1/6=100'

OR-3832-2
(June 2004)