



Doc # 2004155783
Page 1 of 3
Date: 12/30/2004 11:59A
Filed by: GENERAL PUBLIC
Filed & Recorded in Official Records
of SKAMANIA COUNTY
J. MICHAEL GARVISON
AUDITOR
Fee: \$21.00

Return Address:

Ed Thompson
14105 NE 47th St
Vancouver WA 98682

NOTICE OF MINING LOCATION

Indexing information required by the Washington State Auditor's/Recorder's Office, (RCW 36.18 and RCW 65.04) 1/97:

(please print last name first)

Reference # (If applicable):

Owner: (1) Thompson Edwin (2) Jeter Dave Addl. on pg

Addl. on page Legal Description (abbreviated):

Addl. legal is on page Assessor's Property Tax Parcel /Account #

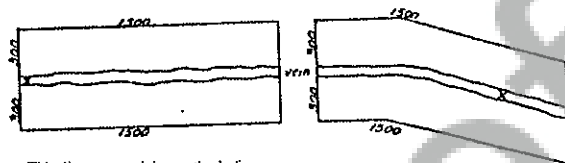

This diagram explains method of description of claim.

State of Washington
County of Skamania
(or Recording Precinct)
Skamania
Mining District

Lode Claim Name "Primary Gold"

No. 1
No. 2
No. 3
No. 4

NOTICE IS HEREBY GIVEN That the undersigned who ~~is~~ are (have declared intention to become) citizen S of the United States, have discovered and have located and claimed and do so hereby locate 2400 linear feet in length, and 1500 feet in width on the Camp Creek T10N R8E Sec. 10 Primary Gold No. 1, No. 2, No. 3, No. 4 Lode, vein ledge or deposit (or placer ground), situated in the above State, County (or Recording Precinct) and Mining District, and further described as follows: Commencing at a post marked No 1 at the Discovery shaft (cut or tunnel), from thence 1000 feet in a South direction to an end post marked No 2, thence 1500 feet in a East direction to a corner post marked No 3, thence 1500 feet in a North direction to a corner post marked No 4, thence 2400 feet in a West direction to a corner post marked No 5, thence 1500 feet in a South direction to a corner post marked No 6, thence 900 feet in a East direction to said end post no 2; hereby locating and intending to claim 1000 feet in a South direction from the discovery to the #2 post end line, and 500 feet in the opposite direction from discovery to the North end line and 1500 Ft. east and 900 ft west feet on each side of the middle of said lode or ledge, for the purpose of mining the same and claiming all surface rights, privileges, and minerals, with all dips, spurs, angles and variations, and other rights granted by existing laws and customs.

This claim is further described by reference to natural objects or permanent monuments, as follows:

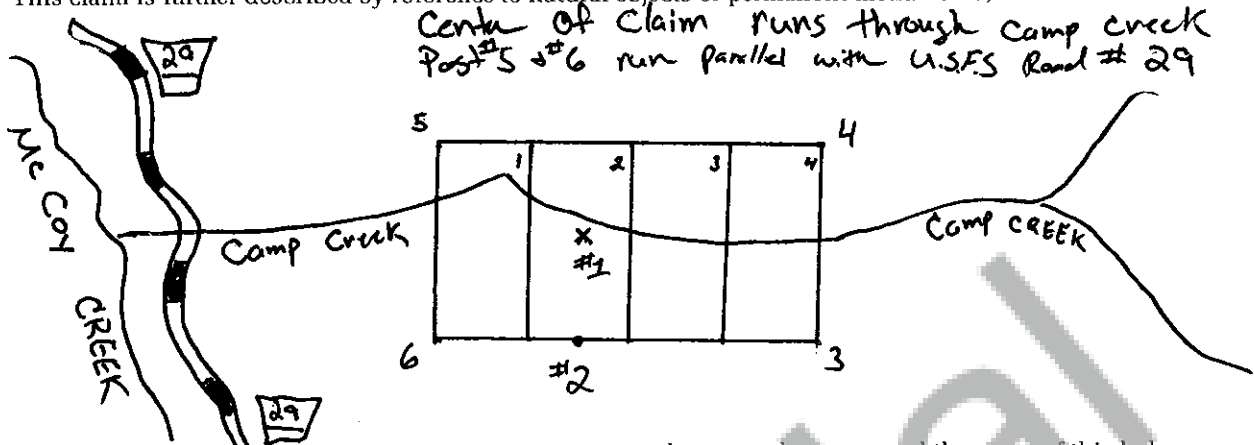

This notice is placed at Discovery on post No 1; posts are place at each corner, and the name of this lode, and date of location, are placed on all posts.

Located the 21 day of November, 2004.

Edwin Thompson

Dave Jeter

[Signature]

Locators.

WITNESSES:

STATE OF WASHINGTON

SS. (INDIVIDUAL ACKNOWLEDGEMENT)

County of Skamania

I, Edwin Thompson do solemnly swear that I am a citizen of the United States of America (or have declared my intention to become such) and that I am acquainted with the mining ground described in the notice of location, and herein called the Primary Gold # 1, 2, 3, 4 ~~Placer~~ Mining Claim; that the ground and claim herein described, or any part thereof, has not, to the best of my knowledge and belief, been located according to the laws of the United States and this State, or if so located, that the same has been abandoned or forfeited by reason of failure of such former locators to comply in respect thereto with the requirements of said laws; and that I have performed the equivalent of at least \$100.00 in labor on such claim and have complied with all applicable laws of this State pertaining to this claim.

Signed and sworn to before me on the 30th

day of December, 2004.

Print Name Peggy B. Lowry

Notary Public in and for the State of Washington

My appointment expires: 2/23/07

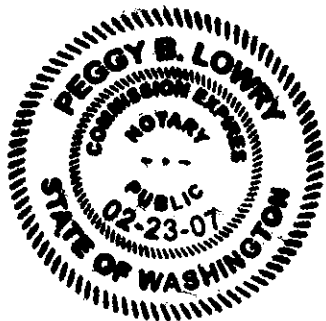

MAP OF CLAIMS

TOWNSHIP 10N RANGE 8E SECTION 10

TOWNSHIP 10N RANGE 8E SECTION 11

NW/NW	NE/NW	NW/NE	NE/NE	NW/NW	NE/NW	NW/NE	NE/NE								
SW/NW	SE/NW	SW/NE	SE/NE	SW/NW	SE/NW	SW/NE	SE/NE								
Sec. 10				Sec. 11											
NW/SW	NE/SW	NW/SE	NE/SE	NW/SW	NE/SW	NW/SE	NE/SE								
SW/SW	SE/SW	SW/SE	SE/SE	SW/SW	SE/SW	SW/SE	SE/SE								
<div style="border: 1px solid black; padding: 5px; width: fit-content; margin: auto;"> <p>5 4</p> <table border="1" style="width: 100%;"> <tr> <td>1</td><td>2</td><td>3</td><td>4</td></tr> <tr> <td colspan="2" style="text-align: center;">x1</td><td></td><td></td></tr> </table> <p>6 3</p> <p style="text-align: center;">2</p> </div>				1	2	3	4	x1							
1	2	3	4												
x1															
NW/NW	NE/NW	NW/NE	NE/NE	NW/NW	NE/NW	NW/NE	NE/NE								
SW/NW	SE/NW	SW/NE	SE/NE	SW/NW	SE/NW	SW/NE	SE/NE								
Sec. 15				Sec. 14											
NW/SW	NE/SW	NW/SE	NE/SE	NW/SW	NE/SW	NW/SE	NE/SE								
SW/SW	SE/SW	SW/SE	SE/SE	SW/SW	SE/SW	SW/SE	SE/SE								

TOWNSHIP 10N RANGE 8E SECTION 15

TOWNSHIP 10N RANGE 8E SECTION 14

WHEN DRAWING YOUR CLAIMS, USE AN ORDINARY RULER.
THE PLAT SCALE : 1/6=100'

DOC # 2004155783
Page 3 of 3

OR-3832-2
(June 2004)