

Doc # 2004155475  
Page 1 of 2  
Date: 12/02/2004 11:54A  
Filed by: USDA FOREST SERVICE  
Filed & Recorded in Official Records  
of SKAMANIA COUNTY  
J. MICHAEL GARVISON  
AUDITOR  
Fee: \$0.00

## LAND CORNER RECORD

**GRANTOR/SURVEYOR/PUBLIC OFFICER:** This corner record correctly represents work performed by me or under my direction, in conformance with the Survey Recording Act.

**COMPANY OR AGENCY:** USDA Forest Service  
Gifford Pinchot National Forest  
10600 NE 51<sup>st</sup> Circle  
**ADDRESS:** Vancouver WA 98682



Don Karsch 9/01/2004  
Forest Land Surveyor Date

**GRANTEE:** PUBLIC **SEAL/SIGNATURE/DATE**  
**LEGAL:** SE 1/16 S23 TWP: 4 NORTH RGE: 7 EAST **CORNER CODE:** Q20

**ADDITIONAL IDENTIFIER:** BLM designation, street, or plat names, block, lot, etc.

**COUNTY:** SKAMANIA

**WASHINGTON PLANE COORDINATES:** N: E:

**ORDER:** **ZONE:** **DATUM:** (DATE OF ADJUSTMENT):

**CORNER INFORMATION:** Discuss the history, evidence found, and perpetuation of the corner. Diagram the references; provide the date of work; and if applicable, a reference to a map of record and/or the field book/page no. Use the back, if needed.

### Corner History:

This corner was originally established by Roy Gaylord, in 1981. He set a 5/8" iron rod at the corner point. This position was accepted by the BLM in 1982, and remonumented by them with 2 1/4" aluminum cap. They also tagged, painted, and scribed two bearing trees:

- A 10" Douglas Fir - N49°E, 23.5 links, scribed "SE 1/16 S23 BT".
- A 10" Douglas Fir - S55°E, 81.5 links, scribed "SE 1/16 S23 BT."

On August 18, 2004 I found the corner monument in good condition 6" below the ground.

### Found BT's:

A 10" Douglas fir dead snag bears N49°E, 15.51 ft. Overgrown face blaze visible.

### New BT's established:

A 10" Hemlock bearing N22°W, 8.0 ft. scribed "X", "X BT". Placed washer in tree face, and nail at side center.

Placed "BT" tag and "Land Survey Monument" signs on all BT's.

Forest service property lines leading north and east from corner are brushed, blazed, painted, and posted w/USFS carsonite posts. Bearings are by compass w/18° East declination. Distances are to side center nail in each bearing tree.

Witnessed by: Georgene Wheatley, LSIT #74341

MARK THE CORNER LOCATION BELOW AND FILL IN THE CORNER CODE BLANK ON THE OTHER SIDE:  
For corners at the intersection of two lines, the corner code is the alphanumeric coordinate that corresponds to the appropriate intersection of lines.

For corners that are only on one line, the corner code is the line designation and the related line segment; i.e., a corner on line 5 between 'B' and 'C' is designated BC-5.

For corners that are between lines, the corner code is both line segments; i.e., a corner in the SE1/4 of the SE1/4 of section 18 is designated MN 4-5.

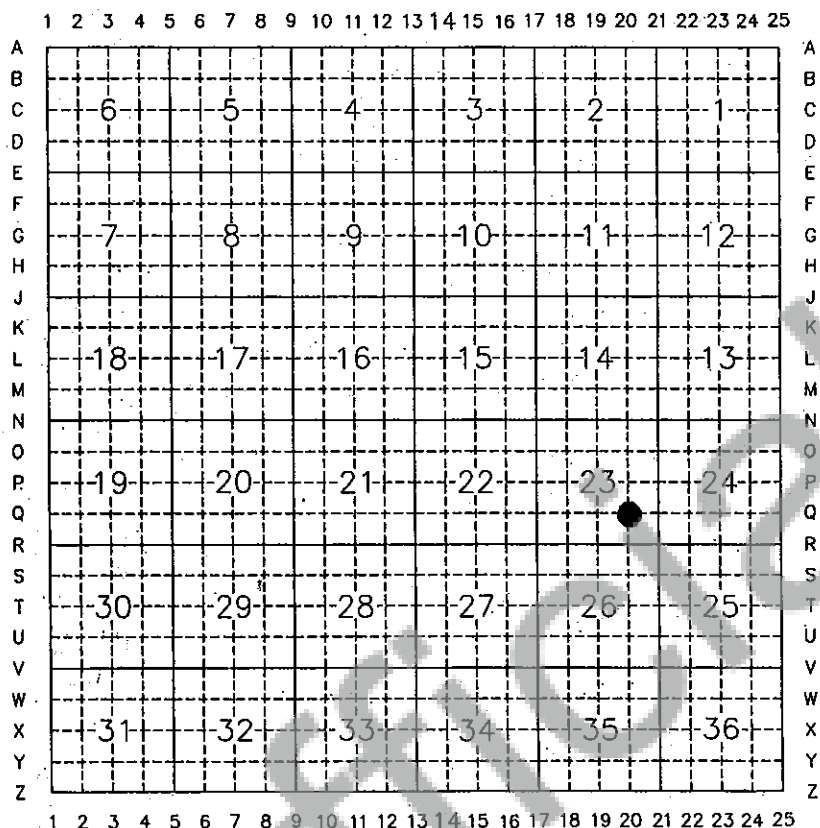

RCW 58.09.060 (2) requires the following information on this form: an accurate description and location, in reference to the corner position, of all monuments and accessories (a) found at the corner and (b) placed or replaced at the corner; (c) basis of bearings used to describe or locate such monuments or accessories; and (d) corollary information that may be helpful to relocate or identify the corner position.

SPACE FOR ADDITIONAL COMMENT:

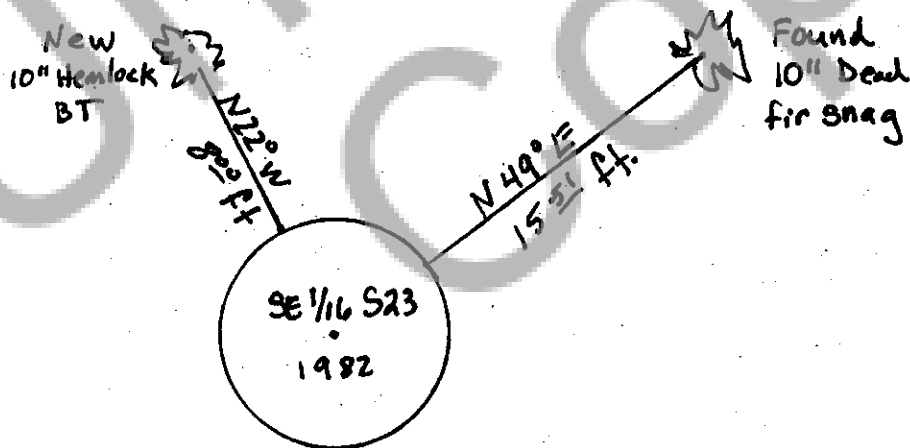

Found 2 1/2" x 30" aluminum pipe w/a 2 1/2" aluminum cap in good condition 6" below the ground.