

Doc # 2004155474  
Page 1 of 2  
Date: 12/02/2004 11:53A  
Filed by: USDA FOREST SERVICE  
Filed & Recorded in Official Records  
of SKAMANIA COUNTY  
J. MICHAEL GARVISON  
AUDITOR  
Fee: \$0.00

## LAND CORNER RECORD

**GRANTOR/SURVEYOR/PUBLIC OFFICER:** This corner record correctly represents work performed by me or under my direction, in conformance with the Survey Recording Act.

**COMPANY OR AGENCY:** USDA Forest Service  
Gifford Pinchot National Forest  
10600 NE 51<sup>st</sup> Circle  
**ADDRESS:** Vancouver WA 98682

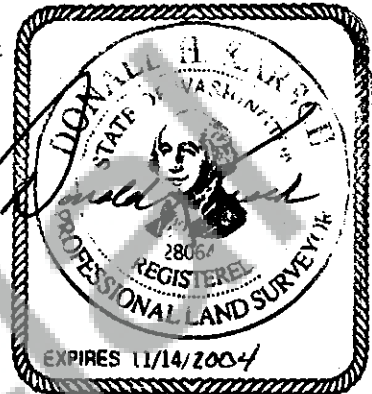

Don Karsch 9/01/2004  
Forest Land Surveyor Date

**GRANTEE: PUBLIC** **SEAL/SIGNATURE/DATE**  
**LEGAL:** CEWW 1/256 S14 **TWP:** 4 NORTH **RGE:** 7 EAST **CORNER CODE:** L17.75

**ADDITIONAL IDENTIFIER:** BLM designation, street, or plat names, block, lot, etc.

**COUNTY:** SKAMANIA

**WASHINGTON PLANE COORDINATES:** N: E:

**ORDER:** **ZONE:** **DATUM:** (DATE OF ADJUSTMENT):  
**CORNER INFORMATION:** Discuss the history, evidence found, and perpetuation of the corner. Diagram the references; provide the date of work; and if applicable, a reference to a map of record and/or the field book/page no. Use the back, if needed.

### Corner History:

This corner was originally established by Roy Gaylord, PLS# 18731, in July of 1983. He set a 2 1/2" by 30" aluminum pipe with a 2 1/2" aluminum cap. He also tagged, painted, and scribed two bearing trees:

- An 18" Douglas Fir - N67°W, 13.4'.
- A 14" Douglas Fir - N44°E, 5.0'.

On July 14, 2004 I found the corner monument, set 12" above ground, in good condition. The corner sits on the north edge of a reprod unit and the SW edge of a 2<sup>nd</sup> growth stand.

### Found BT's:

Both BT's found fallen, disturbed and out of position. A two foot chain sawed portion of each bearing tree showed visible face scribe.

- 14" Douglas Fir section found N20°E.
- 16" Douglas Fir section found N60°W with BT tag and attention sign.

### New BT's established:

- A 7" Hemlock bearing N34°W, 14.3 ft. scribed "X BT."
- An 18.5" Douglas Fir bearing N48°E, 26.5 ft. scribed "S14 1/256 BT."

Placed "BT" tags and "Land Survey Monument" signs on BT's; as well as, washers in tree faces, and nails at the side center.

Forest service property lines leading north and east from corner are brushed, blazed, painted, and posted w/USFS carsonite posts. Bearings are by compass w/18° East declination. Distances are to side center nail in each bearing tree.

Witnessed by: Georgene Wheatley, LSIT #74341

MARK THE CORNER LOCATION BELOW AND FILL IN THE CORNER CODE BLANK ON THE OTHER SIDE.  
 For corners at the intersection of two lines, the corner code is the alphanumeric coordinate that corresponds to the appropriate intersection of lines.

For corners that are only on one line, the corner code is the line designation and the related line segment; i.e., a corner on line 5 between 'B' and 'C' is designated BC-5.

For corners that are between lines, the corner code is both line segments; i.e., a corner in the SE1/4 of the SE1/4 of section 18 is designated MN 4-5.

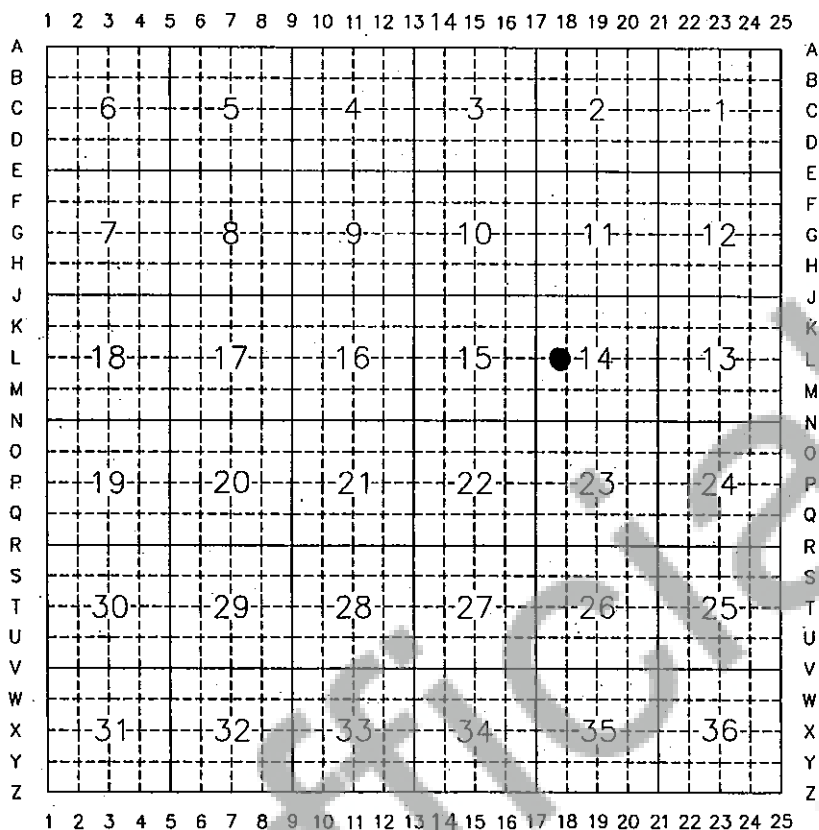

RCW 58.09.060 (2) requires the following information on this form: an accurate description and location, in reference to the corner position, of all monuments and accessories (a) found at the corner and (b) placed or replaced at the corner; (c) basis of bearings used to describe or locate such monuments or accessories; and (d) corollary information that may be helpful to relocate or identify the corner position.

SPACE FOR ADDITIONAL COMMENT:

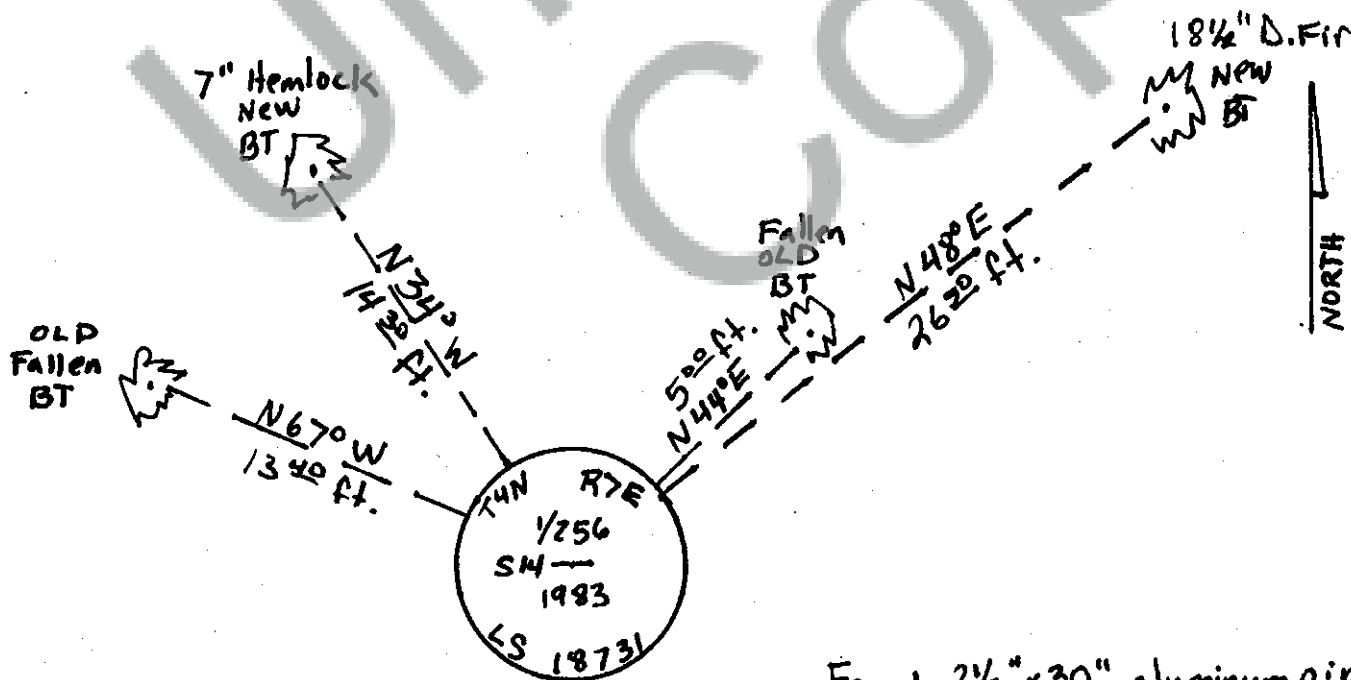

Found 2 1/2" x 30" aluminum pipe w/ a 2 1/2" aluminum cap set 12" above ground in good condition.