

AMENDED TO SHOW THE FENCE  
ALONG THE NORTH LINE OF TL 1400  
AMENDS RECORD OF SURVEY  
RECORDED IN AF #2004153048

Position of 3/4" iron pipe with brass cap "OLSON" as shown on SR #3 and #4

S89°24'03"E 2668.21'

24819

19

-Court Order  
No. 00 2 00065 2  
(March 10, 2003)

N04°E 29.5'  
fence corner

WIEMKEN  
TL 1400  
Bk 128, Pg 434

WIEMKEN  
TL 1400  
128, Pg

A 4x4 grid with a 2x2 shaded square in the center. A circle with '30' is at row 2, column 2, and a circle with '18' is at row 2, column 3.

1. Lawson Survey: Book 39, Page 176
2. Lawson Survey: Book 38, Page 132
3. Lawson Survey: Book 2, Page 276
4. Lawson Survey: Book 2, Page 211
5. Glaeser Survey: Book 3, Page 92
6. Lawson Survey: Book 38, Page 169

- Set 1/2" x 24" iron rod with yellow plastic cap stamped "LAWSON 11989"
- Found existing monument (as noted)
- Calculated point (not set)

LOR Land Corner Record  
ROS Record of Survey  
ROW Right of way  
SR Survey reference  
TL Tax Lot

S89°32'36"E 2627.16'

as shown on SK #6  
(LCR Bk 12, Pg 01)

30

AUDITOR'S CERTIFICATE

This man correctly represents a survey made

NO. 20071030001,  
Lawson Land Services, Inc.

Gregory A. Smith  
DEPUTY COUNTY AUDITOR

John G. Lawson, PLS

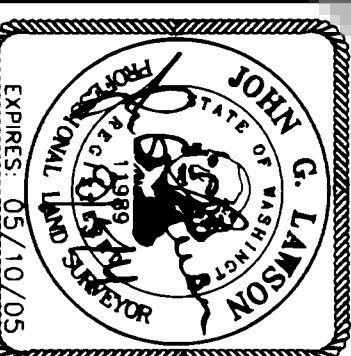

**LAWSON LAND SERVICES INC.**  
113 South Parkway Avenue  
Battle Ground, WA 98604 (360) 687-0500

K:\04-008\dwg\040

K:\04-008\dwg\040