

Doc # 2004153720
Page 1 of 2
Date: 07/15/2004 09:53A
Filed by: RAMONA A BENNETT
Filed & Recorded in Official Records
of SKAMANIA COUNTY
J. MICHAEL GARVISON
AUDITOR
Fee: \$20.00

AFTER RECORDING MAIL TO:

REAL ESTATE EXCISE TAX

Name MARGARET R. TURNER
Address P.O. Box 981
City/State WASHOUGAL, WA 98671

24047
JUL 14 2004

PAID EXEMPT

Auditor's Return

SKAMANIA COUNTY TREASURER

Quit Claim Deed

Boundary Line Adjustment

THE GRANTOR MARGARET R TURNER

for and consideration of 4000

conveys and quit claims to RAMONA A. BENNETT

the following described real estate, situated in the County of SKAMANIA, State of Washington,
together with all after acquired title of the grantor(s) therein:

See EXHIBIT A

This description constitutes a boundary line adjustment between adjoining property owned by the grantors and does not create a separate parcel and is therefore exempt from requirements of RCW 58.17 and the Skamania County Short Plat Ordinance. The property described in this document cannot be segregated and sold without conforming to the State of Washington and Skamania County Subdivision Laws.

Assessor's Property Tax Parcel / Account Number(s): 2-5-31-2-703 PT of
7-14-04 FM 200 PT of

Dated July 13, 2004 Transaction in compliance with County and Division ordinances.
By MJM 7-14-04

Margaret R. Turner

STATE OF Washington ss.

COUNTY OF Clark

Notary Public
State of Washington
CAROL A. LACKEY
My Appointment Expires Jan 15, 2006

On this day personally appeared before me Margaret R. Turner

and who executed the within and foregoing instrument, to me known to be the individual(s) described in
same as her free and voluntary act and deed, and acknowledged that She signed the
for the purposes therein mentioned.

Given under my hand and official seal this 13 day of July, 2004.

Carol A. Lackey
Notary Public in and for the State of Washington
residing at Washougal. My commission expires 01-15-06.

EXHIBIT 'A'
Boundary adjustment to Lot 4, Baars Short Plat

A parcel of land located within the NW¼ Section 31, Township 2 North, Range 5 East, W.M., in Skamania County, State of Washington and being a portion of Lot 4 of the Baars Short Plat as shown on the map thereof recorded November 6, 2001 in Book 3 at Page 396 of Short Plats, AF#142832, and of Lot 4 of the Amended Turner Short Plat as shown on the map thereof recorded December 10, 1999 in Book 3 at Page 359 of Short Plats, AF#137007, and described more particularly as follows:

Commencing at the Northwest 1/16 corner of said Section 31, thence N 00°47'16" W, 39.68 feet to point on the common line of said short plat lots and the point of beginning; thence along the following courses: S 78°39'33" W, 93.56 feet; N 56°02'49" W, 76.97 feet; N 62°45'40" W, 53.44 feet; S 22°58'20" W, 11.59 feet; S 38°54'43" W, 37.70 feet; S 40°53'39" W, 42.37 feet; S 07°59'35" E, 49.88 feet; S 26°18'37" E, 18.94 feet; S 27°49'27" E, 83.59 feet; S 52°04'54" E, 139.39 feet; N 89°12'44" E, 99.75 feet; thence on said last line extended, N 89°12'44" E, 20.95 feet to the center of a creek; thence along the centerline of said creek through the following courses: N 25°48'22" W, 23.01 feet; N 41°03'09" W, 36.82 feet; N 10°07'06" W, 17.12 feet; N 13°26'04" W, 18.39 feet; N 11°09'06" E, 27.65 feet; N 06°54'01" E, 16.38 feet; N 03°50'47" W, 16.89 feet; N 32°24'55" E, 15.83 feet; N 56°28'06" E, 11.52 feet; thence leaving said creek, S 34°40'20" E, 84.92 feet; thence N 87°58'25" E, 25 feet; thence N 37°27'13" E, 155.80 feet; thence N 32°36'11" W, 229.43 feet; thence S 35°20'30" W, 94.00 feet; thence S 00°47'16" E, 87.25 feet to the point of beginning; TOGETHER WITH an exclusive easement for a well and protective area of 100 foot radius centered over said well head.

Containing 2.00±Ac. by calculation.

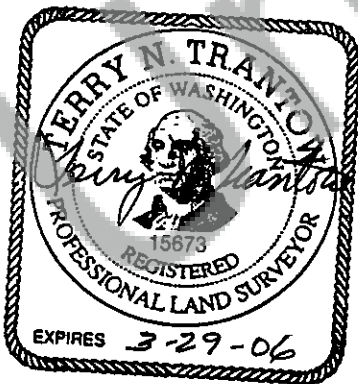

6 July 2004
Terry N. Trantow, PLS

MJM ✓
2-5-31-2-703 PT of
200 PT of
7-14-04
CMM