

Doc # 2004153255  
 Page 1 of 2  
 Date: 06/07/2004 10:43A  
 Filed by: GENERAL PUBLIC  
 Filed & Recorded in Official Records  
 of SKAMANIA COUNTY  
 J. MICHAEL GARVISON  
 AUDITOR  
 Fee: \$20.00

Return Address:

Charles F. Widmer Sr.  
 22005 Zenker Vly. Rd. S.W.  
 Centralia, Wa. 98531

**NOTICE OF MINING LOCATION**

Indexing information required by the Washington State Auditor's/Recorder's Office, (RCW 36.18 and RCW 85.04) 1/97: (please print last name first)

Reference # (If applicable): \_\_\_\_\_

Owner: (1) Widmer, Charles F. Sr. (2) Widmer, Carol A. Addl. on pg 2

Addl. on page \_\_\_\_\_ Legal Description (abbreviated): Section 15 T10N R8E S1/2 SW, SE, Y4

Addl. legal is on page \_\_\_\_\_ Assessor's Property Tax Parcel /Account # \_\_\_\_\_

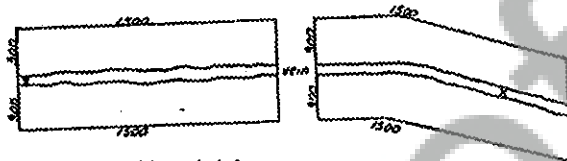

This diagram explains method of description of claim.

State of Washington  
 County of Skamania  
 (or Recording Precinct)  
McCoy Creek  
 Mining District

NOTICE IS HEREBY GIVEN That the undersigned who is/are (has/declared \_\_\_\_\_ intention to become) citizen S of the United States, have discovered and have located and claimed and do hereby locate 660' linear feet in length, and 1320' feet in width on the \_\_\_\_\_ Highlands Placer Lode, vein ledge or deposit (or placer ground), situated in the above State, County (or Recording Precinct) and Mining District, and further described as follows: Commencing at a post marked No 1 at the Discovery shaft (cut or tunnel), from thence 660 feet in a S. Westerly direction to an end post marked No 2, thence 660 feet in a North direction to a corner post marked No 3, thence 1320 feet in a East direction to a corner post marked No 4, thence 660 feet in a South direction to a corner post marked No 5, thence \_\_\_\_\_ feet in a \_\_\_\_\_ direction to a corner post marked No 6, thence 660 feet in a N. Westerly direction to said end post no 2; hereby locating and intending to claim 100 feet in a South direction from the discovery to the South end line, and 660 feet in the opposite direction from discovery to the North end line and 660 feet on each side of the middle of said lode or ledge, for the purpose of mining the same and claiming all surface rights, privileges, and minerals, with all dips, spurs, angles and variations, and other rights granted by existing laws and customs.

This claim is further described by reference to natural objects or permanent monuments, as follows:

South Half of the S.W.S.E. 1/4 Section 15 T.10N. R.8E.

This notice is placed at Discovery on post No 1; posts are placed at each corner, and the name of this lode, and date of location, are placed on all posts.

Located the 28<sup>th</sup> day of May 2004.

Charles F. Widmer Jr.

Christopher A. Widmer

Locators.

WITNESSES:

STATE OF WASHINGTON

SS. (INDIVIDUAL ACKNOWLEDGEMENT)

County of \_\_\_\_\_

I, \_\_\_\_\_ do solemnly swear that I am a citizen of the United States of America (or have declared my intention to become such) and that I am acquainted with the mining ground described in the notice of location, and herein called the \_\_\_\_\_ Placer Mining Claim; that the ground and claim herein described, or any part thereof, has not, to the best of my knowledge and belief, been located according to the laws of the United States and this State, or if so located, that the same has been abandoned or forfeited by reason of failure of such former locators to comply in respect thereto with the requirements of said laws; and that I have performed the equivalent of at least \$100.00 in labor on such claim and have complied with all applicable laws of this State pertaining to this claim.

Signed and sworn to before me on the \_\_\_\_\_ day of \_\_\_\_\_,

Print Name \_\_\_\_\_

Notary Public in and for the State of \_\_\_\_\_

My appointment expires: \_\_\_\_\_

Signature of Claimant Charles Wideman Sr. date 6-7-04

MAP of Mining Claim(s)

Township 10N Range 8E Section 15 State of Washington

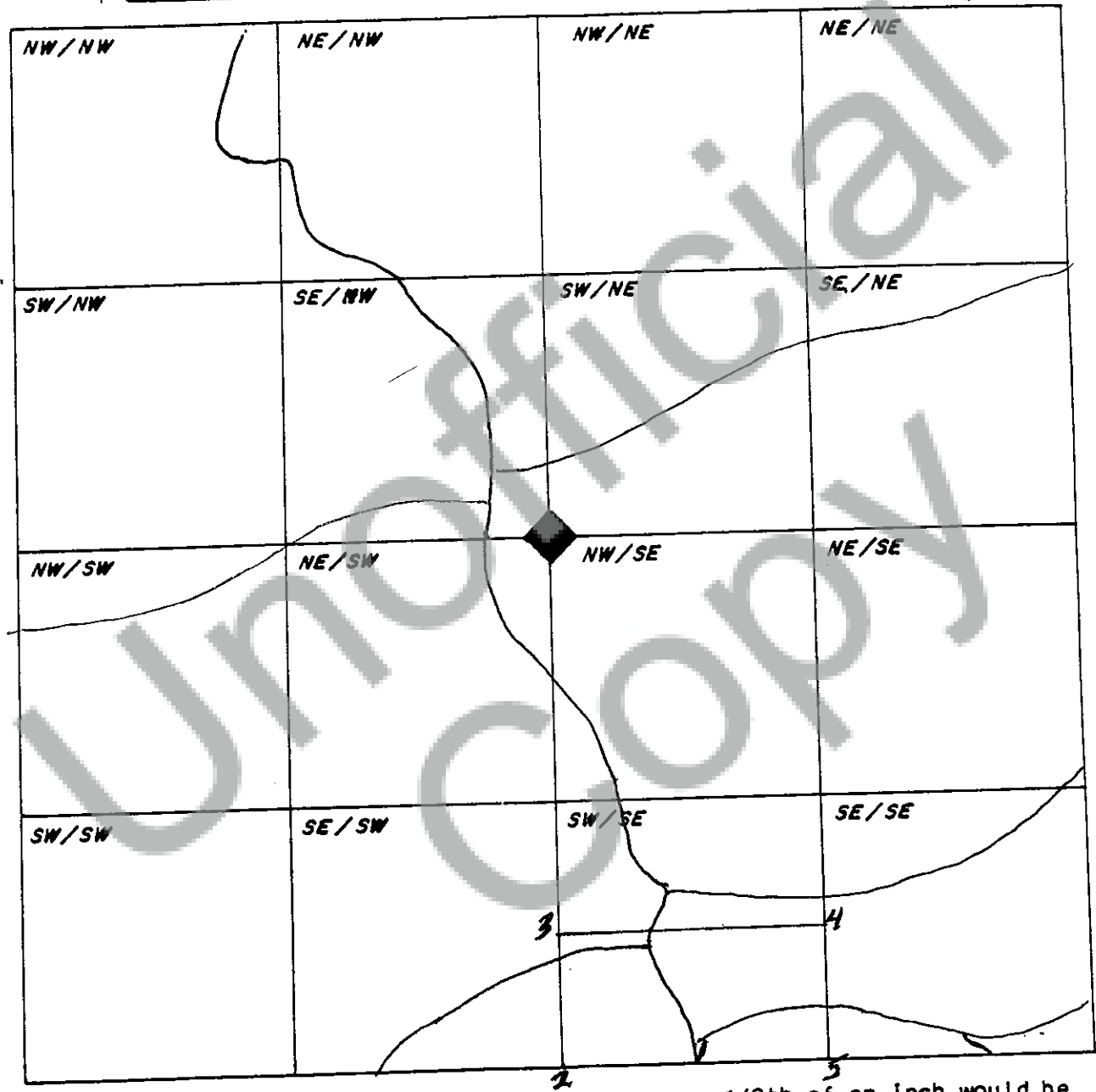

When drawing your claim(s) use an ordinary ruler. 1/8th of an inch would be 100 feet so a full size lode (600' x 1500') would be 3/4" by 1 7/8". A full size placer (1320' x 660') would be 1 5/8" by 13/16".