

Doc # 2004152508
Page 1 of 1
Date: 04/07/2004 12:32P
Filed by: BELL DESIGN COMPANY
Filed & Recorded in Official Records
of SKAMANIA COUNTY
J. MICHAEL GARVISON
AUDITOR
Fee: \$0.00

LAND CORNER RECORD

GRANTOR/SURVEYOR/PUBLIC OFFICER: This corner record correctly represents work performed by me or under my direction in conformance with the Survey Recording Act.

COMPANY OR AGENCY: BELL DESIGN COMPANY

ADDRESS: P.O.Box 308
BINGEN, WA. 98605

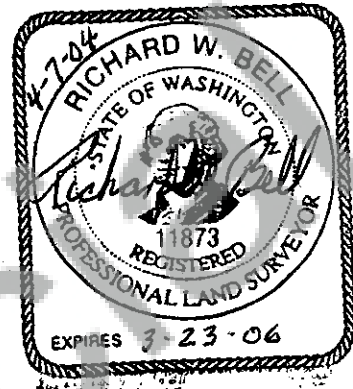

GRANTEE: PUBLIC

SEAL/SIGNATURE/DATE

LEGAL: TWP: 4 North RGE: 7 East CORNER CODE: 16-17/L-M

ADDITIONAL IDENTIFIER: (BLM designation, street or plat names, block, lot, etc.)

Southeast corner of Lot 2 Sylvia SHORT PLAT, AFN. 150799
located in the NE1/4 of SE1/4 of Section 15.

COUNTY: SKAMANIA COUNTY

WASHINGTON PLANE COORDINATES: N: E:

ORDER: ZONE: DATUM (Date of adjustment):

CORNER INFORMATION: Discuss the history, evidence found, and perpetuation of the corner. Diagram the references; provide the date of work; and, if applicable, a reference to a map of record and/or the field book/page no. Use the back, if needed.

HISTORY:

Trantow Surveying, INC. set a 5/5" X 30" iron rod with a red plastic stamped "TRANTOW 15673" for the southeast corner of Lot 2 of Sylvia Short Plat as per recorded short plat dated October 2003.

EVIDENCE FOUND:

No evidence of the iron rod was found. Found the most southerly corner of Lot 4 of Sylvia Short Plat and the NE corner of said Lot 2 as described in Sylvia SHORT PLAT. Found distance to be 445.23 feet between the two found corners. The calculated distance derived from the Short Plat map is 445.13 feet. The calculated plat distance for the east line of Lot 2 is 277.77 feet.

PERPETUATION OF CORNER:

Reset SE corner of Lot 2 with a 5/8" diameter x 30" rebar topped with a yellow plastic surveyors cap inscribed "BELL DESIGN 11873" at a distance of 167.40 feet from said Southerly corner of Lot 4 and 277.83 feet from said NW corner of said Lot 2 on a straight line between the two found corners.

Set two reference points for reset corner:

A nail set in the center of a 24" diameter Fir stump bears N15° E 20.34 feet from reset corner.
A nail set in the north side of the base of a 7" diameter Cottonwood bears N 62° W 24.75 feet from reset corner.

This form is in compliance with the intent of RCW 65.04.045 and prescribed by the Public Land Survey Office, Department of Natural Resources - 1/97.