

147282

BOOK 235 PAGE 661

FILED
ST
BY Sherm Smith

JAN 16 11 37 AM '03

O'Leary
J. MICHAEL JOHNSON

Return Address:

Sherm Smith
1486 Centralia Alpha Rd.
Chehalis, Wash. 98532

NOTICE OF MINING LOCATION

Indexing information required by the Washington State Auditor's/Recorder's Office, (RCW 36.10 and RCW 65.04) 1/97: (please print last name first)

Reference # (if applicable): Sect. 22, T10N, R8E

Owner: (1) Sherm Smith (2) _____ Add'l. on pg _____

Add'l. on page _____ Legal Description (abbreviated): _____

Add'l. legal is on page _____ Assessor's Property Tax Parcel /Account # _____

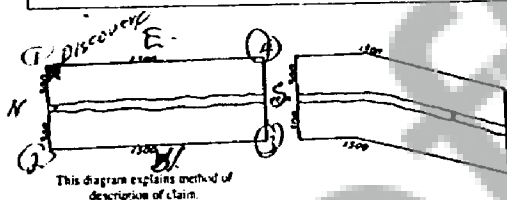

State of Washington

County of Skamania

(or Recording Precinct)

Mining District McCoy

NOTICE IS HEREBY GIVEN That the undersigned who is/are (has declared intention to become) citizen _____ of the United States, has discovered and has located and claimed and does hereby locate _____ linear feet in length, and _____ feet in width on the Bad Day (Lode) vein

West ledge or deposit (or placer ground), situated in the above State, County (or Recording Precinct) and Mining District, and further described as follows: Commencing at a post marked No 1 at the Discovery shaft (cut or tunnel), from thence West 600 feet in a West direction to an end post marked No 2, thence 1500 feet in a South direction to a corner post marked No 3, thence 600 feet in a East direction to a corner post marked No 4, thence 1500 feet in a North direction to a corner post marked No 6, thence _____ feet in a _____ direction to a corner post marked No 6, thence _____ feet in a _____ direction to said end post no 2; hereby locating and intending to claim 600 feet in a WEST direction from the discovery to the WEST end line, and South 1600 feet in the opposite direction from discovery to the South end line and 600 EAST - 1600 NORTH feet on each side of the middle of said lode or ledge, for the purpose of mining the same and claiming all surface rights, privileges, and minerals, with all dips, spurs, angles and variations, and other rights granted by existing laws and customs.



Notice of Mining Location
©Washington Legal Blank, Inc., Issaquah, WA. Form No. 284D 1/97
MATERIAL MAY NOT BE REPRODUCED IN WHOLE OR IN PART IN ANY FORM WHATSOEVER.

BOOK 235 PAGE 662

This claim is further described by reference to natural objects or permanent monuments, as follows:

This notice is placed at Discovery on post No 1; posts are placed at each corner, and the name of this lode, and date of location, are placed on all posts.

Located the 14th day of January 2003

Sherman Smith

WITNESSES:

Locators.

STATE OF WASHINGTON

County of Skamania

SS. (INDIVIDUAL ACKNOWLEDGEMENT)

I, Sherman Smith do solemnly swear that I am a citizen of the United States of America (or have declared my intention to become such) and that I am acquainted with the mining ground described in the notice of location, and herein called the Bad Day West Mining Claim; that the ground and claim herein described, or any part thereof, has not, to the best of my knowledge and belief, been located according to the laws of the United States and this State, or if so located, that the same has been abandoned or forfeited by reason of failure of such former locators to comply in respect thereto with the requirements of said laws; and that I have performed the equivalent of at least \$100.00 in labor on such claim and have complied with all applicable laws of this State pertaining to this claim.

Signed and sworn to before me on the

16th

day of

January 2003

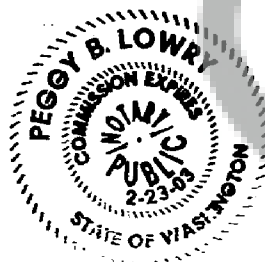

Print Name

Peggy B. Lowry

Notary Public in and for the State of

Washington

My appointment expires:

2/23/03

Signature of Claimant Norm Smith date 1-14-03

MAP of Mining Claim(s)

Township 10N Range 8E Section 22 State of WA

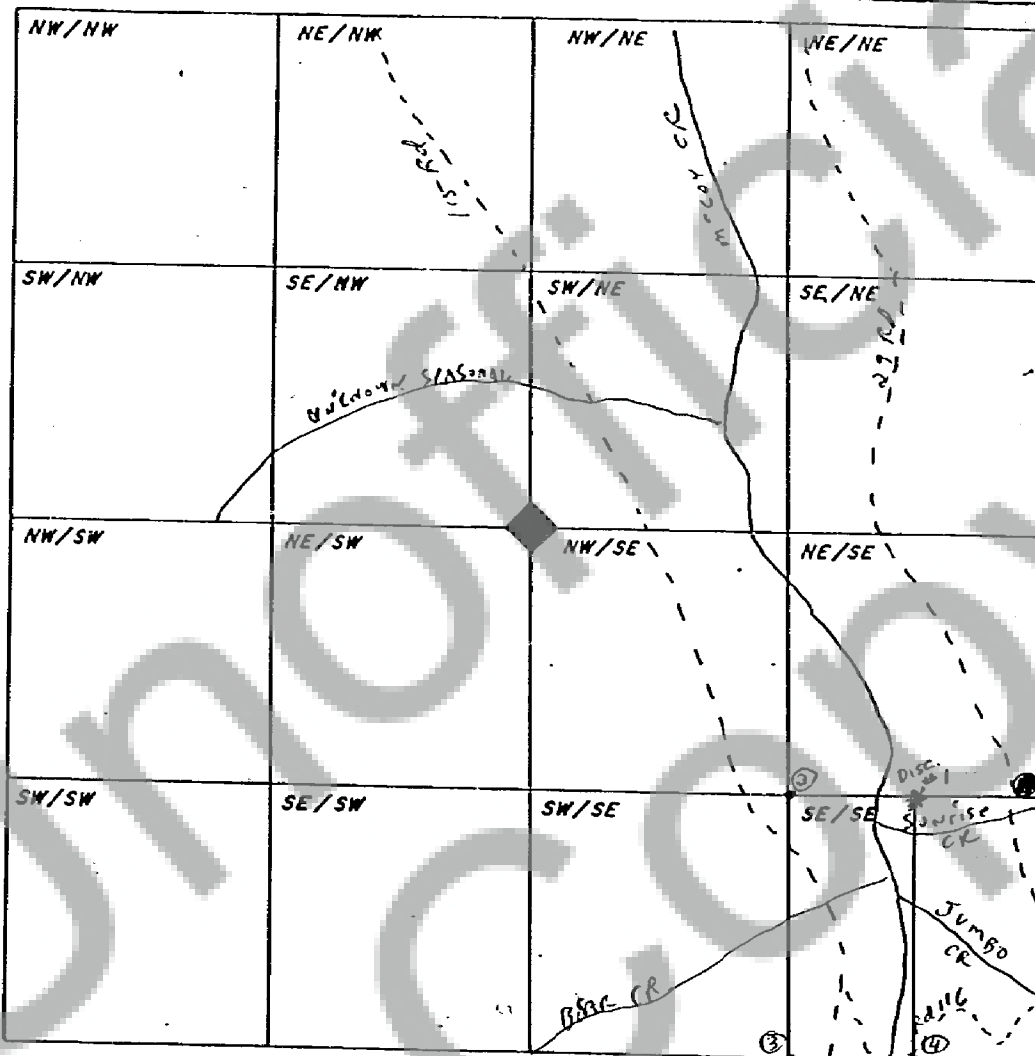

When drawing your claim(s) use an ordinary ruler. 1/8th of an inch would be 100 feet so a full size lode (600' x 1500') would be 3/4" by 1 7/8". A full size placer (1320' x 660') would be 1 5/8" by 13/16".