

#2 142696

BOOK 216 PAGE 30



FILE
SK
Paul Mattila
Oct 24 10 51 AM '01
Glowry
GARY N. OLSON

Return Address:

PAMA ENTERPRISES
15632 N.E. Lucia Falls Rd.
Battle Ground, WA 98604 360-687-3563

NOTICE OF MINING LOCATION

Indexing information required by the Washington State Auditor's/Recorder's Office, (RCW 38.18 and RCW 53.04) 1/97: (please print last name first)

Reference # (If applicable): Claim # 2

Owner: (1) Paul Mattila (2) _____ A 141 on pg _____

Addl. on page 2 Legal Description (abbreviated): Sec 7-T9U-R5E-SE 4 of SW 1/4 see map

Addl. legal is on page 2 Assessor's Property Tax Parcel /Account # _____

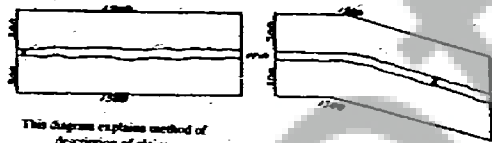

This diagram explains method of description of claims.

State of Washington
County of Stromahia
(or Recording Precinct) Ht Adams
Mining District

NOTICE IS HEREBY GIVEN That the undersigned who Pare (has declared intention to become) citizen of the United States, has 5 discovered and has 5 located and claimed and do hereby locate 1500 linear feet in length, and 600 feet in width on the Volcanic Ryolite Madok #2 Lode, vein ledge or deposit (or placer ground), situated in the above State, County (or Recording Precinct) and Mining District, and further described as follows: Commencing at a post marked No 1 at the Discovery shaft (cut or tunnel), from thence 1500 feet in a SW direction to an end post marked No 2, thence 600 feet in a NW direction to a corner post marked No 3, thence 1500 feet in a NE direction to a corner post marked No 4, thence 600 feet in a SE direction to a corner post marked No 5, thence _____ feet in a _____ direction to a corner post marked No 6, locating and intending to claim _____ feet in a _____ direction to said end post no 2; hereby the discovery to the _____ end line, and _____ direction from discovery to the _____ end line and _____ feet in the opposite feet on each side of the middle of said lode or ledge, for the purpose of mining the same and claiming all surface rights, privileges, and minerals, with all dips, spurs, angles and variations, and other rights granted by existing laws and customs.

see map

note - Claim measured from E corner clockwise
Vein over broad area - see map - discovery points



Notice of Mining Location
©Washington Legal Blank, Inc., Issaquah, WA Form No. 284D 1/97
MATERIAL MAY NOT BE REPRODUCED IN WHOLE OR IN PART IN ANY FORM WHATSOEVER.

This claim is further described by reference to natural objects or permanent monuments, as follows:

NE Slope of Clearwater Butte

This notice is placed at Discovery on post No 1; posts are place at each corner, and the name of this lode, and date of location, are placed on all posts.

Located the 10 day of 9, 01.

Paul Mottila

WITNESSES:

Locators.

STATE OF WASHINGTON

SS. (INDIVIDUAL ACKNOWLEDGEMENT)

County of CLARK

Paul Mottila

do solemnly swear that I am a citizen of the United States of America (or have declared my intention to become such) and that I am acquainted with the mining ground described in the notice of location, and herein called the Mobak Mine #2 Lode Place Mining Claim; that the ground and claim herein described, or any part thereof, has not, to the best of my knowledge and belief, been located according to the laws of the United States and this State, or if so located, that the same has been abandoned or forfeited by reason of failure of such former locators to comply in respect thereto with the requirements of said laws; and that I have performed the equivalent of at least \$100.00 in labor on such claim and have complied with all applicable laws of this State pertaining to this claim.

Paul Mottila

Signed and sworn to before me on the 23rd day of October, 2001



Print Name

Notary Public in and for the State of

My appointment expires:

03-09-2002

↑
S
Mining Claims
Diagram

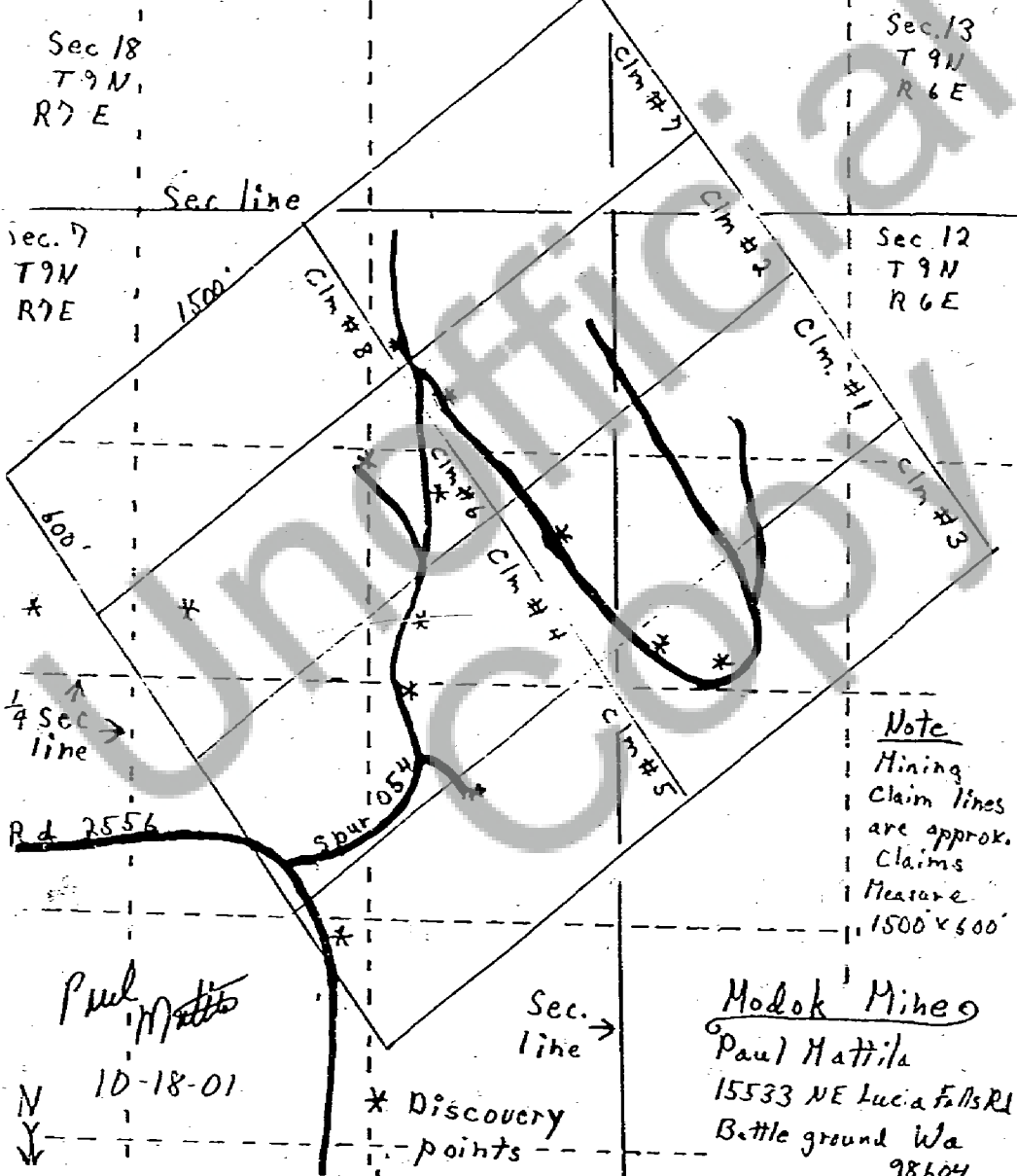

This claim is further described by reference to natural objects or permanent monuments, as follows:

NE Slope of Clearwater Butte

This notice is placed at Discovery on post No 1; posts are place at each corner, and the name of this lode, and date of location, are placed on all posts.

Located the 10 day of 9 01

Paul Mattila

WITNESSES:

Locators.

STATE OF WASHINGTON

SS. (INDIVIDUAL ACKNOWLEDGEMENT)

County of CLARK

I, Paul Mattila do solemnly swear that I am a citizen of the United States of America (or have declared my intention to become such) and that I am acquainted with the mining ground described in the notice of location, and herein called the Good Hope Mine #3 Lode Placer Mining Claim; that the ground and claim herein described, or any part thereof, has not, to the best of my knowledge and belief, been located according to the laws of the United States and this State, or if so located, that the same has been abandoned or forfeited by reason of failure of such former locators to comply in respect thereto with the requirements of said laws; and that I have performed the equivalent of at least \$100.00 in labor on such claim and have complied with all applicable laws of this State pertaining to this claim.

Signed and sworn to before me on the 23rd day of OCTOBER 2001



Print Name ANTHONY J. RIENTIG

Notary Public in and for the State of WASH

My appointment expires: 03-09-2002

