

141755

BOOK 212, PAGE 605

RETURN ADDRESS

Skamania County Dept. of Public Works
P.O. Box 790
Stevenson, Wa. 98648

FILED FOR RECORD
SKAMANIA CO. WASH
BY *Public Works*

JUL 20 11 57 AM '01

Olson
AUDITOR
GARY M. OLSON

Please Print or Type Information.

Document Title(s) or transaction contained therein:

1. Skamania County Dept. of Planning and Community Development - Administrative Decision
- 2.
- 3.
- 4.

GRANTOR(S) (Last name, first, then first name and initials)

1. Skamania County Dept. of Public Works
- 2.
- 3.
- 4.

☐ Additional Names on Page _____ of document.

GRANTEE(S) (Last name, first, then first name and initials)

1. Skamania County Dept. of Planning and Community Development
- 2.
- 3.
- 4.

☐ Additional Names on Page _____ of document.

LEGAL DESCRIPTION (Abbreviated: I.E., Block, Plat or Section, Township, Range, Quarter/Quarter)

SE1/4, SW1/4 of Section 28, and NE1/4, NW1/4 and NW1/4, NE1/4 of Section 33, T2N, R6E, W.M.

☐ Additional Names on Page _____ of document.

REFERENCE NUMBERS(S) Of Documents assigned or released:

National Scenic Area File No.: NSA-00-37

☐ Additional Names on Page _____ of document.

ASSESSOR'S PROPERTY TAX PARCEL/ACCOUNT NUMBER

Duncan Creek Road (Rd. No. 10110) MLP. 1.23 to MLP. 1.61

☐ Property Tax Parcel ID is not yet assigned.

☐ Additional Names on Page _____ of document.

The Auditor/Recorder will rely on the information provided on the form. The Staff will not read the document to verify the accuracy or completeness of the indexing information.

Return Address: Skamania County
PO Box 790
Stevenson, WA 98648

**Skamania County
Department of Planning and
Community Development**

Skamania County Courthouse Annex
Post Office Box 790
Stevenson, Washington 98648
509 427-9458 FAX 509 427-8288

Administrative Decision

APPLICANT: Skamania County

FILE NO.: NSA-00-37

PROJECT: Re-construct and re-align Duncan Creek Road and install guardrail. A mitigated determination of non-significance was issued for this project (SEP-00-13) on January 19, 2001.

LOCATION: From MP 1.23 to MP 1.61 on Duncan Creek Road, in Sections 28 and 33 of T2N, R6E, W.M in Skamania County

ZONING: General Management Area-Small Woodland (F3).

DECISION: Based upon the Staff Report, the application by Skamania County, described above, subject to the conditions set forth in this Decision, is found to be consistent with Title 22 SCC and is hereby approved.

Although the proposed development is approved, it may not be buildable due to inadequate soils for septic and/or lack of potable water. These issues are under the jurisdiction of Skamania County's Building Department and the Washington State Health District.

Approval of this request does not exempt the applicant or successors in interest from compliance with all other applicable local, state, and federal laws.

Skamania County Planning and Community Development
File: NSA-00-37 (Skamania County) Administrative Decision
Page 2

CONDITIONS OF APPROVAL:

The following conditions are required to ensure that the subject request is consistent with Skamania County Title 22. This document, outlining the conditions of approval, must be recorded in the deed records of the Skamania County Auditor in order to ensure notice of the conditions of approval to successors in interest. SCC §22.06.050(C)(2).

- 1) All developments shall be consistent with the enclosed site plan, unless modified by the following conditions of approval. If modified, the site plan shall be consistent with the conditions of approval.
- 2) Those areas of existing roadway that will be abandoned due to the realignment of Duncan Creek Road, and those areas that are newly cut and graded, shall be graded to emulate existing natural contours, and shall be revegetated using native tree species. The trees shall be Western Red Cedar, Douglas Fir and Red Alder, and be planted at a 1:1:1 ratio at a five foot spacing through out the project area. However, trees shall not be planted in areas that would be likely to create a safety hazard. In those areas, native grasses and shrub type vegetation should be planted.
- 3) Existing large conifers, with a DBH greater than 20", that will be felled should be left on site as coarse woody debris.
- 4) The guardrail shall be constructed of weathering steel.
- 5) Only those trees necessary for site development and safety purposes shall be removed.
- 6) All of the above conditions relating to visual subordination shall be satisfied prior to completion of this project.
- 7) There shall be no development within the 100 foot buffer of Chavez Creek without a separate rehabilitation plan prepared by a qualified professional.
- 8) *Good Design I Presume?*
The applicant shall submit a grading plan prior beginning work on this project. (see Staff Report for details on what is required in the grading plan)
- 9) The following procedures shall be effected when cultural resources are discovered during construction activities:
 - a) **Halt Construction.** All construction activities within 100 feet of the discovered cultural resource shall cease. The cultural resources shall remain as found; further disturbance is prohibited.
 - b) **Notification.** The project applicant shall notify the Planning Department and the Gorge Commission within 24 hours of the discovery. If the cultural resources are prehistoric or otherwise associated with Native Americans, the project applicant shall also notify the Indian tribal governments within 24 hours.

Skamania County Planning and Community Development
File: NSA-00-37 (Skamania County) Administrative Decision
Page 3

- c) Survey and Evaluations. The Gorge Commission shall arrange for the cultural resources survey.

Dated and Signed this 27 day of June, 2001, at Stevenson, Washington.

Steve Grichel, Associate Planner
Skamania County Planning and Community Development.

NOTES

Any new residential development, related accessory structures such as garages or workshops, and additions or alterations not included in this approved site plan, will require a new application and review.

As per SCC §22.06.050(C)(2), the Administrative Decision shall be recorded in the County deed records prior to commencement of the approved project.

As per SCC §22.06.050(C)(5), this Decision approving a proposed development action shall become void in two years if the development is not commenced within that period, or when the development action is discontinued for any reason for one continuous year or more.

APPEALS

This Decision shall be final unless reversed or modified on appeal. A written Notice of Appeal may be filed by an interested person within 20 days from the date hereof. Appeal may be made to the Skamania County Board of Adjustment, P.O. Box 790, Stevenson, WA 98648, on or before July 17, 2001. Notice of Appeal forms are available at the Department Office.

WARNING

On November 30, 1998 the Columbia River Gorge Commission overturned a Skamania County Director's Decision 18 months after the 20 day appeal period had expired. You are hereby warned that you are proceeding at your own risk and Skamania County will not be liable for any damages you incur in reliance upon your Director's Decision or any amendments thereto.

A copy of the Decision was sent to the following:

Skamania County Building Department
Skamania County Assessor's Office

A copy of this Decision, including the Staff Report, was sent to the following:

Persons submitting written comments in a timely manner
Yakama Indian Nation
Confederated Tribes of the Umatilla Indian Reservation

BOOK 212 PAGE 609

Skamania County Planning and Community Development
File: NSA-00-37 (Skamania County) Administrative Decision
Page 4

Confederated Tribes of the Warm Springs
Nez Perce Tribe
Columbia River Gorge Commission
U.S. Forest Service - NSA Office
Board of County Commissioners

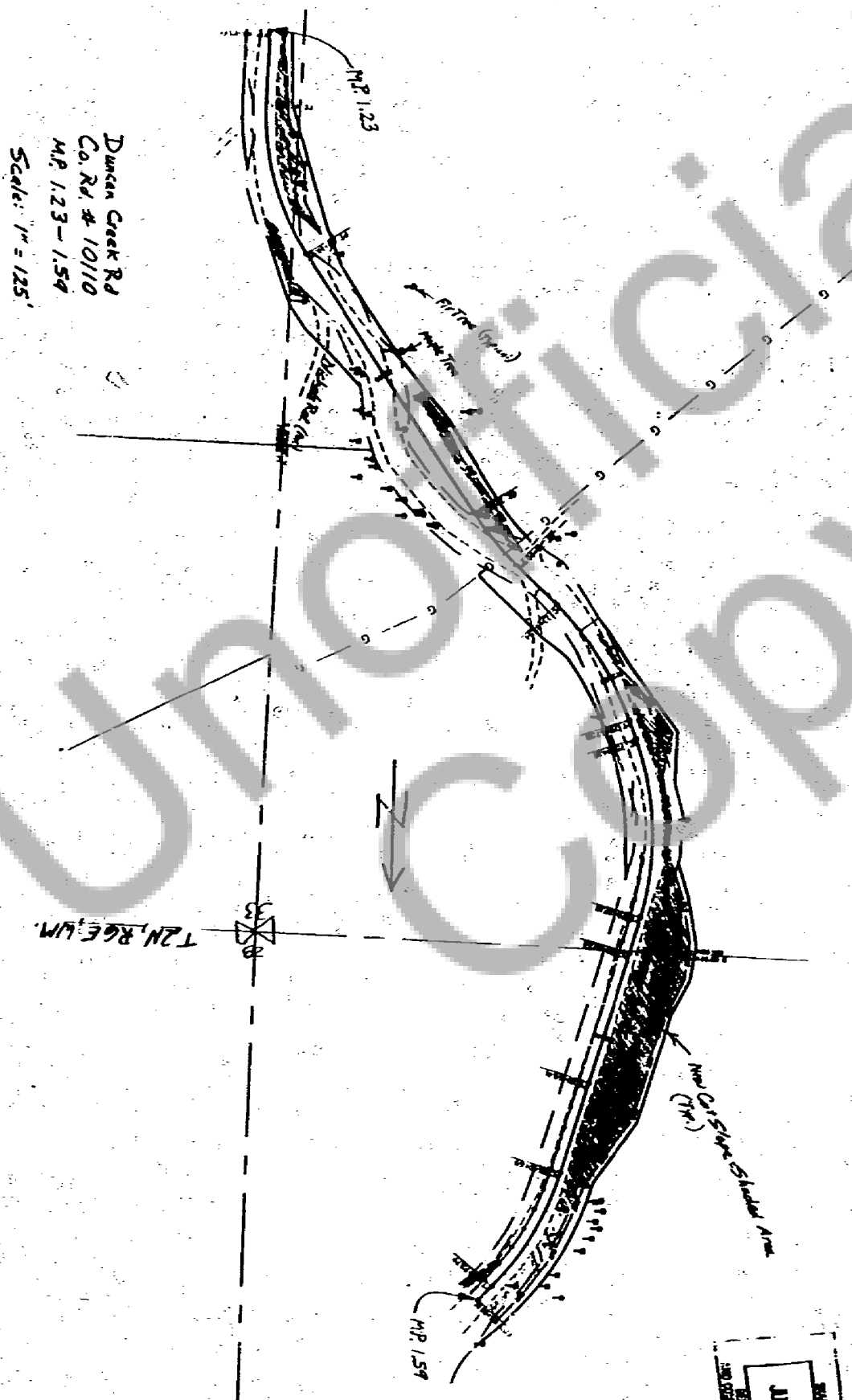

Duncan Creek Rd
Co. Rd. # 10110
MP 1.23-1.59
Scale: 1" = 125'

AL 1 200
JUL 1 200
JUL 1 200
JUL 1 200