

137121

BOOK 195 PAGE 834

FILED
SKAMANIA COUNTY
BY *LandAmerica*

DEC 29 3 14 PM '99

O'Leary
RECORDED
GARY H. OLSON

Recording Request By And
When Recorded Mail To:
Transnation Title Insurance Company
1200 6th Avenue, Suite 1910
Seattle, Washington 98101

REAL ESTATE EXCISE TAX

20604
DEC 29 1999

PAID *Exempt*

John
SKAMANIA COUNTY TREASURER

Type Of Document:

Exchange Deed

Reference Number(s) Of
Document(s) Assigned Or Released:

N/A

Grantor(s):

United States of America

Grantee(s):

Plum Creek Timberlands, L.P.

Abbreviated Legal Descriptions & Assessor's Property Tax Parcel Nos.:

Tax Parcel #
N/A

Sec. Twp. Rge.
08 07N 06E

Descriptions

NE $\frac{1}{4}$, W $\frac{1}{4}$ E $\frac{1}{4}$ NW $\frac{1}{4}$ NW $\frac{1}{4}$, W $\frac{1}{4}$ N $\frac{1}{4}$ NW $\frac{1}{4}$,
NW $\frac{1}{4}$ NE $\frac{1}{4}$ SW $\frac{1}{4}$ NW $\frac{1}{4}$, S $\frac{1}{2}$ NE $\frac{1}{4}$ SW $\frac{1}{4}$ NW $\frac{1}{4}$,
SE $\frac{1}{4}$ SW $\frac{1}{4}$ NW $\frac{1}{4}$, S $\frac{1}{4}$ N $\frac{1}{4}$ SE $\frac{1}{4}$ NW $\frac{1}{4}$,
S $\frac{1}{4}$ SE $\frac{1}{4}$ NW $\frac{1}{4}$, and S $\frac{1}{2}$.

Gary H. Martin, Skamania County Assessor

Date 12-29-99 Parcel # 7-6-700

Prepared ☒
Entered ☒
Indexed ☒
Filed ☒
Noted ☒

Plum Creek Timberlands, L.P./USA - Land Exchange
Skamania County WA
Page 1 of 1

OR-53711(Wash)
SNO #133, WEN #181, GIP #408

EXCHANGE DEED

THIS DEED, made this 15 day of December, 1999, between the UNITED STATES OF AMERICA, Grantor, acting herein by and through the Forest Service, United States Department of Agriculture, and PLUM CREEK TIMBERLANDS, L.P., successor by merger with Plum Creek Timber Company, L.P., a Delaware Limited Partnership, Grantee.

WITNESSETH: That the Grantor, hereunto authorized by the Interstate 90 Land Exchange Act, approved October 21, 1998 (P.L. 105-277, 112 Stat. 2681; 16 U.S.C. 539k), as amended by P.L. 106-113, 113 Stat. 1501, November 29, 1999, the provisions of which have been complied with, for, and in consideration of the conveyance to it by the Grantee of lands in the Counties of King and Kittitas, State of Washington, as stated in the deed to the United States, the receipt of which is hereby acknowledged, does hereby remise, release, and quitclaim unto the Grantee all its rights, title, and interest in and to the real property situated in County of Skamania, State of Washington, described as follows:

T. 7 N., R. 6 E., W.M.

sec. 8, NE $\frac{1}{4}$, W $\frac{1}{2}$ E $\frac{1}{2}$ NW $\frac{1}{4}$ NW $\frac{1}{4}$, W $\frac{1}{2}$ W $\frac{1}{2}$ NW $\frac{1}{4}$, NW $\frac{1}{4}$ NE $\frac{1}{4}$ SW $\frac{1}{4}$ NW $\frac{1}{4}$,
S $\frac{1}{2}$ NE $\frac{1}{4}$ SW $\frac{1}{4}$ NW $\frac{1}{4}$, SE $\frac{1}{4}$ SW $\frac{1}{4}$ NW $\frac{1}{4}$, S $\frac{1}{2}$ N $\frac{1}{2}$ SE $\frac{1}{4}$ NW $\frac{1}{4}$,
S $\frac{1}{2}$ SE $\frac{1}{4}$ NW $\frac{1}{4}$, and S $\frac{1}{2}$.

Containing 577.50 acres, more or less.

Gary H. Martin, Skamania County Assessor
Date 12-29-99 Parcel # 7-6-740
QHH-1

RESERVING UNTO THE UNITED STATES OF AMERICA and its assigns from the lands so granted:

1. A right-of-way thereon for ditches or canals constructed by the authority of the United States (Act of August 30, 1890, 43 U.S.C. 945).
2. Exclusive perpetual easements including all right, title, and interest for existing roads, as shown approximately on Exhibit A, attached hereto and made a part hereof, and more particularly identified and described herein, and all appurtenances thereto, over, upon, or under the lands so granted, together with such reasonable rights of temporary use of lands immediately adjacent to said rights-of-way as may be necessary for the maintenance and/or repair of said roads.

Said easements shall be 66 feet in width, being 33 feet on each side of the centerline thereof, with such additional width as required for adequate protection of cuts and fills, said roads being more particularly described as follows:

Road No. 9015

Beginning at a point on the South line of the SW $\frac{1}{4}$ SW $\frac{1}{4}$ sec. 8, T. 7 N., R. 6 E., W.M., a point approximately 44 feet East of the SW corner sec. 8, crossing W $\frac{1}{2}$ SW $\frac{1}{4}$, NE $\frac{1}{4}$ SW $\frac{1}{4}$, S $\frac{1}{2}$ SE $\frac{1}{4}$ NW $\frac{1}{4}$, S $\frac{1}{2}$ N $\frac{1}{2}$ SE $\frac{1}{4}$ NW $\frac{1}{4}$, W $\frac{1}{2}$ NE $\frac{1}{4}$ sec. 8, ending at a point on the West line of NW $\frac{1}{4}$ NE $\frac{1}{4}$ sec. 8, T. 7 N., R. 6 E., W.M., approximately 306 feet South of the NW corner NW $\frac{1}{4}$ NE $\frac{1}{4}$ sec. 8.

It is agreed that Plum Creek Timberlands, L.P., its successors and assigns, shall have the right to use the existing roads described above for all purposes deemed necessary or desirable in connection with the protection, administration, management, and utilization of Plum Creek Timberlands, L.P. lands or resources, subject, however, to traffic-control regulations under 36 CFR 261.12, and the bearing of road maintenance costs proportionate to use as provided in 36 CFR 212.5(d).

Provided, that if the Regional Forester determines that the road, or any segment thereof, is no longer needed for the purposes reserved, the easement shall terminate. The termination shall be evidenced by a statement in recordable form furnished by the appropriate Regional Forester to Plum Creek Timberlands, L.P., or its successors or assigns in interest.

SUBJECT TO:

1. Cost Share Easement for Road Nos. 300, 600, N71 and N71B, to Burlington Northern Railroad Company dated January 13, 1962, and recorded March 11, 1982, records of Skamania County, Book 80, page 972, (Road 300 affects W $\frac{1}{2}$ NE $\frac{1}{4}$, SE $\frac{1}{4}$ NW $\frac{1}{4}$; Road 600 affects S $\frac{1}{2}$ NE $\frac{1}{4}$; Road N71 affects W $\frac{1}{2}$ NE $\frac{1}{4}$, E $\frac{1}{2}$ NW $\frac{1}{4}$, NE $\frac{1}{4}$ SW $\frac{1}{4}$, W $\frac{1}{2}$ SW $\frac{1}{4}$; Road N71B affects SW $\frac{1}{4}$ NE $\frac{1}{4}$, SE $\frac{1}{4}$ NW $\frac{1}{4}$, NE $\frac{1}{4}$ SW $\frac{1}{4}$; all in sec. 8, T. 7 N., R. 6 E.)
2. Easement for a road, to Department of Natural Resources, State of Washington, recorded 6/22/1967, in Book 57 page 361, Skamania County, OR 1614 W, dated 4/13/1967 (affects sec. 8, T. 7 N., R. 6 E.).
3. Easement for Westpine and Stag Roads, to Northern Pacific Railway Company, authorized by United States Department of the Interior, Bureau of Land Management, W 05064, dated 2/26/1964 (affects NW $\frac{1}{4}$ NE $\frac{1}{4}$, S $\frac{1}{2}$ NE $\frac{1}{4}$, E $\frac{1}{2}$ NW $\frac{1}{4}$, NE $\frac{1}{4}$ SW $\frac{1}{4}$, W $\frac{1}{2}$ SW $\frac{1}{4}$ sec. 8, T. 7 N., R. 6 E.).
4. Easement for a road, to State of Washington, DNR, recorded March 25, 1983, Auditor's File No. 95523, in Book 82 page 80, Skamania County, OR 36026 W, dated 3/9/1983 (affects SW $\frac{1}{4}$ SW $\frac{1}{4}$ sec. 8, T. 7 N., R. 6 E.).
5. Patent No. 46910033 (Serial No. OR 46909 W) dated August 5, 1991, conveyed minerals only to Meridian Minerals in the NE $\frac{1}{4}$, W $\frac{1}{2}$ E $\frac{1}{2}$ NW $\frac{1}{4}$ NW $\frac{1}{4}$, W $\frac{1}{2}$ W $\frac{1}{2}$ NW $\frac{1}{4}$, NW $\frac{1}{4}$ NE $\frac{1}{4}$ SW $\frac{1}{4}$ NW $\frac{1}{4}$, S $\frac{1}{2}$ NE $\frac{1}{4}$ SW $\frac{1}{4}$ NW $\frac{1}{4}$, SE $\frac{1}{4}$ SW $\frac{1}{4}$ NW $\frac{1}{4}$, S $\frac{1}{2}$ N $\frac{1}{2}$ SE $\frac{1}{4}$ NW $\frac{1}{4}$, S $\frac{1}{2}$ SE $\frac{1}{4}$ NW $\frac{1}{4}$, SW $\frac{1}{4}$, SE $\frac{1}{4}$ sec. 8, T. 7 N., R. 6 E..
6. Patent No. 46930011 (Serial No. OR 46909 W) dated January 7, 1993, conveyed geothermal resources only to Meridian Minerals in the NE $\frac{1}{4}$, W $\frac{1}{2}$ E $\frac{1}{2}$ NW $\frac{1}{4}$ NW $\frac{1}{4}$, W $\frac{1}{2}$ W $\frac{1}{2}$ NW $\frac{1}{4}$, NW $\frac{1}{4}$ NE $\frac{1}{4}$ SW $\frac{1}{4}$ NW $\frac{1}{4}$, S $\frac{1}{2}$ NE $\frac{1}{4}$ SW $\frac{1}{4}$ NW $\frac{1}{4}$, SE $\frac{1}{4}$ SW $\frac{1}{4}$ NW $\frac{1}{4}$, S $\frac{1}{2}$ N $\frac{1}{2}$ SE $\frac{1}{4}$ NW $\frac{1}{4}$, S $\frac{1}{2}$ SE $\frac{1}{4}$ NW $\frac{1}{4}$, SW $\frac{1}{4}$, SE $\frac{1}{4}$ sec. 8, T. 7 N., R. 6 E..

TO HAVE AND TO HOLD the above-described real property unto the Grantee or the Grantee's assigns forever, together with all hereditaments and appurtenances thereunto belonging.

IN WITNESS WHEREOF, the Grantor, by its Director of Recreation, Lands, and Mineral Resources, Forest Service, Pacific Northwest Region, has executed this deed pursuant to the delegation of authority by the Secretary of Agriculture to the Assistant Secretary for Natural Resources and Conservation, the delegation of authority by the Assistant Secretary for Natural Resources and Conservation to the Chief, Forest Service, 7 CFR 2.60, and the delegation of authority by the Chief, Forest Service, 49 F.R. 34283, published August 29, 1984, on the day and year first above written.

UNITED STATES OF AMERICA

Kimberly Evart Bown

KIMBERLY EVART BOWN, Director
Recreation, Lands, and Mineral Resources
Pacific Northwest Region
USDA Forest Service

ACKNOWLEDGMENT

STATE OF Oregon
County of Multnomah ss.

On this 15 day of December 1999, before me, the undersigned, a Notary Public in and for said State personally appeared Kimberly Evart Bown Director of Recreation, Lands, and Mineral Resources, Pacific Northwest Region, Forest Service, Department of Agriculture, the same person who executed the within and foregoing instrument, who being by me duly sworn according to law, did say that he/she executed said instrument on behalf of the United States of America by its authority duly given and by him/her delivered as and for its act and deed. And he/she did further acknowledge that he/she executed said instrument as the free act and deed of the United States of America, for the purposes and consideration herein mentioned and set forth, and I do hereby so certify.

IN WITNESS WHEREOF, I have hereunto set my hand and official seal the day and year first above written.

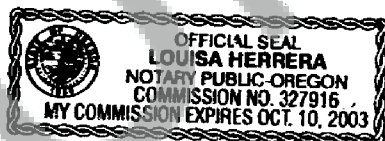

Louisa Herrera
Name (Printed) Louisa Herrera
Residing at Portland, Oregon
My Commission Expires 10/10/2003

Certified correct as to consideration, description, conditions and form.

J. Everett White 12/13/99

RIGHT OF WAY RESERVATION
BY THE UNITED STATES IN THE
FOREST SERVICE- PLUM CREEK EXCHANGE
SECTION 8, T. 7 N., R. 6 E., W.M.
SKAMANIA COUNTY, WASHINGTON
UNITED STATES DEPARTMENT OF AGRICULTURE
PACIFIC NORTHWEST REGION
GIFFORD PINCHOT NATIONAL FOREST

EXHIBIT A

RIGHT OF WAY INFO

The total existing road R/W being reserved by the United States, shown on this exhibit, is 1.16 miles in length, 66 feet in width, 33 feet each side of centerline, and contains 9.28 acres. The R/W begins at the true property lines and ends at the true property lines.

** ROAD LENGTH **
Rd. 9015 1.16 mi.

Basis of Bearing
-Assumed-

The existing road location shown is based on 1999 GPNF/GIS Survey. All distances are measured.

LEGEND

NFSL National Forest System Land being exchanged

— R/W Reserved

— Section Line

- - - Subdivision line

● Brass Cap of Record

SCALE IN FEET

1320

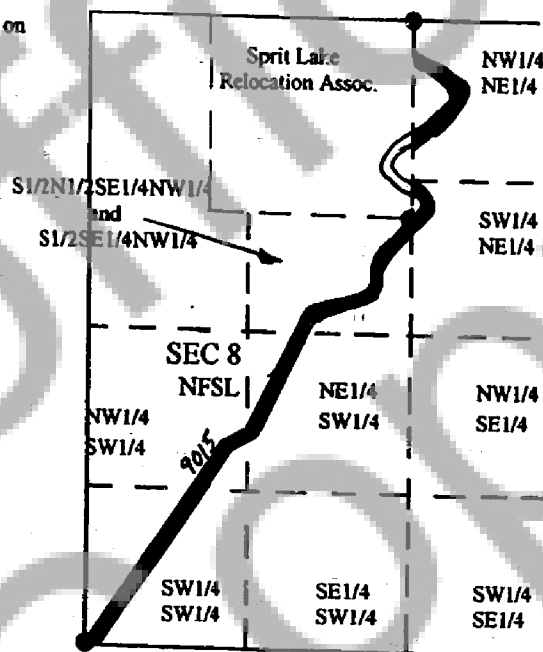

Reviewed by *[Signature]* 9/22/99

Land Surveyor

Accepted by *[Signature]* 4/22/03

Forest Engineer