

135255

FILED FOR RECORD
SKAMANIA COUNTY, WASH.
Skamania County
MAY 25 3 01 AM '99
O'Lowry
GARY H. OLSON

RECEIVED

MAY 24 1999

SKAMANIA COUNTY
AUDITOR
3:30 PM

Aug 10-99
Filed 16
Direct
Filed
Filed

FORM OF CLAIM FOR DAMAGES

TO THE BOARD OF COUNTY COMMISSIONERS of Skamania County, Washington:

PLEASE TAKE NOTICE that in accordance with Chapter 36.45 of the Revised Code of Washington, I Larry D Thayer hereby present you with my claim for damages against the County of Skamania, State of Washington, with the information required to be given by RCW 36.45.020 as follows:

1. That the injury for which I claim damages against the County of Skamania, State of Washington, occurred on or about the _____ day of _____ 19_____. Beginning Nov. 1996 to present.

2. That the place of injury was 1201 Smith-Becken Rd
Carson Wash. 98610

3. That the location and description of the defect which caused the injury are excess water being redirected to place of injury from
Kralls truck shop.

4. That the injury is described as follows: loss of furnace, structural
beam damage under house, ground under house saturated.

5. That the amount of damages claimed is as follows: \$11671.00

6. That the actual residence of the claimant at the time of presenting and filing this claim is 1201 Smith-Becken Rd Carson WA 98610

7. That the actual residence of the claimant for a period of six months immediately prior to the time that this claim accrued was 1201 Smith-Becken Rd
Carson WA 98610

DATED: 4-25-, 19 99

Larry D Thayer
(Claimant)

NOTE: Personal Property (Car, etc.) damages are to be accompanied by estimated repair costs. Additional information required by Nos 2-4 of this form may be attached on the back of this Claim for Damages.

Larry Thayer
P.O. Box 918
Carson, WA. 98610

5-19-99

Skamania County Commissioners
Stevenson, WA. 98648

Re: Water Damage

Honorable Commissioners,

In my recent conversation with Brad Anderson, Prosecuting attorney, he informed me he was going to advise that the county was not liable for our water damages. Please note the following reasons why I feel the county is liable.

1. No water problem existed in prior history at this residence.
2. Six years we resided at this address: no water problem.
3. Smith-beckon road raised in 1996.
4. Drainage ditch (along side Smith-Beckon road) removed with road project in 1996.
5. Improvements to Krall Truck Shop/Mini Storage causing increased water run-off.
6. Have flooded every year since the road project.
7. We have complained twice to the engineer's office about the road.

The changes in Smith-Beckon road (raising of said road) and removal of drainage ditch caused the run off from Krall's Truck Shop to pool up in front of his metal building at the edge of our property. They in turn did not want to flood out their building so they dug a small ditch around their building into our field. This added to the water that our field collected from the rain made a torrential river that ran right to our home causing all this damage.

In 1996, the first (and the worst year) this happened, we went two weeks without heat and without a cook stove. I called the county for help and was directed to FEMA. I was told then that the road project had nothing to do with water run off in my field. "It was just a combination of the weather conditions." When the same thing happened three winters in a row I became frustrated and angry and called county again about a solution. I was informed at that time that the road project was probably "contributing" to the problem.

Below is an itemized claim for damages.

- | | |
|---|----------|
| 1. Replace furnace: Replace furnace from under house, | 6,200.00 |
| Replace all duct work and cold air Returns. | |
| Interest | 345.00 |

(This is through FEMA, a \$6,200.00 loan at 4% for 3 years. As of 4-15-99 we still owe \$2,545.00)

- | | |
|---|-------------------------|
| 2. Collection ditch and excavation to prevent further water damage. Nicklaus Backhoe Service. | 1,200.00 |
| 3. Sandbagging: 4 different occasions, 10 or more people, 140 plus man hours. The first occasion we used over 100 sandbags. This includes numerous trips to Stevenson for sand and bags, a sump pump for 10 days. | 955.00 |
| 4. Stabler Building Consultants
This was an inspection for damages under the house and foundation. | 100.00 |
| 5. Replace and Repair under house (see Van Pelt estimate)
To be done by Van Pelt and Van Pelt per inspection | 1,450.00
tax- 101.50 |
| 6. French drain and catch basin East side of garage (see Van Pelt estimate) To be done by Van Pelt and Van Pelt | 895.00
tax- 62.65 |
| 7. Catch basin and drain pipe across front of house.
To be done by Van Pelt and Van Pelt. (see Van Pelt Estimate). | 945.00 |

This does not include aggravation and frustration from having to deal with this problem every winter since the road project, and doing without heat for two weeks the first winter and four days the second winter.

Thank you for taking the time to look at our claim. Van Pelts estimate is on the following page.

Sincerely,

Larry Thayer

North ↑

Smith-Becken Rd.

METZGER RD

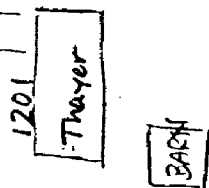
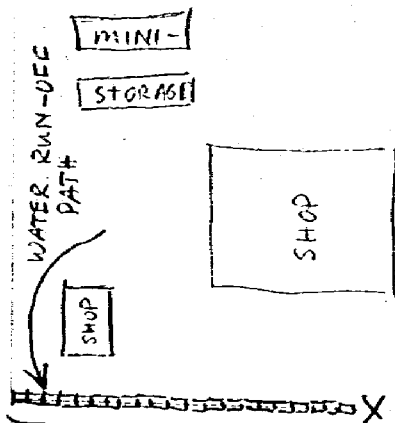

WIND RIVER HWY

My proposal is a building block wall, 18" high, from Smith-Becken Rd to 140' along property line.

FEDERAL EMERGENCY MANAGEMENT AGENCY DISASTER ASSISTANCE REGISTRATION				Control No. WNW1Y	O.M.B. No. 3067-0-09 Expires Sep. 30, 1998	DR No. 1159
1. Name of Registrant (Last, First, MI) MR THAYER, LARRY D				2. Social Security Number 832-88-2842		3A. Home phone number (509) 427-4821
3B. Second home phone number None		3C. Current phone number (509) 427-4821		3D. Work or other phone number (509) 427-8354		4. Date of loss 12/26/1996
5. Location of damaged property	No. 1201	Street SMITH BECKON RD	Apt/Lot Apt/Lot	City CARSON	State WA	Zip / Zip+4 98610
6. County SKAMANIA						
8A. Real Damage: Heating				8C. Auto Damage: No		
8D. Other Damage: H2O CAME WITHIN 8 INCHES OF FLOOR JOINTS						
9. Do you have any disaster-related emergency needs for food, clothing, shelter, or transportation? No						
10. Damages caused by: Flood						
11. Did you have any damage to farm property, crops, livestock, or equipment? (Does not include farm home) No						
12. Do you own a business or rental property which was affected by the disaster? (Not farm damage) No						
Business Name:						
13. Has anyone in your family lost work or become unemployed due to the disaster? (incl. self-employed) Yes						
14. Did you have any disaster-related medical, dental, or funeral expenses not covered by insurance? No						
17. Names of all persons living in home at time of disaster	Age	Relation to Registrant	Control No.	Names of all persons living in home at time of disaster	Age	Relation to Registrant
AANDFYAD, SIGMUND	17	Other	No	THAYER, DAVID L	13	Immed Family
THAYER, JEREMIAH L	17	Immed Family	No	THAYER, JOANN M	46	Co-Reg/Spouse
THAYER, JOANTHAN E	14	Immed Family	No	THAYER, LARRY D	42	Registrant
WNW1						
18. Own/Rent: Own	19. Primary Residence?: Yes (Primary)	20. Type of home: House - Single/Duplex		21. Registrant is currently living in: Damaged Dwelling		
22. Insurance information: Homeowners (O)						
23. Was your home destroyed by the disaster? No						
24. Is this disaster preventing you from living in your home now? No						
25. Have you spent money to make repairs to your home so you can live there safely? (includes access) No						
26. Do any repairs need to be made to your home so you can live there safely? (includes access) Yes						
27. Are any of your essential utilities currently not working as a result of the disaster? Yes						
28. Is there any imminent danger to your home? (e.g. undermining, landslide, etc.) No						
30. Primary wage earner's employer: US PARCEL SERV			32. Total number of dependents claimed (includes registrant): 6			
			33. Annual pre-disaster gross income of family: \$ 58,000			
35. Directions to home: (Rural addresses only)					39. Date: 01/31/97 12:52	
					41. Service Rep. MICHAEL	
<p>You have been referred to the following sources of disaster aid. For more information, refer to the Registration Summary on the back of this form and to the Disaster Assistance Program Information sheet(s) attached.</p> <p>Disaster Housing Assistance Program Home/Personal Property Loan Program</p> <p>Tax Assistance Disaster Unemployment Assistance</p>						

A partial Black Plastic sheeting has been installed on the ground, under- floor. It is disheveled and no longer covers all of the soil beneath of this Structure. (No longer intact. ...)

The East Crawl-space is wet through out. Water stains indicate water intrusion as deep as 18" in some of the lower areas. Water had uniformly come up to about 2" - 3" above the footing level through out the East Crawl-space.

Suggested Remedies:

Eliminate all Earth/Wood contact with any wood from the structure. Remove any cellulose & other debris beneath of and adjacent to the structure.

The Visquene sheeting should be replaced & Re-Installed correctly.

Paint w/Copper Napthenate, all of the exposed wood surfaces in the crawl-space that have near Earth proximity. Also Paint all wood surface adjacent to the Insect damage.

The Carpenter Ant & Anobiid Beetle signs are normal for wet Crawl-spaces. They are an indication of elevated moisture conditions as found in the East Crawl-space. The Damaged Structural members should be removed & replaced. The adjacent areas should be treated with Copper Napthenate. (See Enclosed Remedies)

The Wood Rot Fungus damaged support posts should all be replaced. (Preferably with Pressure treated lumber.)

Measures need to be taken to insure that the Crawl-space will remain dry. Additional Ventilation. Changes in slope & grade, (especially along the North & East sides) needed. No excess of moisture noted at the West crawl-space. Also, installation of Strip Drains, Catch Basins & Dry wells should be considered. (Preferred methods.) If moisture intrusion persists, Installation of a sump pump will be necessary.

For further recommendations and/or consultations please contact me.

If there are any questions on this matter, please do not hesitate to call. Please See the enclosed Pest & Dry Rot Report (Form 00-002) & Suggested Remedies...

Respectfully submitted,



Walter L. Loehfke
Senior Consultant
#600 494 369

#48748
Oregon CCB #129991

Construction Estimate

Name: Larry & Joanne Thayer
P.O. Box 918
Carson, WA 98610
(509) 427-4821

Date: April 12, 1999

Description: All materials, labor and permits for the following:

Driveway:

- 4" thick reinforced Concrete 22' x 68' x 32' Road to garage.
- Concrete to be poured on existing surface little excavation required.

Quoted Price: \$3,925.00

French Drain East side of Garage:

- Approx. 200' of ditch
- 6" Perforated Drain pipe to be installed sloped to low point & Drained to catch basin.
- Drainpipe to be covered with 1 1/4" washed drain rock, filter fabric, & existing soil.
- Grade to be sloped to low point over drain area.

Quoted Price: \$895.00

Catch Basin and drain pipe to large drywell on west side of yard.

- Catch basin to collect driveway run off & french drain water.
- Drywell to be 6' deep 8' x 8' filled with drainrock, covered with filter fabric & existing soil.
- Drain line from catch basin to be buried across front yard approx. 12" deep.

Quoted Price: \$945.00

Remove & Replace rotted posts & Rotted beams as indicated in Walt Loerke's report.

- Remove mud & silt in material in bottom of trenches in crawlspace.
- Posts & beams to be replaced with Pressure treated material of same dimension.
- Remove 4 concrete blocks in foundation & install foundation vent.
- Install 6 mil poly plastic vapor barrier in East crawlspace.
- Spray all damaged areas with copper naphenate fungicide.

Quoted Price: \$1,450.00

Remove 2 asphalt driveway approaches and dispose of material.

Quoted Price: \$375.00

Total Quoted Price: \$7,590.00
Washington State Sales Tax: 7% \$531.30

Total Bid: \$8,121.30

Van Pelt & Van Pelt Construction Inc.

P.O. Box 165 Carson, WA 98610
(509) 427-7397