

SURVEY IN SW 1/4 SW 1/4 SW 1/4 OF SECTION 36 T3N R7E WM.
AND SE 1/4 SE 1/4 OF SECTION 35, T.3 N., R.7 E., W.M.

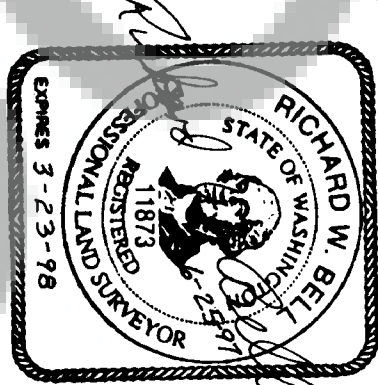

	LOT	CARVE	ACT. LENGTH	FAHRS	DELTA
	LOT 1	C3	33.33	112.32	00:07:48
	LOT 2	C3	146.42	312.35	32:40:40
	LOT 3	C3	41.71	180.00	15:11:09
	LOT 4	C4	38.62	120.00	03:50:00
	LOT 5	C4	21.60	120.00	03:50:00
	LOT 6	C6	41.53	45.00	00:38:56
	LOT 8	C1	48.51	45.00	01:46:04
	LOT 6	C8	17.04	45.00	02:35:26
	LOT 7	C4	11.50	45.00	14:38:34
	LOT 7	C10	14.95	45.00	18:54:48
	LOT 7	C1	41.71	180.00	15:11:09
	LOT 8	C2	38.62	120.00	14:50:00
	LOT 8	C4	23.33	100.00	13:24:00
	LOT 4	C8	107.31	70.00	08:17:02
	LOT 4	C10	61.94	312.35	00:24:40
	LOT 4	C11	0.32	41.71	00:05:00

LEGEND

LEGAL DESCRIPTION

- ## REFERENCES
- See reference 2.
1. Minister and Gleason Surveying Inc. H. Ralph Short
Flat Auditor No. 104904 Book 3, Page 156
Skomaha County, Washington
2. Survey Book 2, Page 252
3. Minston Rail Short Flat Book 1, Page 44
4. Halford Short Plat, Book 3, Page 140
- of Town Plats
- MARKER FOUND AS NOTED
- CORNER OF RECORD
- SET 5/8" REBAR WITH
YELLOW PLASTIC CAP (T.C.P.)
- CALCULATED CORNER
- () PLAT CALL

NOT TO SCALE

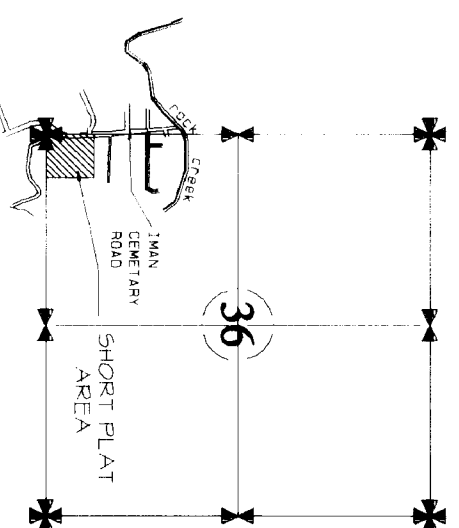

ACCURACY STATEMENT (MAC 332-130)

This survey was performed using a topcon GTS 3B total station, by field traverse with relative accuracy greater than 1:10000. Calculated closure where required is by Least Squares adjustment.

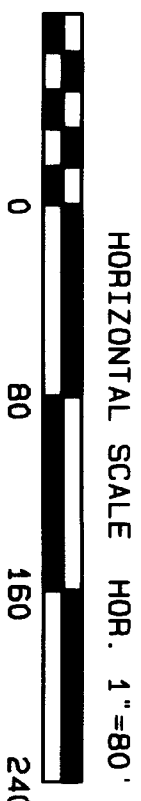

HORIZONTAL SCALE HOR. 1"=80

BELL DESIGN COMPANY	CIVIL ENGINEERING	LAND SURVEYING
7025 PINE HILL DRIVE, PM. 58472		

NICKLAUS SUBDIVISION
STEVENSON, WASHINGTON
FOR BRIAN NICKLAUS

SHEET: 1 OF 1
PROJECT: 95B93
DATE: JUNE 97

<p>Ms, the owners of the Subdivision shown herein, hereby declare that this division of land has been made with our free consent and in accordance with our desires.</p> <p><u>Brian Neelove Gledhill</u> <u>Neilan Gledhill</u> Owner Date Owner Date</p>	
<p><u>Richard W. Bell</u> Notary Public in and for the State of Washington Residing in <u>Stevenson</u> Date <u>6/26/97</u></p>	
<p><u>Valley Gordon</u> Notary Public in and for the State of Washington Residing in <u>Stevenson</u> Date <u>6/26/97</u></p>	
<p>"I, Richard W. Bell registered as a land surveyor by the State of Washington, certify that this plat is based on an actual survey of the land described herein, conducted by me or under my supervision, during the period of October, 1994 through February, 1995, that the distances, courses, and angles are shown thereon correctly, and that monuments other than those approved for setting at a later date, have been set, and lot corners staked on the ground as depicted on the plat.</p> <p>Dated this <u>25th</u> day of <u>JUNE</u>, 19<u>97</u>"</p> <p><u>Richard W. Bell</u> Licensed Land Surveyor PLS NO. 11873</p>	
<p>"I hereby certify that the taxes and assessments have been duly paid, discharged or satisfied in regard to the lands in the subdivision, "3-7-36-3-3-300"</p> <p><u>John E. Younger Deputy</u> <u>7/1/97</u> Skamania County Treasurer Date <u>Michael J. Gledhill</u> <u>7/1/97</u> City Auditor Date</p>	
<p>City water and sewer utilities are available to the lots in this subdivision or certain adequate area and proper soil, topographic and drainage conditions to be served by on-site sewage disposal systems unless otherwise noted.</p> <p><u>Martin Gledhill ES.</u> <u>6-30-97</u> Southwest Washington Health District Date</p>	
<p>"I hereby certify that this final plat conforms to the approved preliminary plat and meets the requirements of the city subdivision regulations."</p> <p><u>Patricia Gledhill</u> <u>6-27-97</u> Planning Administrator Date</p>	
<p>"I hereby certify that this Subdivision has been reviewed and examined by me and that it conforms with City of Stevenson standards for survey data, layout of roads, easements, road names, drainage facilities, water and sewer utilities, and other improvements as required."</p> <p><u>Gail Collins</u> <u>7-1-97</u> City of Stevenson Public Works Director Date <u>Patricia Gledhill</u> <u>7-2-97</u> City Engineer Date</p>	
<p>Final Plat Accepted by the City Council of the City of Stevenson On the <u>19th</u> day of <u>JUNE</u>, 19<u>97</u></p> <p><u>Patricia Gledhill</u> Mayor of Stevenson, Washington Date <u>7-2-97</u></p>	
<p>State of Washington County of Skamania</p> <p>I hereby certify that the within instrument of writing, filed by <u>City of Stevenson</u> at <u>11:30 A.M.</u> on <u>July 3</u> 19<u>97</u> was recorded in Book <u>B</u> of <u>Plats</u> on page <u>89</u></p> <p><u>Garry Olsson</u> Recorder for Skamania County, Washington <u>Sherry M. Olson by G. Olsson</u> <u>1/25/99</u> Skamania County Auditor Auditors No.</p>	