

SCTC 20174
126758
125591

Quit Claim Deed
(Boundary Line Adjustment)

BOOK 160 PAGE 936
BOOK 158 PAGE 12

For the purpose of boundary adjustment only, Larry Tobin and Janet LaRosa (Tobin) grant the following adjustment between their jointly held lots 1 and 2 of the Larry Tobin Short Plat located in S 1/2 of S 1/2 of SE 1/4 of SE 1/4 S 26 T3N R7E. WM in Skamania County, Washington.

The larger Lot #2 (currently 2.81 acres) will grant to the smaller Lot #1 a 20 foot extension of boundary N 1'17'54" E to the east and a 25 foot extension of N 73'56'50" W. to the North. This adjustment is roughly sketched below.

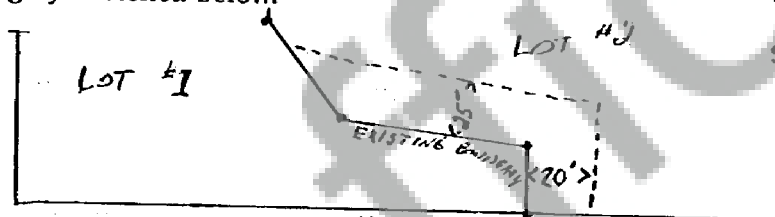

FILED FOR RECORD
SKAMANIA CO. WASH
BY Larry Tobin
JUN 27 11 08 AM '96
P. Johnson
AUDITOR
GARY M. OLSON

The purpose of this deed is to affect a boundary line adjustment between parcels of land owned by Grantors; it is not intended to create a separate parcel, and is therefore exempt from the requirements of RCW 58.17 and Skamania County Short Plat Ordinance. The property described in this deed cannot be segregated and sold without conforming to the State of Washington and Skamania County Subdivision laws.

Dated: 6-14-96 day of June, 1996.

Larry Tobin
Janet LaRosa Tobin

THIS BOUNDARY LINE ADJUSTMENT
IS BEING RERECORDED TO CORRECT LEGAL DESCRIPTION
SEE ATTACHED EXHIBIT "A" FOR CORRECT LEGAL
DESCRIPTION

On this 14 day of June, 1996, before me, personally appeared Larry D. Tobin and Janet LaRosa (Tobin), personally known to me (or proved to me on the basis of satisfactory evidence) to be the persons whose names are subscribed to this instrument, and acknowledged that they executed it as their free and voluntary act for the uses and purposes therein mentioned.

18455
REAL ESTATE EXCISE TAX

18150
REAL ESTATE EXCISE TAX

NOV 22 1996
PAID Exempt
SKAMANIA COUNTY TREASURER

JUN 27 1996
PAID Exempt
SKAMANIA COUNTY TREASURER

Registered ☒
Indexed, Dir ☒
Indirect ☒
Filed ☒
Mailed ☒

Registered ☒
Indexed, Dir ☒
Indirect ☒
Filed ☒
Mailed ☒

in compliance with County sub-division ordinances.

Gary M. Olson, Skamania County Auditor
Date 6/27/96, Paid 18455-18014
11-22-96
1802

6-13-96
6-18-96

EXHIBIT "A"

BOOK 160 PAGE 937

The larger Lot #2 (currently 2.81 acres) will grant to the smaller Lot #1 a 20 foot extension of boundary N 1°17'54" E to the east and a 25 foot extension of N 73°56'50" W. to the North. More precisely, the point of beginning being the southeast corner of Lot 1 of Larry Tobin Short Plat in S 1/2 of S 1/2 of SE 1/4 of SE 1/4 section 26 T3N R7E WM.;
thence S88D 57° 38"E, 20.00';
thence N01D 17° 54"E, 62.42';
thence N73D 56° 50"W, 155.83' to a point on the east line of Lot 1;
thence S28D 02° 27"E, 34.78', to an iron rod;
thence S73D 56° 50"E, 117.56', to an iron rod;
thence S01D 17° 54"E, 41.92' to the point of beginning.

FILED FOR RECORD
SKAMANIA CO. WASH
BY SKAMANIA CO. TITLE

NOV 22 11 48 AM '96

G. Larry
AUDITOR
GARY M. OLSON