

125407

BOOK 3 PAGE 230

15 14  
22 23  
1317.25' N 01°32'18" E 2634.51'  
1317.26' S 89°13'27" E 1315.64'  
1315.64' S 89°13'27" E 1315.46'  
1315.46' S 89°12'23" E 1314.35'  
1314.35' S 01°31'52" W 1316.01'  
2631.81' S 01°31'52" W 1316.01'  
FOUND & HELD 1" IRON PIPE WITH  
2" BRASS CAP & COUPLER  
STAMPED "OPRAH.C.Z. 1970"  
RP: 32° FR~N77E~15.61'  
25° FR~S33E~23.30'  
27° FR~N18W~17.77'  
(ALSO SET LONGVIEW FIBRE  
FENCE POST, 1" SOUTH).  
RP: 16° FR~N26E~29.98'  
4° FR~N90E~63.26'  
20° FR~S43E~51.57'  
(ALSO SET LONGVIEW FIBRE  
FENCE POST, 1" SOUTH).  
RP: 11° FR~N61E~16.01'  
17° FR~S68W~38.15'  
13° FR~N06W~10.26'  
FOUND & HELD D.N.R. CONCRETE  
MONUMENT AS SHOWN IN  
R.O.S. 1-178  
(NOT TIED OR VISITED  
IN THIS SURVEY).  
D.N.R. RECORDS SHOW THE  
MONUMENT WAS SET IN 2/88  
TO REPLACE THE SET BY  
BERT MASON IN PREVIOUS  
SECTION SURVEY.

14 23  
1317.25' N 01°32'18" E 2634.51'  
1317.26' S 89°13'27" E 1315.64'  
1315.64' S 89°12'23" E 1314.35'  
1314.35' S 01°31'52" W 1316.01'  
2631.81' S 01°31'52" W 1316.01'  
FOUND & HELD 1" IRON PIPE WITH  
2" BRASS CAP & COUPLER  
STAMPED "OPRAH.C.Z. 1970"  
RP: 32° FR~N77E~15.61'  
25° FR~S33E~23.30'  
27° FR~N18W~17.77'  
(ALSO SET LONGVIEW FIBRE  
FENCE POST, 1" SOUTH).  
RP: 16° FR~N26E~29.98'  
4° FR~N90E~63.26'  
20° FR~S43E~51.57'  
(ALSO SET LONGVIEW FIBRE  
FENCE POST, 1" SOUTH).  
RP: 11° FR~N61E~16.01'  
17° FR~S68W~38.15'  
13° FR~N06W~10.26'  
FOUND & HELD D.N.R. CONCRETE  
MONUMENT AS SHOWN IN  
R.O.S. 1-178  
(NOT TIED OR VISITED  
IN THIS SURVEY).  
D.N.R. RECORDS SHOW THE  
MONUMENT WAS SET IN 2/88  
TO REPLACE THE SET BY  
BERT MASON IN PREVIOUS  
SECTION SURVEY.

22 23  
1317.25' N 01°32'18" E 2634.51'  
1317.26' S 89°13'27" E 1315.64'  
1315.64' S 89°12'23" E 1314.35'  
1314.35' S 01°31'52" W 1316.01'  
2631.81' S 01°31'52" W 1316.01'  
FOUND & HELD 1" IRON PIPE WITH  
2" BRASS CAP & COUPLER  
STAMPED "OPRAH.C.Z. 1970"  
RP: 32° FR~N77E~15.61'  
25° FR~S33E~23.30'  
27° FR~N18W~17.77'  
(ALSO SET LONGVIEW FIBRE  
FENCE POST, 1" SOUTH).  
RP: 16° FR~N26E~29.98'  
4° FR~N90E~63.26'  
20° FR~S43E~51.57'  
(ALSO SET LONGVIEW FIBRE  
FENCE POST, 1" SOUTH).  
RP: 11° FR~N61E~16.01'  
17° FR~S68W~38.15'  
13° FR~N06W~10.26'  
FOUND & HELD D.N.R. CONCRETE  
MONUMENT AS SHOWN IN  
R.O.S. 1-178  
(NOT TIED OR VISITED  
IN THIS SURVEY).  
D.N.R. RECORDS SHOW THE  
MONUMENT WAS SET IN 2/88  
TO REPLACE THE SET BY  
BERT MASON IN PREVIOUS  
SECTION SURVEY.

22 23  
1317.25' N 01°32'18" E 2634.51'  
1317.26' S 89°13'27" E 1315.64'  
1315.64' S 89°12'23" E 1314.35'  
1314.35' S 01°31'52" W 1316.01'  
2631.81' S 01°31'52" W 1316.01'  
FOUND & HELD 1" IRON PIPE WITH  
2" BRASS CAP & COUPLER  
STAMPED "OPRAH.C.Z. 1970"  
RP: 32° FR~N77E~15.61'  
25° FR~S33E~23.30'  
27° FR~N18W~17.77'  
(ALSO SET LONGVIEW FIBRE  
FENCE POST, 1" SOUTH).  
RP: 16° FR~N26E~29.98'  
4° FR~N90E~63.26'  
20° FR~S43E~51.57'  
(ALSO SET LONGVIEW FIBRE  
FENCE POST, 1" SOUTH).  
RP: 11° FR~N61E~16.01'  
17° FR~S68W~38.15'  
13° FR~N06W~10.26'  
FOUND & HELD D.N.R. CONCRETE  
MONUMENT AS SHOWN IN  
R.O.S. 1-178  
(NOT TIED OR VISITED  
IN THIS SURVEY).  
D.N.R. RECORDS SHOW THE  
MONUMENT WAS SET IN 2/88  
TO REPLACE THE SET BY  
BERT MASON IN PREVIOUS  
SECTION SURVEY.

22 23  
1317.25' N 01°32'18" E 2634.51'  
1317.26' S 89°13'27" E 1315.64'  
1315.64' S 89°12'23" E 1314.35'  
1314.35' S 01°31'52" W 1316.01'  
2631.81' S 01°31'52" W 1316.01'  
FOUND & HELD 1" IRON PIPE WITH  
2" BRASS CAP & COUPLER  
STAMPED "OPRAH.C.Z. 1970"  
RP: 32° FR~N77E~15.61'  
25° FR~S33E~23.30'  
27° FR~N18W~17.77'  
(ALSO SET LONGVIEW FIBRE  
FENCE POST, 1" SOUTH).  
RP: 16° FR~N26E~29.98'  
4° FR~N90E~63.26'  
20° FR~S43E~51.57'  
(ALSO SET LONGVIEW FIBRE  
FENCE POST, 1" SOUTH).  
RP: 11° FR~N61E~16.01'  
17° FR~S68W~38.15'  
13° FR~N06W~10.26'  
FOUND & HELD D.N.R. CONCRETE  
MONUMENT AS SHOWN IN  
R.O.S. 1-178  
(NOT TIED OR VISITED  
IN THIS SURVEY).  
D.N.R. RECORDS SHOW THE  
MONUMENT WAS SET IN 2/88  
TO REPLACE THE SET BY  
BERT MASON IN PREVIOUS  
SECTION SURVEY.

22 23  
1317.25' N 01°32'18" E 2634.51'  
1317.26' S 89°13'27" E 1315.64'  
1315.64' S 89°12'23" E 1314.35'  
1314.35' S 01°31'52" W 1316.01'  
2631.81' S 01°31'52" W 1316.01'  
FOUND & HELD 1" IRON PIPE WITH  
2" BRASS CAP & COUPLER  
STAMPED "OPRAH.C.Z. 1970"  
RP: 32° FR~N77E~15.61'  
25° FR~S33E~23.30'  
27° FR~N18W~17.77'  
(ALSO SET LONGVIEW FIBRE  
FENCE POST, 1" SOUTH).  
RP: 16° FR~N26E~29.98'  
4° FR~N90E~63.26'  
20° FR~S43E~51.57'  
(ALSO SET LONGVIEW FIBRE  
FENCE POST, 1" SOUTH).  
RP: 11° FR~N61E~16.01'  
17° FR~S68W~38.15'  
13° FR~N06W~10.26'  
FOUND & HELD D.N.R. CONCRETE  
MONUMENT AS SHOWN IN  
R.O.S. 1-178  
(NOT TIED OR VISITED  
IN THIS SURVEY).  
D.N.R. RECORDS SHOW THE  
MONUMENT WAS SET IN 2/88  
TO REPLACE THE SET BY  
BERT MASON IN PREVIOUS  
SECTION SURVEY.

22 23  
1317.25' N 01°32'18" E 2634.51'  
1317.26' S 89°13'27" E 1315.64'  
1315.64' S 89°12'23" E 1314.35'  
1314.35' S 01°31'52" W 1316.01'  
2631.81' S 01°31'52" W 1316.01'  
FOUND & HELD 1" IRON PIPE WITH  
2" BRASS CAP & COUPLER  
STAMPED "OPRAH.C.Z. 1970"  
RP: 32° FR~N77E~15.61'  
25° FR~S33E~23.30'  
27° FR~N18W~17.77'  
(ALSO SET LONGVIEW FIBRE  
FENCE POST, 1" SOUTH).  
RP: 16° FR~N26E~29.98'  
4° FR~N90E~63.26'  
20° FR~S43E~51.57'  
(ALSO SET LONGVIEW FIBRE  
FENCE POST, 1" SOUTH).  
RP: 11° FR~N61E~16.01'  
17° FR~S68W~38.15'  
13° FR~N06W~10.26'  
FOUND & HELD D.N.R. CONCRETE  
MONUMENT AS SHOWN IN  
R.O.S. 1-178  
(NOT TIED OR VISITED  
IN THIS SURVEY).  
D.N.R. RECORDS SHOW THE  
MONUMENT WAS SET IN 2/88  
TO REPLACE THE SET BY  
BERT MASON IN PREVIOUS  
SECTION SURVEY.

22 23  
1317.25' N 01°32'18" E 2634.51'  
1317.26' S 89°13'27" E 1315.64'  
1315.64' S 89°12'23" E 1314.35'  
1314.35' S 01°31'52" W 1316.01'  
2631.81' S 01°31'52" W 1316.01'  
FOUND & HELD 1" IRON PIPE WITH  
2" BRASS CAP & COUPLER  
STAMPED "OPRAH.C.Z. 1970"  
RP: 32° FR~N77E~15.61'  
25° FR~S33E~23.30'  
27° FR~N18W~17.77'  
(ALSO SET LONGVIEW FIBRE  
FENCE POST, 1" SOUTH).  
RP: 16° FR~N26E~29.98'  
4° FR~N90E~63.26'  
20° FR~S43E~51.57'  
(ALSO SET LONGVIEW FIBRE  
FENCE POST, 1" SOUTH).  
RP: 11° FR~N61E~16.01'  
17° FR~S68W~38.15'  
13° FR~N06W~10.26'  
FOUND & HELD D.N.R. CONCRETE  
MONUMENT AS SHOWN IN  
R.O.S. 1-178  
(NOT TIED OR VISITED  
IN THIS SURVEY).  
D.N.R. RECORDS SHOW THE  
MONUMENT WAS SET IN 2/88  
TO REPLACE THE SET BY  
BERT MASON IN PREVIOUS  
SECTION SURVEY.

22 23  
1317.25' N 01°32'18" E 2634.51'  
1317.26' S 89°13'27" E 1315.64'  
1315.64' S 89°12'23" E 1314.35'  
1314.35' S 01°31'52" W 1316.01'  
2631.81' S 01°31'52" W 1316.01'  
FOUND & HELD 1" IRON PIPE WITH  
2" BRASS CAP & COUPLER  
STAMPED "OPRAH.C.Z. 1970"  
RP: 32° FR~N77E~15.61'  
25° FR~S33E~23.30'  
27° FR~N18W~17.77'  
(ALSO SET LONGVIEW FIBRE  
FENCE POST, 1" SOUTH).  
RP: 16° FR~N26E~29.98'  
4° FR~N90E~63.26'  
20° FR~S43E~51.57'  
(ALSO SET LONGVIEW FIBRE  
FENCE POST, 1" SOUTH).  
RP: 11° FR~N61E~16.01'  
17° FR~S68W~38.15'  
13° FR~N06W~10.26'  
FOUND & HELD D.N.R. CONCRETE  
MONUMENT AS SHOWN IN  
R.O.S. 1-178  
(NOT TIED OR VISITED  
IN THIS SURVEY).  
D.N.R. RECORDS SHOW THE  
MONUMENT WAS SET IN 2/88  
TO REPLACE THE SET BY  
BERT MASON IN PREVIOUS  
SECTION SURVEY.

22 23  
1317.25' N 01°32'18" E 2634.51'  
1317.26' S 89°13'27" E 1315.64'  
1315.64' S 89°12'23" E 1314.35'  
1314.35' S 01°31'52" W 1316.01'  
2631.81' S 01°31'52" W 1316.01'  
FOUND & HELD 1" IRON PIPE WITH  
2" BRASS CAP & COUPLER  
STAMPED "OPRAH.C.Z. 1970"  
RP: 32° FR~N77E~15.61'  
25° FR~S33E~23.30'  
27° FR~N18W~17.77'  
(ALSO SET LONGVIEW FIBRE  
FENCE POST, 1" SOUTH).  
RP: 16° FR~N26E~29.98'  
4° FR~N90E~63.26'  
20° FR~S43E~51.57'  
(ALSO SET LONGVIEW FIBRE  
FENCE POST, 1" SOUTH).  
RP: 11° FR~N61E~16.01'  
17° FR~S68W~38.15'  
13° FR~N06W~10.26'  
FOUND & HELD D.N.R. CONCRETE  
MONUMENT AS SHOWN IN  
R.O.S. 1-178  
(NOT TIED OR VISITED  
IN THIS SURVEY).  
D.N.R. RECORDS SHOW THE  
MONUMENT WAS SET IN 2/88  
TO REPLACE THE SET BY  
BERT MASON IN PREVIOUS  
SECTION SURVEY.

NARRATIVE

THE PURPOSE OF THIS SURVEY WAS TO LOCATE AND MONUMENT SELECTED BOUNDARY LINES OF THE LONGVIEW FIBRE COMPANY OWNERSHIP IN SECTION 23 FOR LOGGING PURPOSES. SECTION CONTROL WAS OBTAINED BY RUNNING A CONTROL TRAVERSE FROM THE EXISTING MONUMENT AT THE NORTH 1/4 CORNER, WEST, SOUTH AND EAST ALONG PROPERTY LINES AND THEN EAST RANDOMLY TO THE D.N.R. MONUMENT AT THE EAST 1/4 CORNER AND ORIENTING TO AND CLOSING ON THE MATHEMATICAL POSITIONS AS SHOWN IN R.O.S. 1-167. THIS TRAVERSE MET THE REQUIREMENTS OF WAC 332-130-090. PROPERTY CORNER MONUMENTS WERE PLACED BY RADIAL STAKEOUT FROM PREVIOUSLY MENTIONED TRAVERSE POINTS. SURVEY EQUIPMENT USED CONSISTED OF A ONE-SECOND TOTAL STATION INSTRUMENT WITH ELECTRONIC DATA COLLECTOR.



5-28-96

IN THE NE 1/4, SE 1/4 OF THE NW 1/4,  
& THE NE 1/4 OF THE SE 1/4  
SECTION 23, T3N, R7E, W.M.,  
SKAMANIA COUNTY, WA.

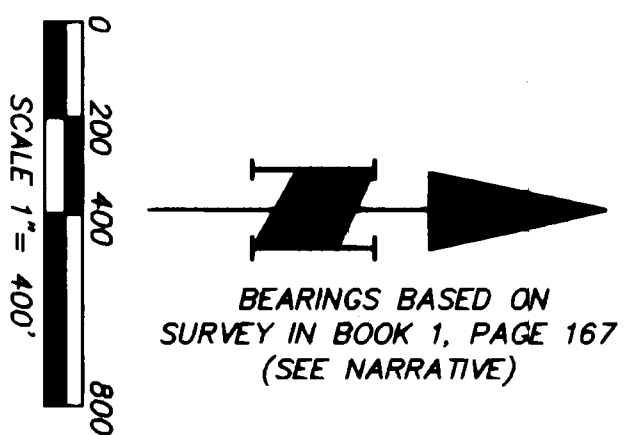

LEGEND

- MONUMENT FOUND AS NOTED
- SET 5/8" x 30" IRON REBAR WITH ORANGE PLASTIC CAP STAMPED "WHITTEN 12412"
- R.O.S. RECORD OF SURVEY
- L.C.R. LAND CORNER RECORD
- D.N.R. DEPARTMENT OF NATURAL RESOURCES
- R.P. REFERENCE POINTS ARE 5/8" IRON RODS WITH YELLOW PLASTIC CAP STAMPED "HAGEDORN, INC." SET APPROXIMATELY ONE FOOT IN FRONT OF THE TREE NOTED (TREE USED ONLY TO MAIL REFERENCE TAG TO). TREE PAINTED WITH BLUE BAND.
- ||||| SET 1/2" x 6" WHITE FIBERGLASS POSTS ALONG PROPERTY LINE (APPROXIMATE 150 INTERVALS) AND PAINTED TREES ON ADJOINING PROPERTIES WITH BLUE PAINT (NOT BLAZED).

SURVEYOR'S CERTIFICATE

This map correctly represents a survey made by me or under my direction in conformance with the requirements of the Survey Recording Act at the request of \_\_\_\_\_  
MARCH 1996

AUDITOR'S CERTIFICATE

Filed for record this 5th day of June, 1996, at 12:03 PM, in Book 3 of surveys at Page 230 at the request of Hagedorn, Inc.

(Signed) \_\_\_\_\_  
County Auditor

NOTE: Hagedorn, Inc. makes no warranties as to matters of unwritten title such as acquiescence, estoppel, adverse possession, etc.

HAGEDORN, INC.  
1924 Broadway Vancouver, WA. 98663  
Ph: (360) 696-4428 (503) 283-6778

SCALE: 1" = 400'  
DATE: 4/5/96  
JOB NO.: 96-010  
CALC. BY: JS  
DRAWN BY: JS  
CHECKED BY: BPT  
DRAWING NAME: FIBRE.DWG  
SHEET 1 OF 1