

Tract Nos. BC-47 and BC-48cc
Case No. 950556

After recording, return to:
Bonneville Power Administration - TTRB
P.O. Box 3621
Portland, OR 97208-3621

Consideration is \$500.00

FILED FOR RECORD
SKAMANIA CO. WASH
BY BPA

JAN 25 3 04 PM '96

P. Lawry
AUDITOR
GARY H. OLSON

124349

EASEMENT

BOOK 155 PAGE 20

KNOW ALL MEN BY THESE PRESENTS, That the United States of America, Department of Energy, Bonneville Power Administration (BPA) does hereby grant unto SKAMANIA COUNTY PUBLIC UTILITY DISTRICT (hereinafter called the Grantee), and its assigns, an easement 20 feet wide x 300 feet long for an underground waterline over, upon, across, and under a fee-owned portion of BPA's Bonneville-Coulee (Line 1 and 2) 300-foot wide transmission line right-of-way, acquired as Tract Nos. BC-47 and BC-48cc in a Declaration of Taking in the District Court of the United States for the Western District of Washington, Southern Division, At Law No. 347, filed on February 3, 1939, located in a portion of the W $\frac{1}{2}$ NE $\frac{1}{4}$ of Section 29, Township 3 North, Range 8 East, Willamette Meridian, Skamania County, Washington. Said easement lies 10 feet on each side of and parallel with the centerline, which is more particularly described as follows:

Commencing at Bonneville-Coulee No. 2 transmission line centerline station 512+04.1, a point that is S.84°44'15"W. a distance of 345.9 feet from Tower No. 9/5 of said transmission line at centerline station 515+50.0 in the NW $\frac{1}{4}$ NE $\frac{1}{4}$ of said section; thence S.48°15'45"E. a distance of 119.6 feet to The True Point of Beginning, a point on the southerly boundary line of said 300-foot wide right-of-way, thence N. 48°15'45"E. a distance of 410.1 feet to a point on the northerly boundary line of said 300-foot wide right-of-way and the termination of said 20-foot wide easement.

The centerline above described for the 20-foot wide easement intersects the BPA Bonneville-Coulee No. 2 transmission line at centerline station 512+04.1 and the BPA Bonneville-Coulee No. 1 transmission line at centerline station 510+87.5.

Gary H. Olson, Skamania County Assessor
Date 1/25/96 Parcel # 8-8-29-B-4

NA
REAL ESTATE EXCISE TAX
Jan. 25 1996
PAID NA
W
SKAMANIA COUNTY TREASURER

Registered
Indexed, Cir
Indirect
Filed
Mailed

BOOK 155 PAGE 21

Bearings based on BPA's Bonneville-Coulee No. 2 transmission line and shown on a segment of BPA Drawing No. 1180, marked Exhibit A, attached hereto, and by this reference made a part hereof. The above-described easement contains .18 acre, more or less.

Subject to outstanding rights:

1. Agriculture Easement (Tract No. BC-47), dated July 15, 1940.

Subject also to the following conditions:

1. Mark the location of the underground waterline with permanent signs where it enters and leaves BPA's right-of-way, and at any angle points within the right-of-way.
2. This easement shall not interfere with any use by the United States of America of its fee-owned property.

Grantee, and its assigns, shall be responsible for and comply with all procedural and substantive environmental requirements imposed by local, state or federal laws or regulations applicable to the facility. Grantee, and its assigns, shall timely notify BPA of any reportable release of hazardous substances or breaches of environmental requirements and shall mitigate and abate adverse environmental impacts of its actions. Grantee, and its assigns, shall hold BPA harmless for any and all liability arising from the violation of such requirements by Grantee, and its assigns.

Reserving unto the United States of America, and its assigns, the right to operate, maintain, rebuild, and upgrade existing electric transmission lines and to erect, operate, maintain, rebuild, and upgrade future transmission lines over, under, and across the easement area.

Reserving also unto the United States of America, and its assigns, the right of access to and along its fee-owned property.

The Grantee, and its assigns, shall be liable for any damage to the property of the United States of America, including transmission lines and structures, arising out of or resulting from any act or omission of the Grantee or its employees, agents, or assigns acting within their authority in the construction, reconstruction, or maintenance of said underground waterline upon the fee-owned property of the United States of America.

TO HAVE AND TO HOLD the above-described easement unto SKAMANIA COUNTY PUBLIC UTILITY DISTRICT, and its assigns, forever, EXCEPT, should the rights granted herein no longer be used or needed for the purposes defined in this easement for a consecutive two-year period, or be abandoned, then upon written notice by the United States of America to the Grantee, or assigns, all rights granted by this easement shall automatically terminate and the title thereto revert in the United States of America.

The true and actual consideration for this easement is \$500.00.

BOOK 155 PAGE 22

This conveyance is made pursuant to the Acts of August 20, 1937 (50 Stat. 732, 16 U.S.C. § 832a), as amended and October 23, 1962 (76 Stat. 1129, 40 U.S.C. § 319) and regulations and delegations of authority issued pursuant thereto, it having been determined that the granting of this easement will not be adverse to the interests of the United States of America.

Dated at Portland, Oregon, this 19 day of January 1976

UNITED STATES OF AMERICA
Department of Energy
Bonneville Power Administration

By Renee M. Ferrera
Manager, Real Property Management

STATE OF OREGON)
) ss:
County of Multnomah)

On this day personally appeared before me Renee M. Ferrera, to me known to be the _____ Manager, Real Property Management, Bonneville Power Administration, described in and who executed the within and foregoing instrument and acknowledged that she signed the same as her free and voluntary act and deed for the uses and purposes therein mentioned.

GIVEN under my hand and official seal this 19 day of January, 1976



(SEAL)

Mary Kathleen O'Neal
Notary Public for Oregon

My Commission expires: Aug 16, 1999

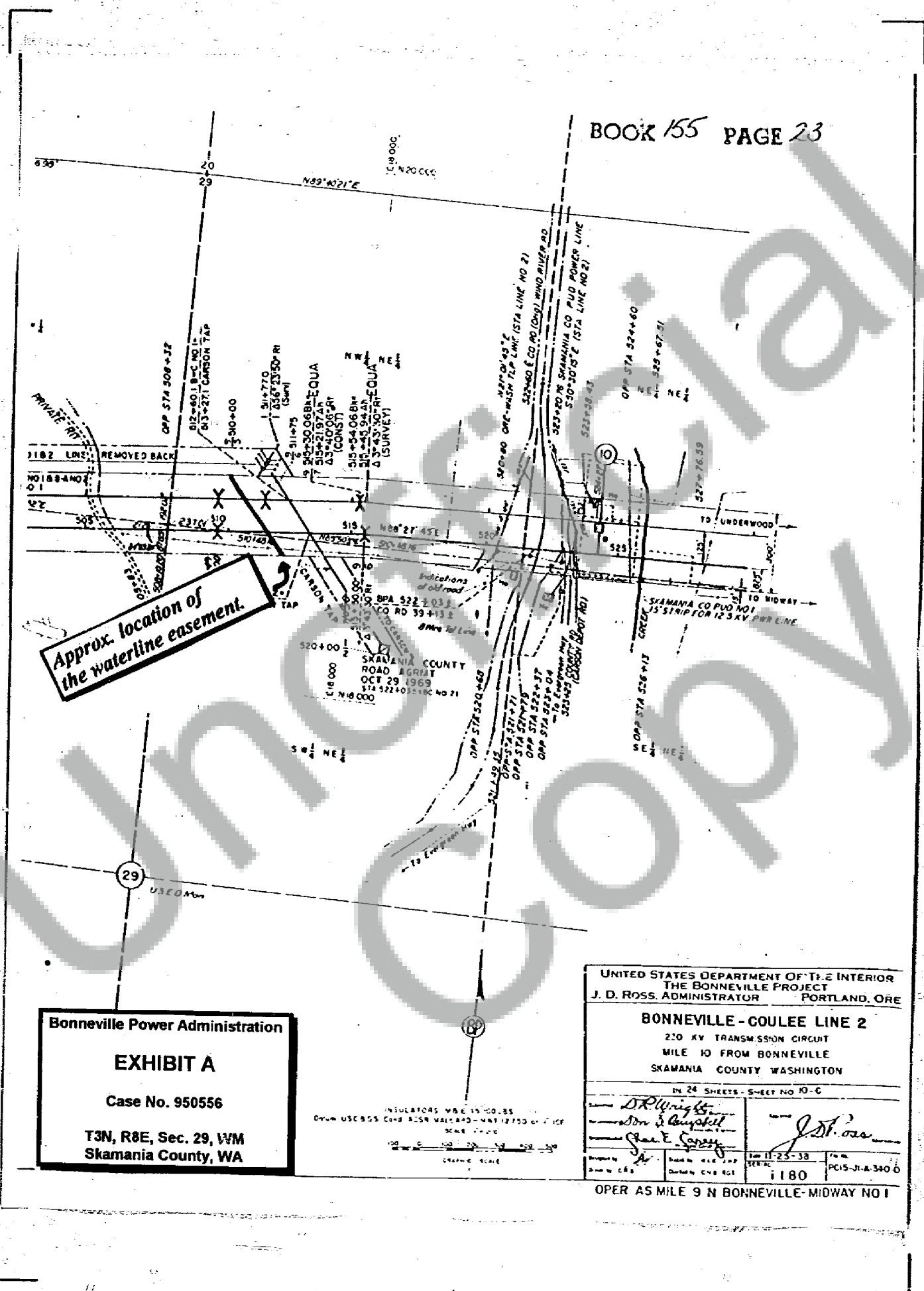

Approx. location of the waterline easement.

Bonneville Power Administration
EXHIBIT A
 Case No. 950556
 T3N, R8E, Sec. 29, WM
 Skamania County, WA

INSULATORS WBE 15-00-35
 DYNAM USCS5 Cond A:SN VALKAPD-NAT12750 or 11CF
 SCALE 1"=100'
 GRAPHIC SCALE

UNITED STATES DEPARTMENT OF THE INTERIOR THE BONNEVILLE PROJECT J. D. ROSS, ADMINISTRATOR PORTLAND, ORE			
BONNEVILLE - COULEE LINE 2			
220 KV TRANSMISSION CIRCUIT MILE 10 FROM BONNEVILLE SKAMANIA COUNTY WASHINGTON			
IN 24 SHEETS - SHEET NO 10-C			
<i>DR Wright</i> <i>Don & Campbell</i> <i>Gene E. Carey</i>		<i>J. D. Ross</i>	
Prepared by A	Checked by GEP	Scale 1"=100'	Form PCIS-JI-A-340 O
OPER AS MILE 9 N BONNEVILLE-MIDWAY NO 1			