

NOTICE OF MINING LOCATION

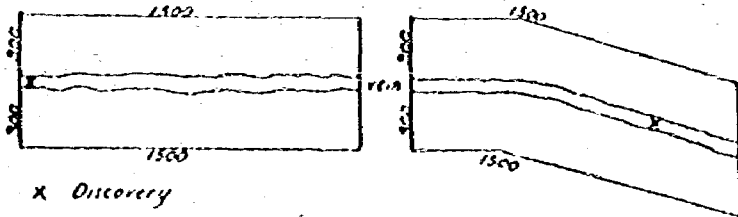

x Discovery

This diagram explains method of description of claim.

WASHINGTON State  
 SHAMANIA County  
 COPPER CITY (or Recording Precinct) Mining District

BOOK 153 PAGE 47

123573

NOTICE IS HEREBY GIVEN That the undersigned who is/are (has/declared intention to become) citizen<sup>s</sup> of the United States, has discovered and has located and claimed and does hereby locate \_\_\_\_\_ linear feet in length, and \_\_\_\_\_ feet in width on the STAR GATE I, II, III PLACER CLAIM ASSOCIATION. Lode, vein, ledge or deposit (or placer ground), situated in the above State, County (or Recording Precinct) and Mining District, and further described as follows: Commencing at a post marked No. 1 at the Discovery shaft (cut or tunnel), from thence \_\_\_\_\_ feet in a \_\_\_\_\_ direction to an end post marked No. 2, thence \_\_\_\_\_ feet in a \_\_\_\_\_ direction to a corner post marked No. 3, thence \_\_\_\_\_ feet in a \_\_\_\_\_ direction to a corner post marked No. 4, thence \_\_\_\_\_ feet in a \_\_\_\_\_ direction to a corner post marked No. 5, thence \_\_\_\_\_ feet in a \_\_\_\_\_ direction to a corner post marked No. 6, thence \_\_\_\_\_ feet in a \_\_\_\_\_ direction to said end post No. 2; hereby locating and intending to claim \_\_\_\_\_ feet in a \_\_\_\_\_ direction from discovery to the \_\_\_\_\_ end line, and \_\_\_\_\_ feet in the opposite direction from discovery to the \_\_\_\_\_ end line and \_\_\_\_\_ feet on each side of the middle of said lode or ledge, for the purpose of mining the same and claiming all surface rights, privileges, and minerals, with all dips, spurs, angles and variations, and other rights granted by existing laws and customs.

This claim is further described by reference to natural objects or permanent monuments, as follows:  
STAR GATE I, 20 ACRES PLACER CLAIM DESCRIBED AS 10 ACRES AT NW 1/4 OF THE NW 1/4 OF THE NE 1/4 OF SEC 31 ALSO 10 ACRES AT NW 1/4 OF THE NE 1/4 OF THE NE 1/4 SEC 31 T4N R5E WILLAMETTE MERIDIAN.  
STAR GATE II, 20 ACRES AT S. 1/2 OF THE NE 1/4 OF THE NE 1/4 SEC 31 T4N R5E WILLAMETTE MERIDIAN  
STAR GATE III 20 ACRES AT NE 1/4 OF THE SE 1/4 OF THE NE 1/4 OF SEC 31 ALSO THE NW 1/4 OF THE SW 1/4 OF THE NW 1/4 OF SEC 32 T4N R5E WILLAMETTE MERIDIAN, AT COPPER CREEK.

This notice is placed at Discovery on post No. 1; posts are placed at each corner, and the name of this lode, and date of location, are placed on all posts.

Located the 19th day of October 1995.

David G. Watson DAVID G. WATSON  
Angler W. Watson ANGLER W. WATSON  
Sherman M. Bayer Sherman M. Bayer  
 Locaters.

WITNESSES:

\_\_\_\_\_  
 \_\_\_\_\_

Registered   
 Indexed   
 Indexed   
 Filmed   
 Mailed

STATE OF Washington  
County of Skamania } ss.

(Individual Acknowledgment)

I, David G. Watson, do solemnly swear that I am a citizen of the United States of America (or have declared my intention to become such) and that I am acquainted with the mining ground described in the notice of location, and herein called the Stargate I, II, III Placer Mining Claims; that the ground and claim herein described, or any part thereof, has not, to the best of my knowledge and belief, been located according to the laws of the United States and this State, or if so located, that the same has been abandoned or forfeited by reason of failure of such former locators to comply in respect thereto with the requirements of said laws; and that I have performed the equivalent of at least \$100.00 in labor on such claim and have complied with all applicable laws of this State pertaining to this claim.

David G. Watson

Subscribed and sworn to before me this 19<sup>th</sup> day of October, 1995.

Peggy B. Lowry

Notary Public in and for the State of Washington  
residing at Carson in said County.

PEGGY B. LOWRY  
STATE OF WASHINGTON  
NOTARY --- PUBLIC  
MY COMMISSION EXPIRES 2-23-99

FILED FOR RECORD  
SKAMANIA CO. WASH  
BY David Watson

OCT 19 8 39 AM '95

P. Lowry  
AUDITOR  
GARY M. OLSON

153212

UNOFFICIAL COPY

Signature of Claimant Dennis H. Watson D.H. Watson date \_\_\_\_\_

MAP of Mining Claim(s)

Township 4N Range 5E Section 32 State of WASHINGTON

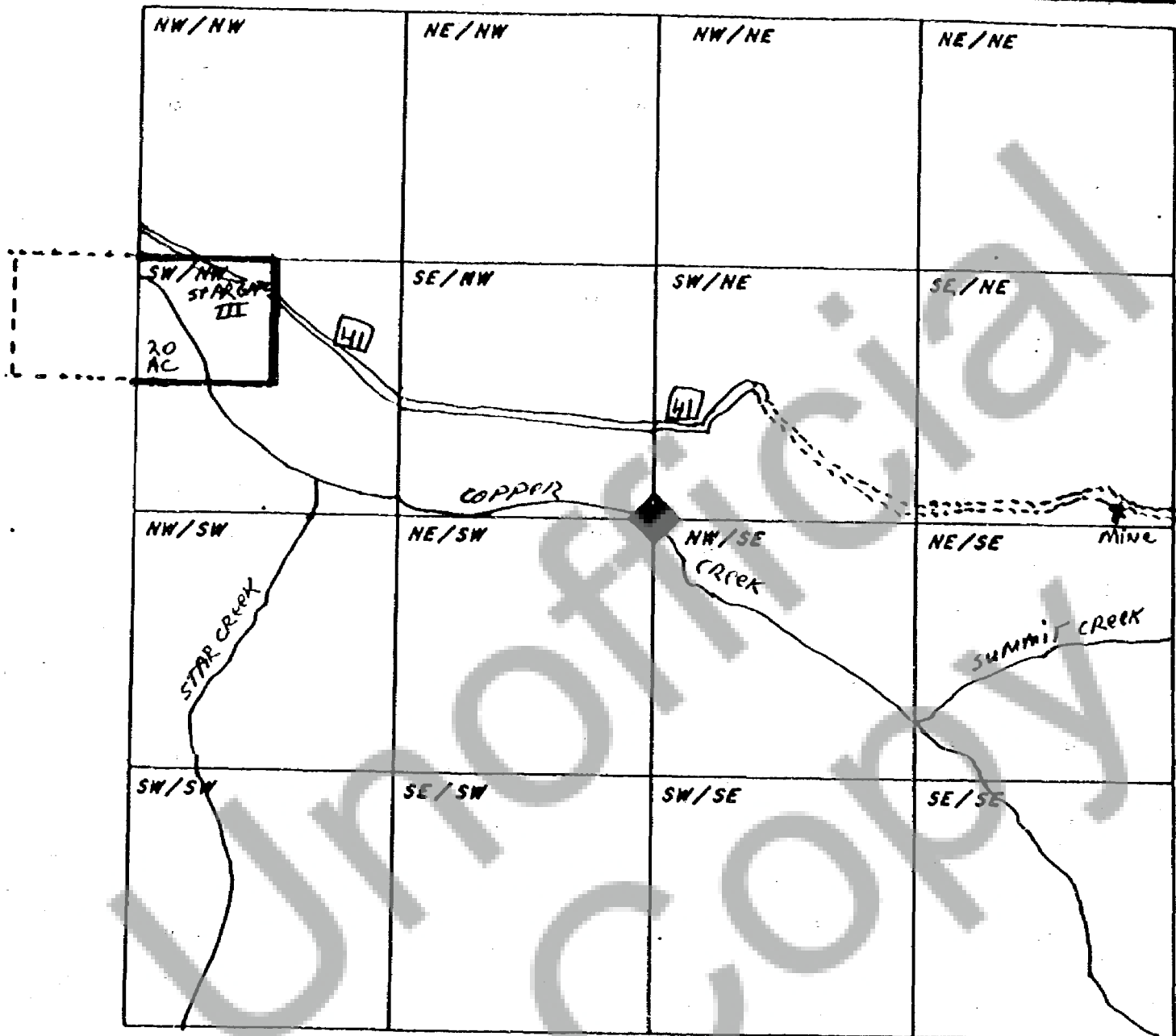

When drawing your claim(s) use an ordinary ruler. 1/8th of an Inch would be 100 feet so a full size lode (600' x 1500') would be 3/4" by 1 7/8". A full size placer (1320' x 660') would be 1 5/8" by 13/16".

Signature of Claimant Davis N. Watson A.W. Watson date \_\_\_\_\_

[Signature]

MAP of Mining Claim(s)

Township 4N Range 5E Section 31 State of WASHINGTON

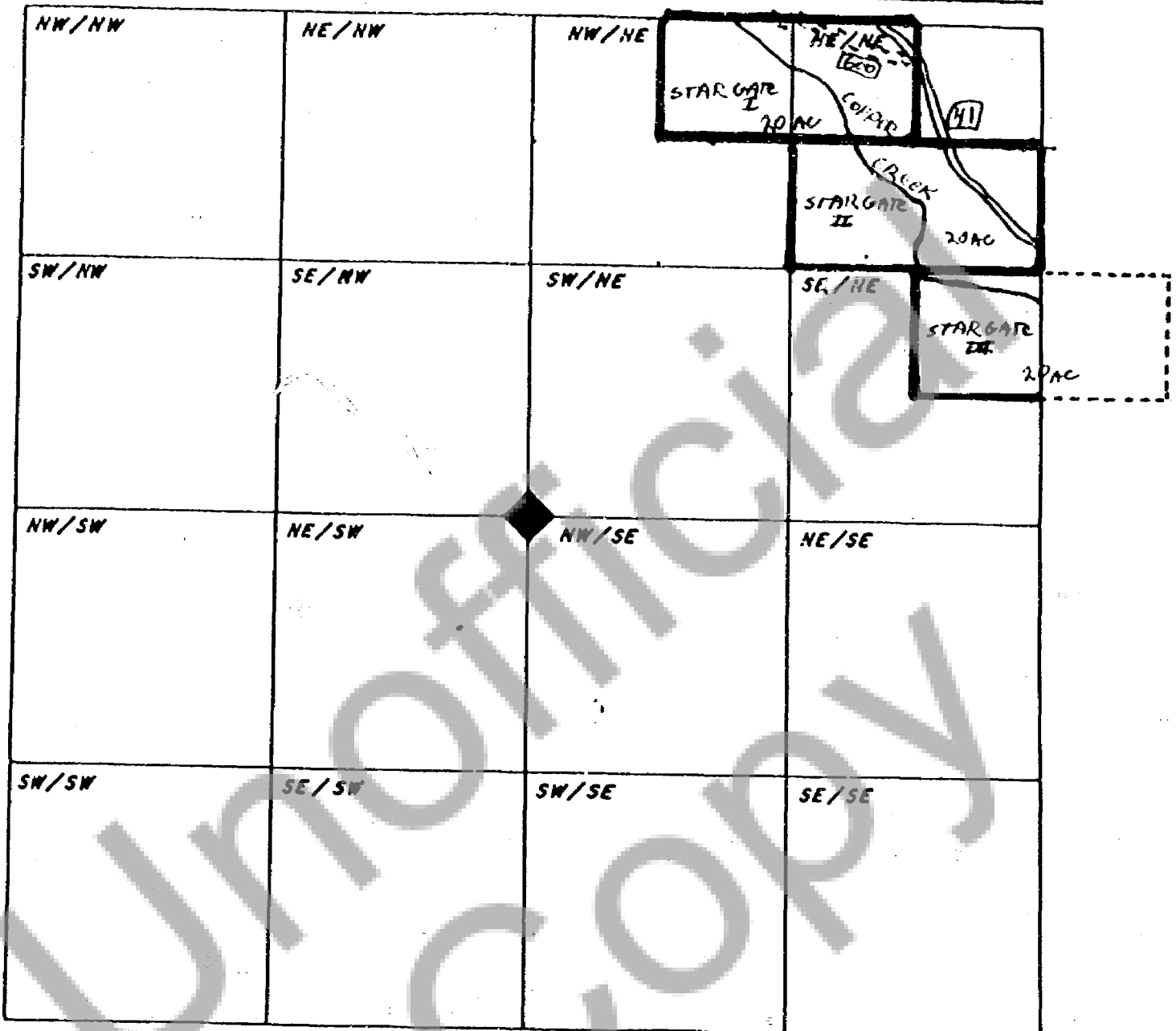

When drawing your claim(s) use an ordinary ruler. 1/8th of an Inch would be 100 feet so a full size lode (600' x 1500') would be 3/4" by 1 7/8". A full size placer (1320' x 660') would be 1 5/8" by 13/16".