

120997

AMENDMENT

NOTICE OF MINING LOCATION

BOOK 146 PAGE 902

WASHINGTON

State

SKAMANIA

County

(or Recording Precinct)

Mining District

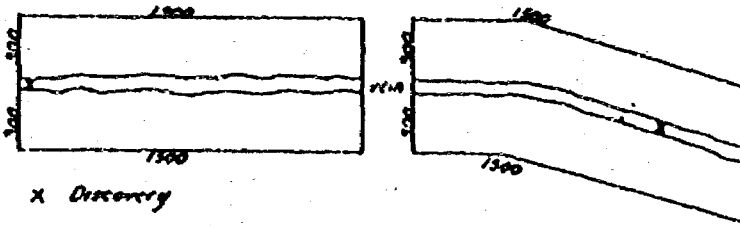

X Discovery

This diagram explains method of
discovery of claim.

117252 AMEND TO CHANGE LEGAL BOOK 137 PAGE 881

NOTICE IS HEREBY GIVEN That the undersigned who is/are (has/declared _____ intention to become) citizen of the United States, has discovered and has located and claimed and do hereby locate 1320 linear feet in length, and 1660 feet in width on the W 1/2, NE 1/4, SW 1/4 SEC 21 R 5 E T 3 N. Lode, vein, ledge or deposit (or placer ground), situated in the above State, County (or Recording Precinct) and Mining District, and further described as follows: Commencing at a post marked No. 1 at the Discovery shaft (cut or tunnel), from thence _____ feet in a _____ direction to an end post marked No. 2, thence _____ feet in a _____ direction to a corner post marked No. 3, thence _____ feet in a _____ direction to a corner post marked No. 4, thence _____ feet in a _____ direction to a corner post marked No. 5, thence _____ feet in a _____ direction to a corner post marked No. 6, thence _____ feet in a _____ direction to said end post No. 2; hereby locating and intending to claim _____ direction from discovery to the _____ end line, and _____ feet in the opposite direction from discovery to the _____ end line and _____ feet on each side of the middle of said lode or ledge, for the purpose of mining the same and claiming all surface rights, privileges, and minerals, with all dips, spurs, angles and variations, and other rights granted by existing laws and customs.

This claim is further described by reference to natural objects or permanent monuments as follows:
THE AREA EXTENDING FROM 1320' NORTH OF GRAVEL PIT TO 2640' DUE NORTH OF GRAVEL PIT ALONG SKAMANIA CREEK TRIBUTARY OF WEST FORK FOREST SERVICE BOUNDARY

This notice is placed at Discovery on post No. 1; posts are placed at each corner, and the name of this lode, and date of location, are placed on all posts.

Located the 1 day of SEPT, 1993FILED FOR RECORD
SKAMANIA CO. WASH
BY Pat Smith

SEP 8 1 46 PM '93

P. Olson
AUDITOR

GARY M. OLSON

RECORDER'S NOTE:

NOT AN ORIGINAL DOCUMENT

Registered
Indexed, Cir
Indirect
Filmed
Mailed

Pat Smith
STONOKORE II
Locators.

SEP 6 PM 2- APR 1991

Registered
Indexed, Cir
Indirect
Filmed
Mailed

RECEIVED
BUREAU OF
LAND MANAGEMENT
LAW & ENFORCEMENT
1993 NOV - 1
STATE OFFICE
PORTLAND, OREGON

3-5-100

BOOK 146 PAGE 903

BOOK 137 PAGE 885

1994 NOV -2 AM 9 45

OREGON STATE OFFICE
PORTLAND, OR

Office of Claimant

Robert R. Smith date 7/7/93

MAP of Mining Claim(s)

Range 5E Section 21 State of WASHINGTON

RECEIVED
BUREAU OF
LAND MANAGEMENT
NOV -1 P 9 52
STATE OFFICE
PORTLAND, OREGON

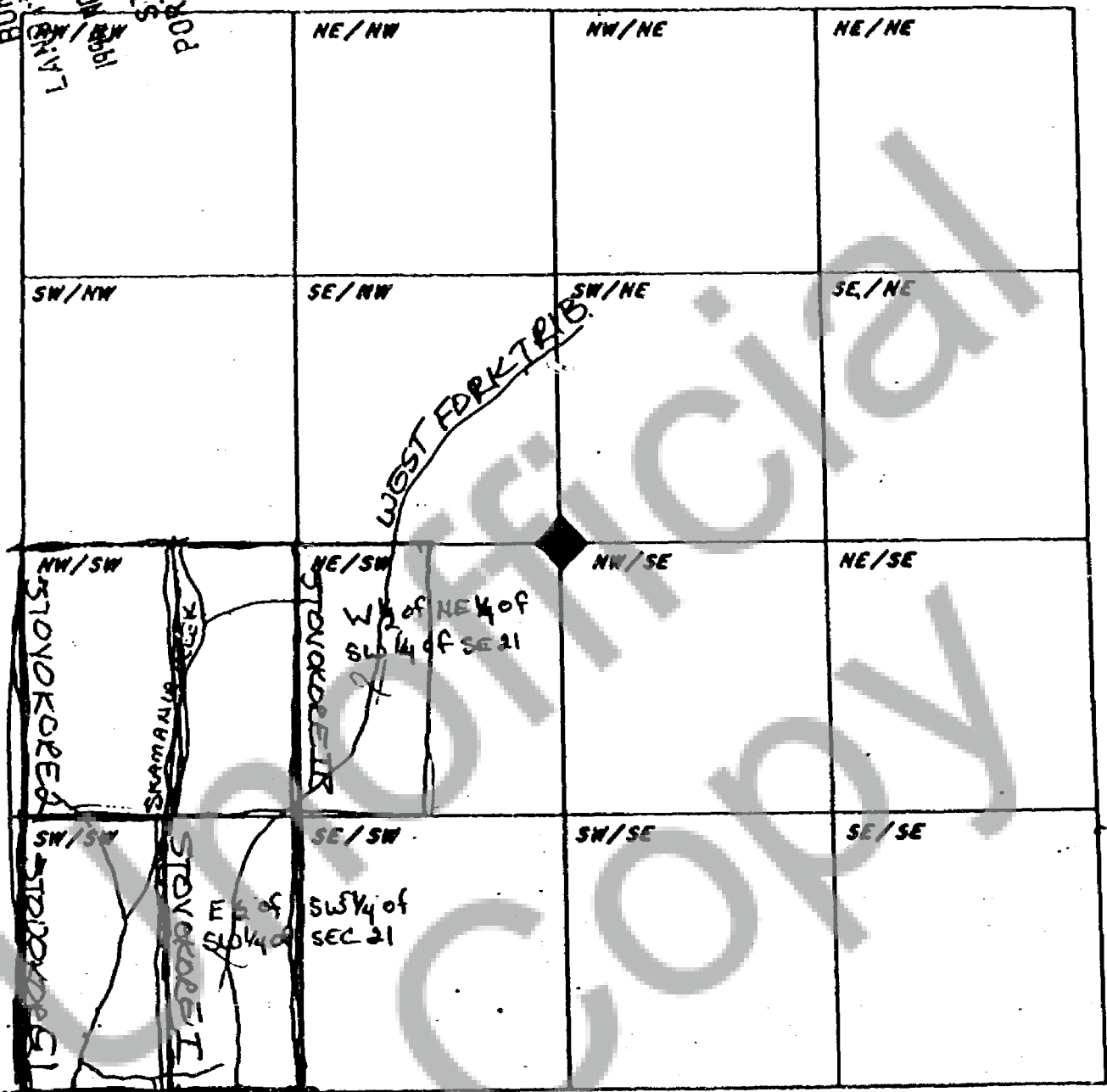

When drawing your claim(s) use an ordinary ruler. 1/8th of an inch would be 100 feet so a full size lode (600' x 1500') would be 3/4" by 1 7/8". A full size placer (1320' x 660') would be 1 5/8" by 13/16".

\$