

NOTICE OF MINING LOCATION

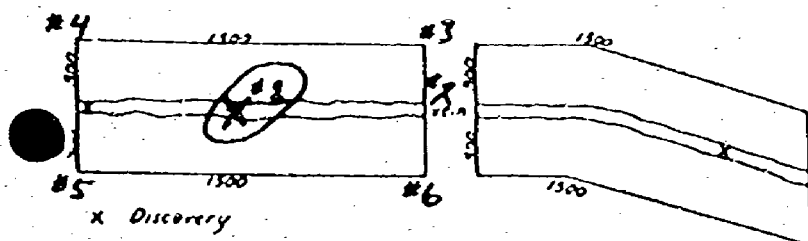

This diagram explains method of description of claim
120625

WASHINGTON State
SKAMANIA County
GLENNPORT PINCHOT Mining District

BOOK 146 PAGE 15

NOTICE IS HEREBY GIVEN That the undersigned who ~~are~~ (I ~~am~~ declared ~~my~~ intention to become) citizens of the United States, have discovered and have located and claimed and do ~~es~~ hereby locate 1500 linear feet in length, and 600 feet in width on the

YELLOW JACKET MINE. Lode, vein, ledge or deposit (or placer ground), situated in the above State, County (or Recording Precinct) and Mining District, and further described as follows: Commencing at a post marked No. 1 at the Discovery shaft (cut or tunnel), from thence 750 feet in a EASTERLY direction to an end post marked No. 2, thence 300 feet in a NORTHERLY direction to a corner post marked No. 3, thence 1500 feet in a WESTERLY direction to a corner post marked No. 4, thence 600 feet in a SOUTHERLY direction to a corner post marked No. 5, thence 1500 feet in a EASTERLY direction to a corner post marked No. 6, thence 300 feet in a NORTHERLY direction to said end post No. 2; hereby locating and intending to claim 750 feet in a WESTERLY direction from discovery to the WEST end line, and 750 feet in the opposite direction from discovery to the EAST end line and 300 feet on each side of the middle of said lode or ledge, for the purpose of mining the same and claiming all surface rights, privileges, and minerals, with all dips, spurs, angles and variations, and other rights granted by existing laws and customs.

This claim is further described by reference to natural objects or permanent monuments, as follows:
LOCATED ON THE EAST BANK, OF THE EASTERLY FORK, OF THE EAST TRIBUTARY, OF THE WEST FORK, OF THE WASHOUGAL RIVER,
2.0 MILES ABOVE THE SKAMANIA MINE

This notice is placed at Discovery on post No. 1; posts are placed at each corner, and the name of this lode, and date of location, are placed on all posts.

Located the 24TH day of SEPTEMBER, 1994.

FILED FOR RECORD
 SKAMANIA CO. WA
 BY Dean Pepper

SEP 26 12 48
 AUDITOR
 GARY M. OL

WITNESSES:

[Signature]
[Signature]

STEVE E WHITE + A. DEAN PEPPER

[Signature]

[Signature]

Locators.

1994 SEP 26 11:15
 PORTLAND, OR

STATE OF Washington

County of Clark

ss.

(Individual Acknowledgment)

I, Steve E White & L. Dean Pepper, do solemnly swear that I am a citizen of the United States of America (or have declared my intention to become such) and that I am acquainted with the mining ground described in the notice of location, and herein called the Yellow Jacket Mine Placer Mining Claim; that the ground and claim herein described, or any part thereof, has not, to the best of my knowledge and belief, been located according to the laws of the United States and this State, or if so located, that the same has been abandoned or forfeited by reason of failure of such former locators to comply in respect thereto with the requirements of said laws; and that I have performed the equivalent of at least \$100.00 in labor on such claim and have complied with all applicable laws of this State pertaining to this claim.

Nita Frye

Subscribed and sworn to before me this 26 day of September, 1994

Nita Frye

Notary Public in and for the State of Washington
residing at Vancouver in said County.



Unofficial Copy

1934 SEP 27 PM 11:15

Signature of Claimant Norman A. Hite + L. DEAN PEPPER date 9-24-94
Steve White + 2 Sons

MAP of Mining Claim(s)

Township 3N Range 5E Section 21 State of WASHINGTON

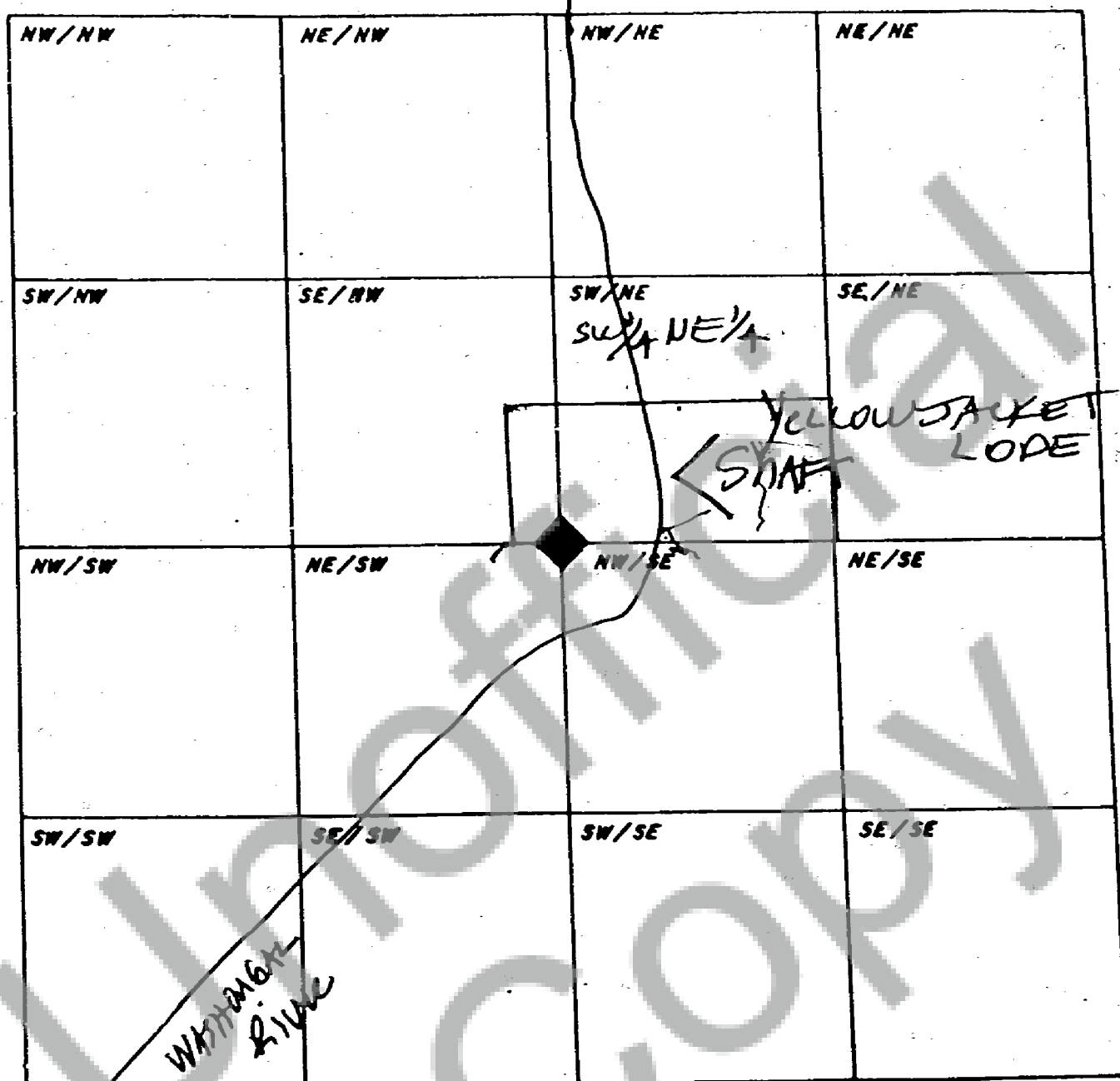

When drawing your claim(s) use an ordinary ruler. 1/8th of an inch would be 100 feet so a full size lode (600' x 1500') would be 3/4" by 1 7/8". A full size placer (1320' x 660') would be 1 5/8" by 13/16".

