

119958

Notice of Location of Placer Claim

BOOK 144 PAGE 433

Notice is hereby given that the undersigned, who is a/are (or has declared _____ intention to become) citizen _____ of the United States, has on this 11 day of July, 1994 discovered at the place where this notice is posted a valuable placer deposit bearing Gold and other valuable minerals, and do hereby locate and claim same as the Big Daddy Placer Mining Claim.

This claim is situated in the nigger head Mining District, Section 10, in Township 10 N Range 8 E.

The point of discovery whereon this notice is posted is situated At a point 20' South/West from the confluence of camp creek & McCoy creek this notice posted on Post #1

and from thence the boundaries of said claim are marked and described as follows:

Then 660' westerly direction to Post #2 then 1320' Southerly to post #3 then 660' easterly to Post #4 then 1320' Northerly back to post #1

FILED FOR RECORD
SKAMANIA CO. WASH
BY Debra Tucksen

JUL 11 3 14 PM '94
P. Olson
AUDITOR
GARY M. OLSON

Notice dated and posted on the day aforesaid.

Discovered July 11

1994

Debra L. TUCKSEN

Located July 11

1994

Debra L. TUCKSEN

Locator—

Debra L. TUCKSEN

Notice of location must be recorded within thirty days from the date of discovery at the office of the auditor of the county in which such discovery was made. Twenty Acres may be included in one placer claim and if located on surveyed land it must be according to legal subdivisions.

Care must be taken to fully describe the claim with reference to natural objects and permanent monuments or survey description, so that the boundaries can be readily traced. The blank spaces in this form must be carefully and properly filled out.

The discoverer must perform labor upon such location in developing the same to an amount which shall be equivalent in the aggregate to at least \$10.00 worth of such labor for each twenty acres, or fractional part thereof, contained in such location or claim, within sixty days from the date of discovery, and upon performance of such labor, file with the auditor of county an affidavit showing such performance and generally the nature and kind of work so done. Provided however, that certain federal regulations may apply, in addition or in place of the above.

Registered
Indexed, Dir
indirect
Cred
Voted

STATE OF Washington
County of Skamania } ss.

(Individual Acknowledgment)

I, Debra L. Tuckson, do solemnly swear that I am a citizen of the United States of America (or have declared my intention to become such) and that I am acquainted with the mining ground described in the notice of location, and herein called the Big Daddy Placer Mining Claim; that the ground and claim herein described, or any part thereof, has not, to the best of my knowledge and belief, been located according to the laws of the United States and this State, or if so located, that the same has been abandoned or forfeited by reason of failure of such former locators to comply in respect thereto with the requirements of said laws; and that I have performed the equivalent of at least \$10.00 in labor on such claim and have complied with all applicable laws of this State pertaining to this claim.

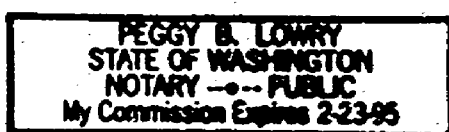
Subscribed and sworn to before me this 11th day of July, 1991.

Peggy B. Lowry
Notary Public in and for the State of Washington
residing at Carson in said County.

Unofficial Copy

BOOK 144 PAGE 435

Signature of Claimant

Debra L. Lichsen

date 2-11-94

Big Daddy

MAP of Mining Claim(s)

Township 10 N

Range 8 E

Section 10

State of WASH

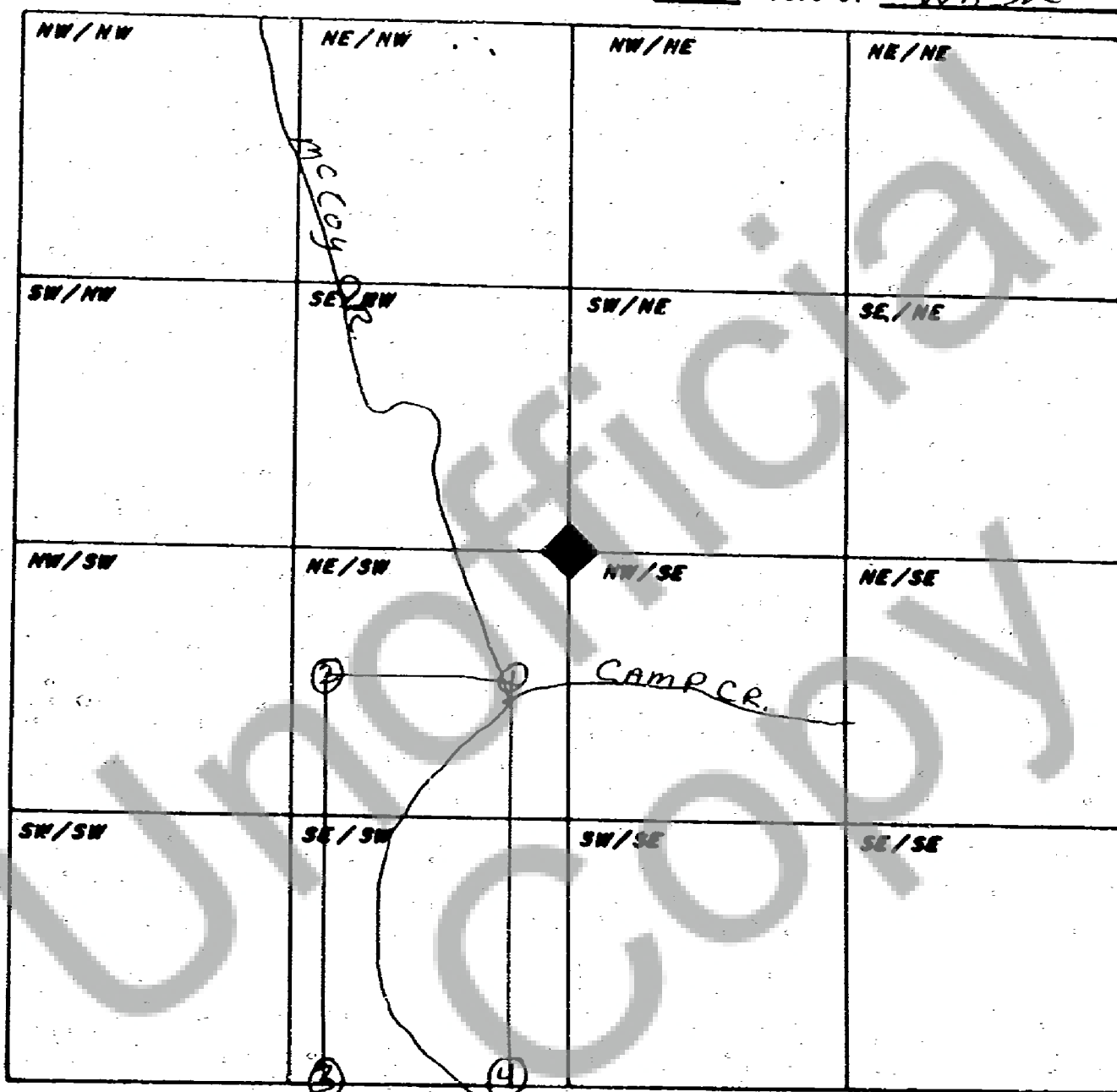

When drawing your claim(s) use an ordinary ruler. 1/8th of an inch would be 100 feet so a full size lode (600' x 1500') would be 3/4" by 1 7/8". A full size placer (1320' x 660') would be 1 5/8" by 13/16".