

NOTICE OF MINING LOCATION

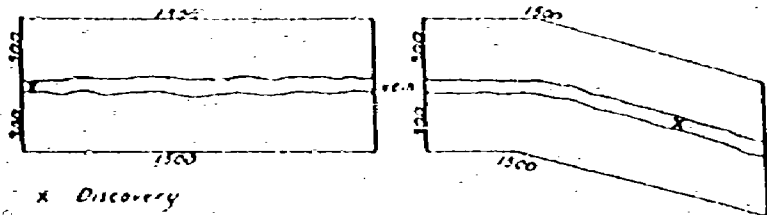

WASHINGTON State
SKAMANIA County
SKAMANIA (for Recording Precinct Mining District)

This diagram explains method of description of claim.

119096

PLACER CLAIM "WICKER MONKEY"

BOOK 142 PAGE 328

NOTICE IS HEREBY GIVEN That the undersigned who is/are (ha declared intention to become) citizen S of the United States, have discovered and ha located and claimed and do hereby locate 1320 linear feet in length, and 1320 feet in width on the COPPER CREEK, T4N R5E SEC. 31. Lode, vein, ledge or deposit (or placer ground), situated in the above State, County (or Recording Precinct) and Mining District, and further described as follows: Commencing at a post marked No. 1 at the Discovery shaft (cut or tunnel), from thence 1320 feet in a SOUTH direction to an end post marked No. 2, thence 1320 feet in a WEST direction to a corner post marked No. 3, thence 660 feet in a NORTH direction to a corner post marked No. 4, thence 660 feet in a WEST direction to a corner post marked No. 5, thence 660 feet in a NORTH direction to a corner post marked No. 6, thence 1980 feet in a EAST direction to said end post No. 6, hereby locating and intending to claim X feet in a X direction from discovery to the X end line, and X feet in the opposite direction from discovery to the X end line and X feet on each side of the middle of said lode or ledge, for the purpose of mining the same and claiming all surface rights, privileges, and minerals, with all dips, spurs, angles and variations, and other rights granted by existing laws and customs.

This claim is further described by reference to natural objects or permanent monuments, as follows:

NE 1/4 NE 1/4 of SEC 31 T4N R5E 40 ACRES 50 ACRES TOTAL

IN ADDITION

NE 1/4 NW 1/4 NE 1/4 of SEC 31 T4N R5E 10 ACRES

This notice is placed at Discovery on post No. 1; posts are placed at each corner, and the name of this lode, and date of location, are placed on all posts.

Located the 30th day of MARCH, 1994

FILED FOR RECORD
SKAMANIA CO. WASH
BY Steve Anliker

APR 4 11 03 AM '94

GARY M. OLSON
AUDITOR

Steve Anliker
Michelle Boucher
Mark Waller

WITNESSES:

Locators.

STATE OF WASHINGTON

BOOK 142 PAGE 329

County of SKAMANIA

ss.

(Individual Acknowledgment)

I, Steve Fisher, do solemnly swear that I am a citizen of the United States of America (or have declared my intention to become such) and that I am acquainted with the mining ground described in the notice of location, and herein called the WICKER MONKEY Placer Mining Claim; that the ground and claim herein described, or any part thereof, has not, to the best of my knowledge and belief, been located according to the laws of the United States and this State, or if so located, that the same has been abandoned or forfeited by reason of failure of such former locators to comply in respect thereto with the requirements of said laws; and that I have performed the equivalent of at least \$100.00 in labor on such claim and have complied with all applicable laws of this State pertaining to this claim.

Subscribed and sworn to before me this

4th

day of

April

19

94

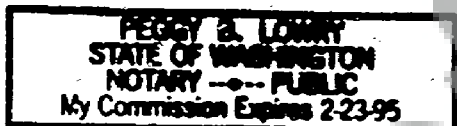

Peggy B. Lowry
Notary Public in and for the State of Washington
residing at Carson in said County.



BOOK 142 PAGE 330

Signature of Claimant Steve Antikoff, Michael Boudry, and Wallace date MARCH 30, 94

MAP of Mining Claim(s)

Township 4N Range 5E Section 31 State of WASHINGTON

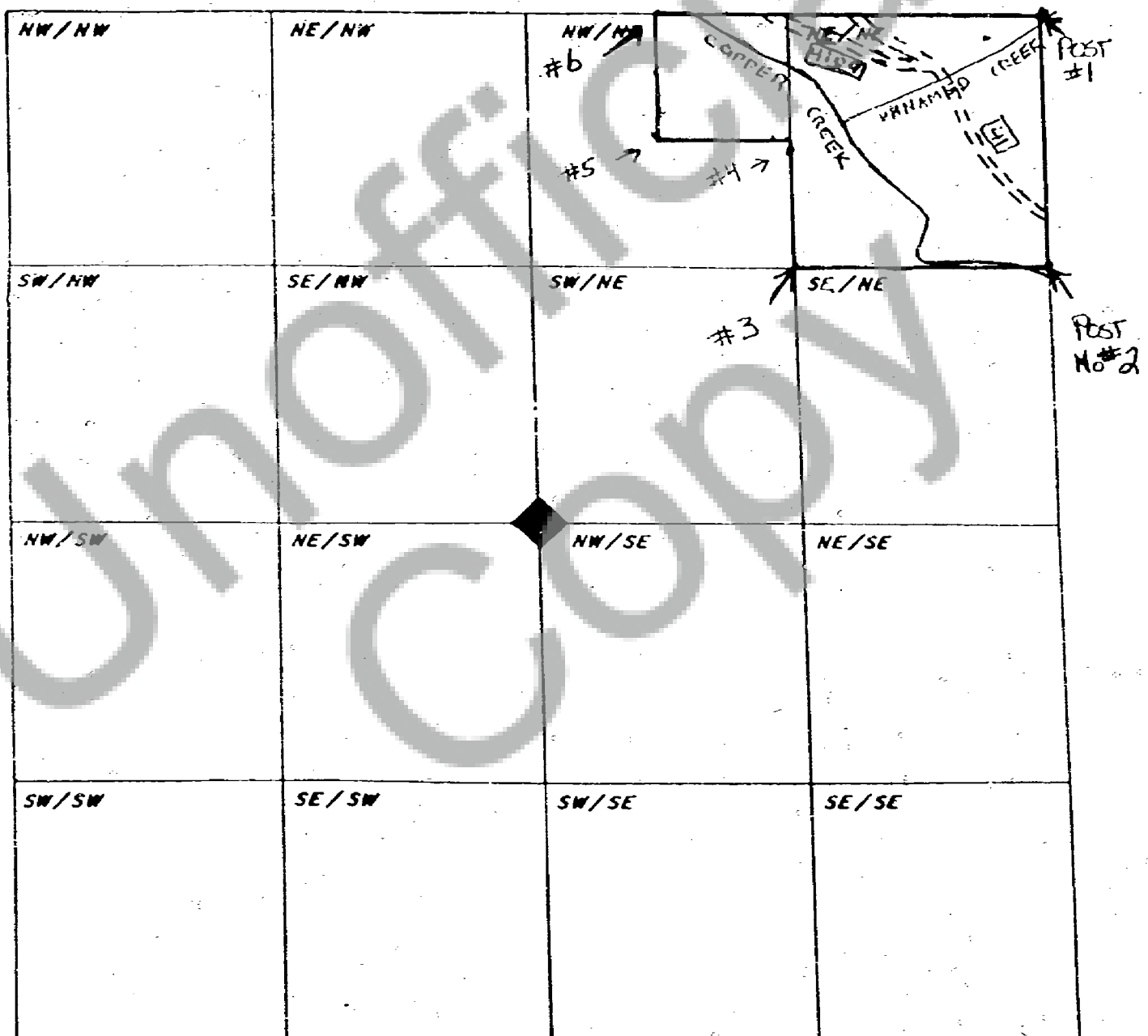

When drawing your claim(s) use an ordinary ruler. 1/8th of an inch would be 100 feet so a full size lode (600' x 1500') would be 3/4" by 1 7/8". A full size placer (1320' x 660') would be 1 5/8" by 13/16".

OWRY K310
EXP. 12/31/94
SITE